

OKLAHOMA

Water Resources Board

May 21, 2026

Viridis Farms, LLC
Attn: Diane Denison
1725 NW 22nd Street
Oklahoma City, OK 73106

RE: Temporary Groundwater Application No. 2026-504, Viridis Farms, LLC, Blaine County

Dear Ms. Denison:

Your application to use groundwater has been reviewed by Board staff. In order to obtain a permit, you must provide notice of the essential facts about your intended use by newspaper publication and by notifying certain neighbors.

In accordance with Section 309 of Title 75 and Section 1020.8 of Title 82 of the Oklahoma Statutes, and Section 785:30-3-4 of the Oklahoma Administrative Code (OAC), we have enclosed a Notice of Application to be published at your expense in a newspaper that is qualified to publish legal notices in Blaine County. The notice must be published once a week for the two consecutive weeks beginning on June 14, 2026 and June 21, 2026. Please send us, or have the publisher forward to us, the certified proofs of publication by July 13, 2026. Because the Board is not responsible for the accuracy of the information contained in the notice, please review the enclosed notice carefully and contact the Board if you note any errors or have any questions.

In addition to giving notice by publication of your application to withdraw groundwater, OAC Section 785:30-3-4(a) requires that you notify by certified mail (return receipt requested) all surface estate owners of lands located within 1,320 feet of the outside boundary of each ten-acre tract regarding wells subject to your application. Please notify these landowners on or before the first day of publication. We have enclosed extra copies of the notice for this purpose. You may make additional copies if you need more than we have provided. Also enclosed is an affidavit certifying you have notified all of these surface estate owners. The affidavit must be signed, notarized, and returned to the Board, along with all green cards, by or before July 13, 2026.

Any protests to your application must be filed with the Board by July 20, 2026. If a protest is filed, a hearing may be scheduled and you will be notified.

If you have any questions concerning this matter, please contact Sharon Robinson at the address below or call (405) 530-8800.

Sincerely,

Chris Noel, Division Chief
Water Rights Administration Division

AFFIDAVIT OF NOTIFICATION

I hereby certify that I, Diane Denison, on behalf of Viridis Farms, LLC, have notified all surface estate owners of lands located within 1,320 feet of the outside boundary of each ten acre tract of the wells subject of application number 2026-504, of their intention to use groundwater by forwarding the notice of application by U.S. Mail, certified mail return receipt requested, on _____ (date mailed) to the following:

(List of names and addresses should correspond to those listed on the Ownership Plat attached to the application. Please attach separate page if more space is needed. PLEASE ATTACH ALL GREEN CARDS TO AFFIDAVIT, along with a copy of the notice.)

NAME

ADDRESS

_____	_____
_____	_____
_____	_____
_____	_____
_____	_____
_____	_____
_____	_____
_____	_____
_____	_____
_____	_____

Applicant's Signature

Subscribed and sworn to before me this
_____ day of _____, 20_____

Notary Public Signature

[seal]

My Commission Expires:

NOTE TO PUBLISHER: To be published in ***Blaine County*** once during the week of June 14, 2026 but no later than June 20, 2026, and once during the week of June 21, 2026 but no later than June 27, 2026, AT APPLICANT'S EXPENSE. (PUBLISHER NEEDS TO FURNISH THE OKLAHOMA WATER RESOURCES BOARD A CERTIFIED PROOF OF PUBLICATION ON OR BEFORE July 13, 2026.)

NOTICE OF APPLICATION TO USE GROUNDWATER

Viridis Farms, LLC c/o Diane Denison of 1725 NW 22nd Street, Oklahoma City, OK 73106 has filed an application, #2026-504, with the Oklahoma Water Resources Board (Board) for a permit to use 40 acre-feet of groundwater per year. The groundwater is proposed to be used for irrigation (medical marijuana) and taken from 280 acres in the S2 of Section 13, T15N, R13WIM, Blaine County. The water is to be withdrawn from four (4) wells located as follows: one (1) well each in the SW SW SW, NW SE SW, SW SE SW, and NW NE SE of Section 13, T15N, R13WIM, Blaine County, and use the groundwater in Blaine County, Oklahoma, as more specifically described in the application, viewable at oklahoma.gov/owrb. Wells and dedicated lands are located over the Rush Springs Sandstone groundwater basin. Use of groundwater is governed by Sections 1020.1 and following of Title 82 of the Oklahoma Statutes and rules of the Board, Oklahoma Administrative Code (OAC), Title 785, Chapters 4 & 30.

Protests to the application must be in writing and received by the Board at the address listed below and by the applicant at the address listed above no later than July 20, 2026, and contain the following: (1) name, address, and telephone number of the interested person; (2) the particular application number to which the protest relates; (3) specific information to show how approval of the application proposed may directly and adversely affect legally protected interests of the person filing the protest; and (4) a statement of the relief sought by the interested person. A person who sends a letter containing only a general objection or comment will not be deemed to be a party, but the letter will be made part of the permanent record.

If a protest that meets the requirements listed in the paragraph above is filed with both the applicant and Board, a hearing on this application will be scheduled and the applicant and protestant(s) will be advised of the hearing date. Protestants or their representatives must appear at the hearing and present the protest to be considered. Hearings are governed by Section 309 of Title 75 and Section 1020.8 of Title 82 of the Oklahoma Statutes, and the rules of Board, OAC Title 785, chapters 4 and 30. If you have any questions, please contact Sharon Robinson at (405) 530-8800. Board mailing address: Oklahoma Water Resources Board, Water Rights Administration Division, 3800 N. Classen Blvd., Oklahoma City, OK 73118-2881. Board fax number: (405) 530-8900.

NOTICE PROVIDED VIA CERTIFIED MAIL

NOTICE OF APPLICATION TO USE GROUNDWATER

Viridis Farms, LLC c/o Diane Denison of 1725 NW 22nd Street, Oklahoma City, OK 73106 has filed an application, #2026-504, with the Oklahoma Water Resources Board (Board) for a permit to use 40 acre-feet of groundwater per year. The groundwater is proposed to be used for irrigation (medical marijuana) and taken from 280 acres in the S2 of Section 13, T15N, R13WIM, Blaine County. The water is to be withdrawn from four (4) wells located as follows: one (1) well each in the SW SW SW, NW SE SW, SW SE SW, and NW NE SE of Section 13, T15N, R13WIM, Blaine County, and use the groundwater in Blaine County, Oklahoma, as more specifically described in the application, viewable at oklahoma.gov/owrb. Wells and dedicated lands are located over the Rush Springs Sandstone groundwater basin. Use of groundwater is governed by Sections 1020.1 and following of Title 82 of the Oklahoma Statutes and rules of the Board, Oklahoma Administrative Code (OAC), Title 785, Chapters 4 & 30.

Protests to the application must be in writing and received by the Board at the address listed below and by the applicant at the address listed above no later than July 20, 2026, and contain the following: (1) name, address, and telephone number of the interested person; (2) the particular application number to which the protest relates; (3) specific information to show how approval of the application proposed may directly and adversely affect legally protected interests of the person filing the protest; and (4) a statement of the relief sought by the interested person. A person who sends a letter containing only a general objection or comment will not be deemed to be a party, but the letter will be made part of the permanent record.

If a protest that meets the requirements listed in the paragraph above is filed with both the applicant and Board, a hearing on this application will be scheduled and the applicant and protestant(s) will be advised of the hearing date. Protestants or their representatives must appear at the hearing and present the protest to be considered. Hearings are governed by Section 309 of Title 75 and Section 1020.8 of Title 82 of the Oklahoma Statutes, and the rules of Board, OAC Title 785, chapters 4 and 30. If you have any questions, please contact Sharon Robinson at (405) 530-8800. Board mailing address: Oklahoma Water Resources Board, Water Rights Administration Division, 3800 N. Classen Blvd., Oklahoma City, OK 73118-2881. Board fax number: (405) 530-8900.

**LONG-TERM APPLICATION
FOR A PERMIT
TO USE GROUNDWATER**

Chk #
1117
\$500

RECEIVED

JAN 13 2026

Oklahoma Water Resources Board

OKLAHOMA WATER RESOURCES BOARD
WATER RIGHTS ADMINISTRATION DIVISION
3800 North Classen Blvd., Oklahoma City, OK 73118
Phone: (405) 530-8800 Fax: (405) 530-8900
Website: www.owrb.ok.gov (see website for FAQs)

APPLICATION FILING FEE

*Application review will not begin until the proper filing fee is received.
Double the filing fee if water is used before application approval.*

Amount of Water Requested	Filing Fee**
1 – 320 acre-feet.....	\$500.00
321 – 640 acre-feet.....	\$700.00
641 – 1,500 acre-feet.....	\$900.00
Over 1,500 acre-feet.....	\$900.00*

*Plus \$250.00 for each increment of 500 acre-feet above 1,500 acre-feet requested (Maximum Fee \$4,000.00).

**Plus \$250.00 if the application overlies a sensitive sole-source groundwater basin. Applications for the purpose of enhanced recovery of oil and gas shall have a flat filing fee of \$4,500.00. If the requested amount of water is fractional, round up to the next whole number for the purposes of determining the filing fee.

OFFICE USE ONLY

Application No. 2026-504
Type of Permit Temporary
Groundwater Basin Rush Springs
Equal Proportionate Share _____

1. NAME & ADDRESS (Print the applicant name exactly as listed on the ownership documentation and fill in the contact information.)

Applicant Name Viridis Farms LLC Phone (405) 538 - 9054
Mailing Address 85612 N 250 Rd City Fay State OK Zip 73646
Email rosslohrmann@yahoo.com Fax () -

Contact Name (during application review) Diane Denison Phone (918) 520 - 4259
Mailing Address 1725 NW 22nd St City Oklahoma City State OK Zip 73106
Email diane@liftedlogix.com Fax () -

If correspondence needs to be sent during application review, it should be sent as: Postal Mail Email Fax

Contact Name (after permit approval) Ross Lohrmann Phone (405) 538 - 9054
Mailing Address 601 N clarence Nash Blvd City Watonga State OK Zip 73772
Email rosslohrmann@yahoo.com Fax () -

2. QUANTITY OF WATER & PURPOSE (List the purposes for which the water will be used and the total number of acre-feet per year. Note: One acre-foot of water will cover one acre of land one foot deep and is equal to 325,851 gallons. Common purposes include irrigation, agriculture (greenhouses, animal farms), oil & gas, public water supply, commercial, industrial, power generation, and recreation, fish, & wildlife.)

Groundwater requested: 40 acre-feet per year. Water used in Blaine county.

Purposes: Irrigation

For Growing Crops: Proposed crops: Medical Marijuana

Approximate area of crops irrigated: 80 acres. If the applicant will use water (or sell water to an end user) to grow marijuana or hemp attach a copy of all associated user's OMMA or ODAFF licenses.

RECEIVED

JAN 13 2026

Oklahoma Water Resources Board

3. DEDICATED LAND List the legal description of all the land to be dedicated. Do not use city lot and block numbers or metes and bounds. If additional space is needed, list on a separate sheet of paper. An explanation of legal descriptions can be found on the OWRB website FAQs page. Dedicated land must be drawn on the application plat map.

total acres owned; 280 total acres leased; total acres platted (municipal only)
280 acres in 1/4 of 1/4 of S2 1/4 of Section 13 Twp. 15 N S Rng. 13 WIM in Blaine County

4. WELL INFORMATION List the number and legal description for all wells (either existing or proposed) that are requested to be permitted. Existing wells require a ten acre tract legal description. Depth and pumping rate are required for all existing wells and a range of values (e.g. 400 - 500 feet) can be provided for multiple existing wells. Estimated depth and pumping rate may be required for proposed wells in areas with multiple groundwater basins. Provide an answer to the well spacing exception question. If additional space is needed, list on a separate sheet of paper. An explanation of legal descriptions can be found on the OWRB website FAQs page. All wells must be drawn on the application plat map.

Water is to be withdrawn from 4 total well(s) located as follows:

1 wells in SW 1/4 of SW 1/4 of SW 1/4 of Section 13 Twp. 15 N S Rng. 13 WIM in Blaine County Existing Yes Well? No
1 wells in NW 1/4 of SE 1/4 of SW 1/4 of Section 13 Twp. 15 N S Rng. 13 WIM in Blaine County Existing Yes Well? No
1 wells in SW 1/4 of SE 1/4 of SW 1/4 of Section 13 Twp. 15 N S Rng. 13 WIM in Blaine County Existing Yes Well? No
See next page

Depth: 50 feet; Pumping Rate: 20 gallons per minute

Requesting a well spacing exception? Yes No Blank responses will not be accepted. If yes, please provide an attached explanation to show how compliance with well spacing would be inequitable or unreasonable. Examples can be found in OAC 785:30-3-6(b)(1). A well spacing exception may be required based on application review.

5. MUNICIPALITIES Only municipalities are required to complete this section. All other applicants can skip this section. Answer the questions and provide copies of the requested maps.

Will platted land be dedicated within the municipal boundary? Yes No
If yes, will the municipality make water available to those platted lands? Yes No
If yes, provide attached map(s) that show the following: service area, water lines, and platted lands.

OFFICE USE ONLY
SIC Codes
01 0101

RECEIVED

JAN 13 2026

Oklahoma Water Resources Board

3. DEDICATED LAND List the legal description of all the land to be dedicated. Do not use city lot and block numbers or metes and bounds. If additional space is needed, list on a separate sheet of paper. An explanation of legal descriptions can be found on the OWRB website FAQs page. Dedicated land must be drawn on the application plat map.

_____ total acres owned; _____ total acres leased; _____ total acres platted (municipal only)
_____ acres in _____ 1/4 of _____ 1/4 of _____ 1/4 of Section _____ Twp. _____ ON _____ O EIM
_____ OS Rng. _____ OWIM in _____
_____ O ECM _____ County

4. WELL INFORMATION List the number and legal description for all wells (either existing or proposed) that are requested to be permitted. Existing wells require a ten acre tract legal description. Depth and pumping rate are required for all existing wells and a range of values (e.g. 400 - 500 feet) can be provided for multiple existing wells. Estimated depth and pumping rate may be required for proposed wells in areas with multiple groundwater basins. Provide an answer to the well spacing exception question. If additional space is needed, list on a separate sheet of paper. An explanation of legal descriptions can be found on the OWRB website FAQs page. All wells must be drawn on the application plat map.

Water is to be withdrawn from _____ total well(s) located as follows:

1 wells in NW 1/4 of NE 1/4 of SE 1/4 of Section 13 Twp. 15 ON O EIM
OS Rng. 13 OWIM in Blaine Existing Yes
O ECM County Well? No
_____ wells in _____ 1/4 of _____ 1/4 of _____ 1/4 of Section _____ Twp. _____ ON _____ O EIM
_____ OS Rng. _____ OWIM in _____ Existing O Yes
_____ O ECM _____ County Well? O No
_____ wells in _____ 1/4 of _____ 1/4 of _____ 1/4 of Section _____ Twp. _____ ON _____ O EIM
_____ OS Rng. _____ OWIM in _____ Existing O Yes
_____ O ECM _____ County Well? O No

Depth: 50 feet; Pumping Rate: 20 gallons per minute

Requesting a well spacing exception? O Yes O No Blank responses will not be accepted. If yes, please provide an attached explanation to show how compliance with well spacing would be inequitable or unreasonable. Examples can be found in OAC 785:30-3-6(b)(1). A well spacing exception may be required based on application review.

5. MUNICIPALITIES Only municipalities are required to complete this section. All other applicants can skip this section. Answer the questions and provide copies of the requested maps.

Will platted land be dedicated within the municipal boundary? O Yes O No
If yes, will the municipality make water available to those platted lands? O Yes O No

If yes, provide attached map(s) that show the following: service area, water lines, and platted lands.

OFFICE USE ONLY
SIC Codes
[Grid for SIC Codes]

6. PLAT MAP Follow the instructions on the preceding page unless otherwise directed by the Board. Drawings must match the legal description of dedicated land and wells described in Section 3 and 4 of the application. More than one plat map may be required.

RECEIVED

JAN 13 2026

Application No. Viridis Farms LLC

Oklahoma Water Resources Board

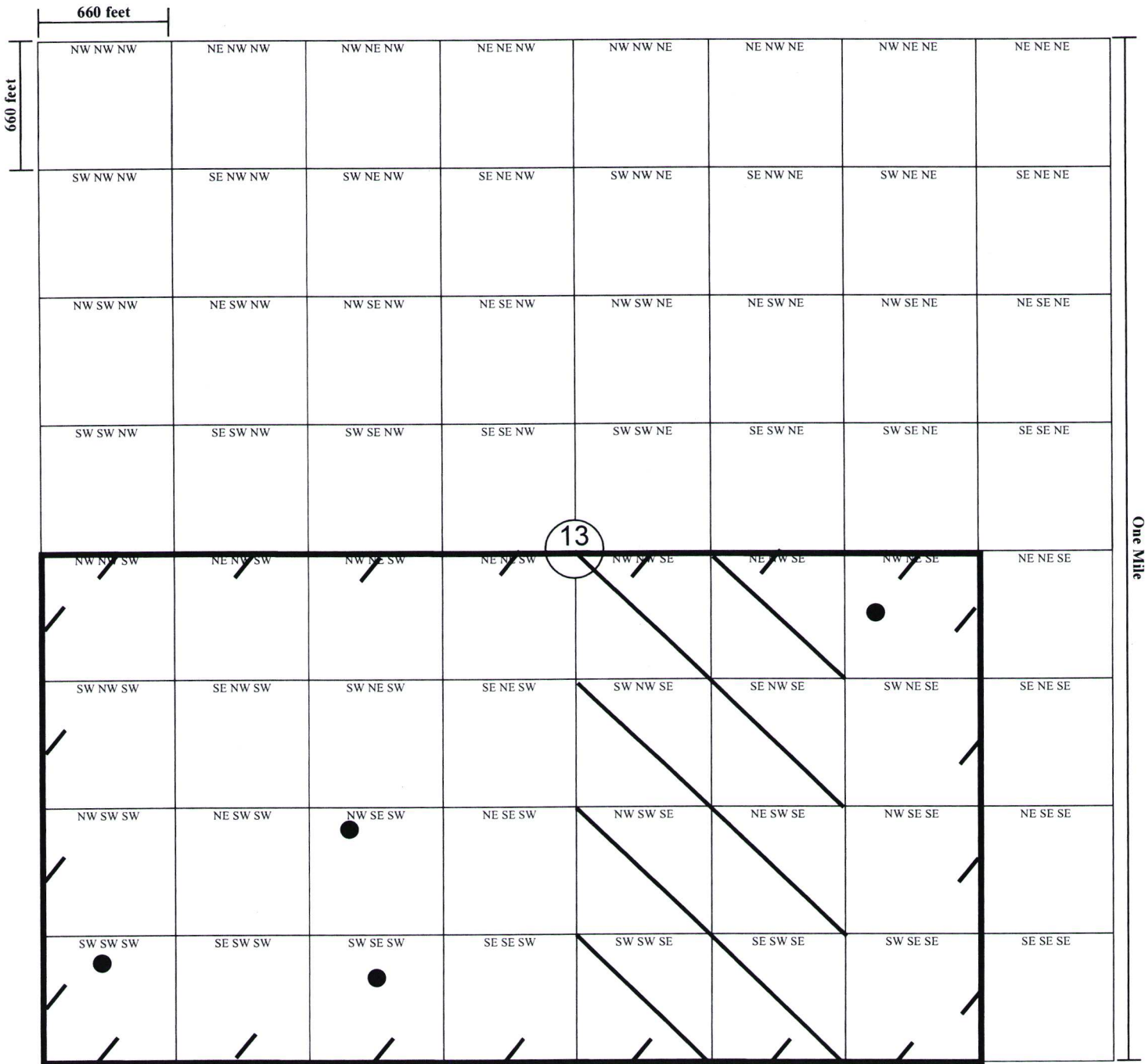

13-15N-13WIM

Blaine

Section - Township - Range

County



Land Dedicated



Area of Use



Proposed Well Location Area

● Existing Wells to be Permitted

○ Existing Wells Owned by Others (i.e. domestic, stock, permitted, etc.)



8. SIGNATURES

Upon my oath or affirmation, I swear or affirm (1) that all information submitted to the Oklahoma Water Resources Board in connection with this application is true and accurate to the best of my knowledge; and (2) that I or the person or entity I represent will comply with all applicable laws and regulations of the State of Oklahoma or its agencies, and any lawful conditions imposed by the Oklahoma Water Resources Board, which apply or pertain to the use of fresh groundwater.

RECEIVED

JAN 13 2026

Oklahoma Water Resources Board



SIGNATURE OF APPLICANT

Ross Lohmann

PRINT NAME

Owner

TITLE (IF APPLICABLE)

OKLAHOMA BAR ASSOCIATION NUMBER (IF APPLICABLE)

NOTARY

STATE OF Oklahoma)
COUNTY OF Oklahoma) ss.

The foregoing instrument was acknowledged before me this 13 day of January, 20 26.

Notary Public Signature

My commission expires: 12/30/29

(SEAL)



9. APPLICATION SUBMISSION AND PROCESSING

The submitted application packet must include the following:

- a. The original completed application, typed or printed in ink, signed and notarized (*All markings must be legible.*);
- b. The appropriate filing fee (*Application review will not begin until the proper filing fees are received. If water is used before application approval, double the filing fee will be required. Filing fees will not be refunded unless an overpayment was made by the applicant.*);
- c. Copies of warranty deeds, leases, and/or letters of consent as required (*Tax documents are not accepted. Social security numbers are not required. If any documentation contains social security numbers, please obscure them before submittal.*).
- d. Other documentation may be requested as needed to complete the application review.

Please note: Any incomplete or unresponsive answers may cause a delay in the processing of your application.

In addition, Oklahoma Administrative Code (OAC) 785:30-1-4(d) states: "If the application is defective to as to form, the Board shall advise the applicant of the corrections, amendments, or changes required and sixty (60) days shall be allowed for the refilling thereof. If the application is not corrected, amended, or changed within the time required, the Board may inactivate the application. Furthermore, OAC 785:30-3-3(b), states: "If an applicant does not correct an application or publish notice as instructed by the Board, and no further proceedings are initiated by the applicant for six months or more after last contact with the Board, the application shall be deemed withdrawn. The Board shall provide notice to the applicant that the application has been deemed withdrawn.

From: Diane Denison <diane@liftedlogix.com>
Sent: Tuesday, January 20, 2026 9:50 AM
To: Madison Hanna
Cc: Philip Wong; rosslohrmann@yahoo.com
Subject: [EXTERNAL] Long-Term Application - Groundwater Permit - Viridis Farms LLC
Attachments: Executed - Long Term Use Permit Application_Viridis Farms LLC.pdf; Site Map - Well Location.jpeg

Follow Up Flag: Follow up
Flag Status: Flagged

Hello Madison,

Please find attached the completed application for Viridis Farms LLC, which includes the surface estate owner information and an updated map.

We have also finalized the well log submissions for all four wells. Confirmation screenshots are included below.

Please note that the groundwater lease has been submitted to the Blaine County Clerk's office. I will forward a stamped copy once it is returned.

Let me know if you have any questions or if further action is required.

Best regards,

Diane Denison

918-520-4259 Telephone
diane@liftedlogix.com

All electronic mail messages and attachments sent to or from the sender may contain confidential information belonging to the sender, which may be protected by applicable law. This information is intended only for the use of the individual or entity addressed in the electronic communication. If you are not the intended recipient, you are hereby notified that any disclosure, copying, distribution (electronic or otherwise), forwarding or the taking of any action in reliance on the contents of this information is strictly prohibited. If you have received any electronic transmission in error, please immediately notify the sender by telephone or by e-mail to arrange for return of the electronic email, attachments, or documents.

Please be advised that the matters set forth in this message are being provided for informational purposes only. Nothing in this message should be construed as legal advice. The recipient should not rely upon anything in the message in lieu of obtaining competent advice from a licensed attorney, nor should the recipient rely upon any of the information contained in this message without first seeking competent counsel.