



OKLAHOMA

Water Resources Board

June 1, 2026

Bailey Land & Mineral, LLC
Attn: Lonnie Bailey/Erin Jones
159278 E US 64 Hwy
Gate, OK 73844

RE: Regular Groundwater Application No. 2025-655, Bailey Land & Mineral, LLC, Beaver County

Dear Mr. Bailey and Ms. Jones:

Your application to use groundwater has been reviewed by Board staff. In order to obtain a permit, you must provide notice of the essential facts about your intended use by newspaper publication and by notifying certain neighbors.

In accordance with Section 309 of Title 75 and Section 1020.8 of Title 82 of the Oklahoma Statutes, and Section 785:30-3-4 of the Oklahoma Administrative Code (OAC), we have enclosed a Notice of Application to be published at your expense in a newspaper that is qualified to publish legal notices in Beaver County. The notice must be published once a week for the two consecutive weeks beginning on June 14, 2026 and June 21, 2026. Please send us, or have the publisher forward to us, the certified proofs of publication by July 13, 2026. Because the Board is not responsible for the accuracy of the information contained in the notice, please review the enclosed notice carefully and contact the Board if you note any errors or have any questions.

In addition to giving notice by publication of your application to withdraw groundwater, OAC Section 785:30-3-4(a) requires that you notify by certified mail (return receipt requested) all surface estate owners of lands located within 1,320 feet of the outside boundary of each ten-acre tract regarding wells subject to your application. Please notify these landowners on or before the first day of publication. We have enclosed extra copies of the notice for this purpose. You may make additional copies if you need more than we have provided. Also enclosed is an affidavit certifying you have notified all of these surface estate owners. The affidavit must be signed, notarized, and returned to the Board, along with all green cards, by or before July 13, 2026.

Any protests to your application must be filed with the Board by July 20, 2026. If a protest is filed, a hearing may be scheduled and you will be notified.

If you have any questions concerning this matter, please contact Sharon Robinson at the address below or call (405) 530-8800.

Sincerely,



Chris Neel, Division Chief
Water Rights Administration Division

AFFIDAVIT OF NOTIFICATION

I hereby certify that I, Lonnie Bailey and Erin Jones, on behalf of Bailey Land and Mineral, LLC, have notified all surface estate owners of lands located within 1,320 feet of the outside boundary of each ten acre tract of the wells subject of application number 2025-655, of our intention to use groundwater by forwarding the notice of application by U.S. Mail, certified mail return receipt requested, on _____ (date mailed) to the following:

(List of names and addresses should correspond to those listed on the Ownership Plat attached to the application. Please attach separate page if more space is needed. PLEASE ATTACH ALL GREEN CARDS TO AFFIDAVIT, along with a copy of the notice.)

NAME

ADDRESS

_____	_____
_____	_____
_____	_____
_____	_____
_____	_____
_____	_____
_____	_____
_____	_____
_____	_____
_____	_____

Applicant's Signature

Subscribed and sworn to before me this _____ day of _____, 20_____

Notary Public Signature

[seal]

My Commission Expires:

NOTE TO PUBLISHER: To be published in *Beaver County* once during the week of June 14, 2026 but no later than June 20, 2026, and once during the week of June 21, 2026 but no later than June 27, 2026, AT APPLICANT'S EXPENSE. (PUBLISHER NEEDS TO FURNISH THE OKLAHOMA WATER RESOURCES BOARD A CERTIFIED PROOF OF PUBLICATION ON OR BEFORE July 13, 2026.)

NOTICE OF APPLICATION TO USE GROUNDWATER

Bailey Land & Mineral, LLC c/o Lonnie Bailey and Erin Jones of 159278 E US 64 Hwy, Gate, OK 73844 has filed an application, #2025-655, with the Oklahoma Water Resources Board (Board) for a permit to use 240 acre-feet of groundwater per year. The groundwater is proposed to be used for irrigation (wheat, grass, and triticale) and agriculture (cattle) and taken from 120 acres located as follows: 40 acres in the SE SW and 80 acres in the S2 SE of Section 4, T4N, R27ECM, Beaver County. The water is to be withdrawn from one (1) well in the SW SW SE of Section 4, T4N, R27ECM, Beaver County, and use the groundwater in Beaver County, Oklahoma, as more specifically described in the application, viewable at oklahoma.gov/owrb. Wells and dedicated lands are located over the Ogallala Panhandle groundwater basin. Board rules require that the well be located a distance of at least 1,320 feet from existing wells or proposed well locations on lands of another unless a well location exception is granted. Use of groundwater is governed by Sections 1020.1 and following Title 82 of the Oklahoma Statutes and rules of the Board, Oklahoma Administrative Code, Title 785, Chapters 4 and 30.

Protests to the application must be in writing and received by the Board at the address listed below and by the applicant at the address listed above no later than July 20, 2026, and contain the following: (1) name, address, and telephone number of the interested person; (2) the particular application number to which the protest relates; (3) specific information to show how approval of the application proposed may directly and adversely affect legally protected interests of the person filing the protest; and (4) a statement of the relief sought by the interested person. A person who sends a letter containing only a general objection or comment will not be deemed to be a party, but the letter will be made part of the permanent record.

If a protest that meets the requirements listed in the paragraph above is filed with both the applicant and Board, a hearing on this application will be scheduled and the applicant and protestant(s) will be advised of the hearing date. Protestants or their representatives must appear at the hearing and present the protest to be considered. Hearings are governed by Section 309 of Title 75 and Section 1020.8 of Title 82 of the Oklahoma Statutes, and the rules of Board, OAC Title 785, chapters 4 and 30. If you have any questions, please contact Sharon Robinson at (405) 530-8800. Board mailing address: Oklahoma Water Resources Board, Water Rights Administration Division, 3800 N. Classen Blvd., Oklahoma City, OK 73118-2881. Board fax number: (405) 530-8900.

NOTICE PROVIDED VIA CERTIFIED MAIL

NOTICE OF APPLICATION TO USE GROUNDWATER

Bailey Land & Mineral, LLC c/o Lonnie Bailey and Erin Jones of 159278 E US 64 Hwy, Gate, OK 73844 has filed an application, #2025-655, with the Oklahoma Water Resources Board (Board) for a permit to use 240 acre-feet of groundwater per year. The groundwater is proposed to be used for irrigation (wheat, grass, and triticale) and agriculture (cattle) and taken from 120 acres located as follows: 40 acres in the SE SW and 80 acres in the S2 SE of Section 4, T4N, R27ECM, Beaver County. The water is to be withdrawn from one (1) well in the SW SW SE of Section 4, T4N, R27ECM, Beaver County, and use the groundwater in Beaver County, Oklahoma, as more specifically described in the application, viewable at oklahoma.gov/owrb. Wells and dedicated lands are located over the Ogallala Panhandle groundwater basin. Board rules require that the well be located a distance of at least 1,320 feet from existing wells or proposed well locations on lands of another unless a well location exception is granted. Use of groundwater is governed by Sections 1020.1 and following Title 82 of the Oklahoma Statutes and rules of the Board, Oklahoma Administrative Code, Title 785, Chapters 4 and 30.

Protests to the application must be in writing and received by the Board at the address listed below and by the applicant at the address listed above no later than July 20, 2026, and contain the following: (1) name, address, and telephone number of the interested person; (2) the particular application number to which the protest relates; (3) specific information to show how approval of the application proposed may directly and adversely affect legally protected interests of the person filing the protest; and (4) a statement of the relief sought by the interested person. A person who sends a letter containing only a general objection or comment will not be deemed to be a party, but the letter will be made part of the permanent record.

If a protest that meets the requirements listed in the paragraph above is filed with both the applicant and Board, a hearing on this application will be scheduled and the applicant and protestant(s) will be advised of the hearing date. Protestants or their representatives must appear at the hearing and present the protest to be considered. Hearings are governed by Section 309 of Title 75 and Section 1020.8 of Title 82 of the Oklahoma Statutes, and the rules of Board, OAC Title 785, chapters 4 and 30. If you have any questions, please contact Sharon Robinson at (405) 530-8800. Board mailing address: Oklahoma Water Resources Board, Water Rights Administration Division, 3800 N. Classen Blvd., Oklahoma City, OK 73118-2881. Board fax number: (405) 530-8900.

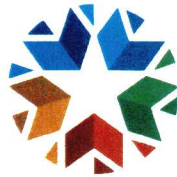

OKLAHOMA

Water Resources Board

March 6, 2026

Bailey Land & Mineral, LLC
Attn: Lonnie Bailey/ Erin Jones
159278 E US 64 Hwy
Gate, OK 73844

RE: Regular Groundwater Application No. 2025-655, Bailey Land & Mineral, LLC, Beaver County

Dear Mr. Bailey and Mrs. Jones:

Your application to use groundwater has been reviewed by Board staff. In order to obtain a permit, you must provide notice of the essential facts about your intended use by newspaper publication and by notifying certain neighbors.

In accordance with Section 309 of Title 75 and Section 1020.8 of Title 82 of the Oklahoma Statutes, and Section 785:30-3-4 of the Oklahoma Administrative Code (OAC), we have enclosed a Notice of Application to be published at your expense in a newspaper that is qualified to publish legal notices in Beaver County. The notice must be published once a week for the two consecutive weeks beginning on March 22, 2026 and March 29, 2026. Please send us, or have the publisher forward to us, the certified proofs of publication by April 20, 2026. Because the Board is not responsible for the accuracy of the information contained in the notice, please review the enclosed notice carefully and contact the Board if you note any errors or have any questions.

In addition to giving notice by publication of your application to withdraw groundwater, OAC Section 785:30-3-4(a) requires that you notify by certified mail (return receipt requested) all surface estate owners of lands located within 1,320 feet of the outside boundary of each ten-acre tract regarding wells subject to your application. Please notify these landowners on or before the first day of publication. We have enclosed extra copies of the notice for this purpose. You may make additional copies if you need more than we have provided. Also enclosed is an affidavit certifying you have notified all of these surface estate owners. The affidavit must be signed, notarized, and returned to the Board, along with all green cards, by or before April 20, 2026.

Any protests to your application must be filed with the Board by April 27, 2026. If a protest is filed, a hearing may be scheduled and you will be notified.

If you have any questions concerning this matter, please contact Sharon Robinson at the address below or call (405) 530-8800.

Sincerely,

For Chris Neel, Division Chief
Water Rights Administration Division

AFFIDAVIT OF NOTIFICATION

I hereby certify that I, Lonnie Bailey and Erin Jones, on behalf of Bailey Land and Mineral, LLC, have notified all surface estate owners of lands located within 1,320 feet of the outside boundary of each ten acre tract of the wells subject of application number 2025-655, of our intention to use groundwater by forwarding the notice of application by U.S. Mail, certified mail return receipt requested, on _____ (date mailed) to the following:

(List of names and addresses should correspond to those listed on the Ownership Plat attached to the application. Please attach separate page if more space is needed. PLEASE ATTACH ALL GREEN CARDS TO AFFIDAVIT, along with a copy of the notice.)

NAME

ADDRESS

_____	_____
_____	_____
_____	_____
_____	_____
_____	_____
_____	_____
_____	_____
_____	_____
_____	_____
_____	_____

Applicant's Signature

Subscribed and sworn to before me this
_____ day of _____, 20_____

Notary Public Signature

[seal]

My Commission Expires:

NOTE TO PUBLISHER: To be published in *Beaver County* once during the week of March 22, 2026 but no later than March 28, 2026, and once during the week of March 29, 2026 but no later than April 4, 2026, AT APPLICANT'S EXPENSE. (PUBLISHER NEEDS TO FURNISH THE OKLAHOMA WATER RESOURCES BOARD A CERTIFIED PROOF OF PUBLICATION ON OR BEFORE April 20, 2026.)

NOTICE OF APPLICATION TO USE GROUNDWATER

Bailey Land & Mineral, LLC c/o Lonnie Bailey and Erin Jones of 159278 E US 64 Hwy, Gate, OK 73844 has filed an application, #2025-655, with the Oklahoma Water Resources Board (Board) for a permit to use 240 acre-feet of groundwater per year. The groundwater is proposed to be used for irrigation (wheat, grass, and triticale) and agriculture (cattle) and taken from 120 acres located as follows: 40 acres in the SE SW and 80 acres in the S2 SE of Section 4, T4N, R27ECM, Beaver County. The water is to be withdrawn from one (1) well in the SW SW SE of Section 4, T4N, R27ECM, Beaver County, and use the groundwater in Beaver County, Oklahoma, as more specifically described in the application, viewable at oklahoma.gov/owrb. Wells and dedicated lands are located over the Ogallala Panhandle groundwater basin. Board rules require that the well be located a distance of at least 1,320 feet from existing wells or proposed well locations on lands of another unless a well location exception is granted. Use of groundwater is governed by Sections 1020.1 and following Title 82 of the Oklahoma Statutes and rules of the Board, Oklahoma Administrative Code, Title 785, Chapters 4 and 30.

Protests to the application must be in writing and received by the Board at the address listed below and by the applicant at the address listed above no later than April 27, 2026, and contain the following: (1) name, address, and telephone number of the interested person; (2) the particular application number to which the protest relates; (3) specific information to show how approval of the application proposed may directly and adversely affect legally protected interests of the person filing the protest; and (4) a statement of the relief sought by the interested person. A person who sends a letter containing only a general objection or comment will not be deemed to be a party, but the letter will be made part of the permanent record.

If a protest that meets the requirements listed in the paragraph above is filed with both the applicant and Board, a hearing on this application will be scheduled and the applicant and protestant(s) will be advised of the hearing date. Protestants or their representatives must appear at the hearing and present the protest to be considered. Hearings are governed by Section 309 of Title 75 and Section 1020.8 of Title 82 of the Oklahoma Statutes, and the rules of Board, OAC Title 785, chapters 4 and 30. If you have any questions, please contact Sharon Robinson at (405) 530-8800. Board mailing address: Oklahoma Water Resources Board, Water Rights Administration Division, 3800 N. Classen Blvd., Oklahoma City, OK 73118-2881. Board fax number: (405) 530-8900.

NOTICE PROVIDED VIA CERTIFIED MAIL

NOTICE OF APPLICATION TO USE GROUNDWATER

Bailey Land & Mineral, LLC c/o Lonnie Bailey and Erin Jones of 159278 E US 64 Hwy, Gate, OK 73844 has filed an application, #2025-655, with the Oklahoma Water Resources Board (Board) for a permit to use 240 acre-feet of groundwater per year. The groundwater is proposed to be used for irrigation (wheat, grass, and triticale) and agriculture (cattle) and taken from 120 acres located as follows: 40 acres in the SE SW and 80 acres in the S2 SE of Section 4, T4N, R27ECM, Beaver County. The water is to be withdrawn from one (1) well in the SW SW SE of Section 4, T4N, R27ECM, Beaver County, and use the groundwater in Beaver County, Oklahoma, as more specifically described in the application, viewable at oklahoma.gov/owrb. Wells and dedicated lands are located over the Ogallala Panhandle groundwater basin. Board rules require that the well be located a distance of at least 1,320 feet from existing wells or proposed well locations on lands of another unless a well location exception is granted. Use of groundwater is governed by Sections 1020.1 and following Title 82 of the Oklahoma Statutes and rules of the Board, Oklahoma Administrative Code, Title 785, Chapters 4 and 30.

Protests to the application must be in writing and received by the Board at the address listed below and by the applicant at the address listed above no later than April 27, 2026, and contain the following: (1) name, address, and telephone number of the interested person; (2) the particular application number to which the protest relates; (3) specific information to show how approval of the application proposed may directly and adversely affect legally protected interests of the person filing the protest; and (4) a statement of the relief sought by the interested person. A person who sends a letter containing only a general objection or comment will not be deemed to be a party, but the letter will be made part of the permanent record.

If a protest that meets the requirements listed in the paragraph above is filed with both the applicant and Board, a hearing on this application will be scheduled and the applicant and protestant(s) will be advised of the hearing date. Protestants or their representatives must appear at the hearing and present the protest to be considered. Hearings are governed by Section 309 of Title 75 and Section 1020.8 of Title 82 of the Oklahoma Statutes, and the rules of Board, OAC Title 785, chapters 4 and 30. If you have any questions, please contact Sharon Robinson at (405) 530-8800. Board mailing address: Oklahoma Water Resources Board, Water Rights Administration Division, 3800 N. Classen Blvd., Oklahoma City, OK 73118-2881. Board fax number: (405) 530-8900.

APPLICATION FOR A LONG-TERM GROUNDWATER PERMIT

RECEIVED

December 22, 2025

OKLAHOMA WATER RESOURCES BOARD

paid \$500

priority date 9/18/25

OKLAHOMA WATER RESOURCES BOARD
WATER RIGHTS ADMINISTRATION DIVISION
3800 North Classen Blvd., Oklahoma City, OK 73118
Phone: (405) 530-8800 Fax: (405) 530-8900
Website: <https://oklahoma.gov/owrb.html>
(See website for FAQs)

FILING FEE

Application review will not begin until the proper filing fee is received. Double the filing fee if water is used before application approval. If the requested amount of water is fractional, round up to the next whole number for the purposes of determining the filing fee.

Amount of Water Requested	Filing Fee**
1 - 320 acre-feet	\$500.00
321 - 640 acre-feet	\$700.00
641 - 1,500 acre-feet	\$900.00
Over 1,500 acre-feet	\$900.00*

*Plus \$250.00 for each increment of 500 acre-feet above 1,500 acre-feet requested (Maximum Fee \$4,000.00)
**Plus \$250.00 if the application overlies a sensitive sole-source groundwater basin. Applications for the purpose of enhanced recovery of oil and gas shall have a flat filing fee of \$4,500.00

OFFICE USE ONLY

Application No. 2025-655
Permit Type Regular
GW Basin Ogallala Panhandle
Equal Proportionate Share 2

1. NAME & CONTACT INFORMATION

Print the applicant's name to exactly match what is listed on the ownership document. Consultants and legal counsel should provide a cover letter with contact information and state if they will remain the contact after permit approval.

Applicant Name Bailey Land & Mineral, LLC Phone (580) 651 - 1227

Mailing Address 159278 E US 64 Hwy City Gate State OK Zip 73844

Email erinkbailey@hotmail.com Fax () -

Contact Name (if different than applicant) Erin Jones / Lonnie Bailey Phone (580) 651 - 1227

Mailing Address 159278 E US 64 Hwy City Gate State OK Zip 73844

Email erinkbailey@hotmail.com Fax () -

How should correspondence be sent during application review? Check all that apply: Postal Mail Email Fax

2. QUANTITY OF WATER & PURPOSE

Identify how much water will be used and where. Choose at least one purpose (i.e. beneficial use) from the following list: Irrigation, Agriculture, Mining, Public Water Supply, Commercial, Industrial, Power Generation, Recreation, Fish & Wildlife, and Other. A description can be helpful and may be required to complete application review. Answer the questions and provide the requested information for each. Conversion factor: one acre-foot of water will cover one acre of land one foot deep and is equal to 325,851 gallons.

Groundwater requested 240 acre-feet per year. Water used in Beaver county.

Purpose: irrigation, agriculture
(e.g. Agriculture - Poultry Houses or Greenhouse; Mining - Oil & Gas or Rock Quarry; Recreation - Flood a Wetland for Hunting)

Have you already used the water for which you are applying? Yes No If yes, double the filing fee will be required

Will water be sold? Yes No If yes, list the purchaser: _____
(not required for public water suppliers)

Will animals be raised? Yes No If yes, list animal type: cattle
(not required for domestic use of stock water)

Will crops be grown? Yes No If yes, approximate area of watered crops: 120 and,
(use units of acres for fields or square feet for indoor)

List of crops wheat, grass, triticale

RECEIVED

December 22, 2025

OKLAHOMA WATER RESOURCES BOARD

3. DEDICATED LAND List the legal description of all the land to be dedicated. Do not use city lot and block numbers or metes and bounds. If additional space is needed, list on a separate sheet of paper. An explanation of legal descriptions can be found on the OWRB website FAQs page. Dedicated land must be drawn on the application plat map.

120 total acres owned, total acres leased, total acres platted (municipal only)
80 acres in 1/4 of S2 1/4 of SE 1/4 of Section 4 Twp 4 N S Rng 27 EIM WIM in Beaver County ECM
40 acres in 1/4 of SE 1/4 of SW 1/4 of Section 4 Twp 4 N S Rng 27 EIM WIM in Beaver County ECM

4. WELL INFORMATION List the number and legal description for all wells (either existing or proposed) that are requested to be permitted. Existing wells require a ten acre tract legal description. Depth and pumping rate are required for all existing wells and a range of values (e.g. 400 - 500 feet) can be provided for multiple existing wells. Estimated depth and pumping rate may be required for proposed wells in areas with multiple groundwater basins. Provide an answer to the well spacing exception question. If additional space is needed, list on a separate sheet of paper. An explanation of legal descriptions can be found on the OWRB website FAQs page. All wells must be drawn on the application plat map.

Water is to be withdrawn from 1 total well(s) located as follows

1 wells in SW 1/4 of SW 1/4 of SE 1/4 of Section 4 Twp 4 N S Rng 27 EIM WIM in Beaver County Existing Well? Yes No
wells in 1/4 of 1/4 of 1/4 of Section Twp N S Rng EIM WIM in County Existing Well? Yes No
wells in 1/4 of 1/4 of 1/4 of Section Twp N S Rng EIM WIM in County Existing Well? Yes No

Depth feet, Pumping Rate gallons per minute

Requesting a well spacing exception? Yes No Blank responses will not be accepted. If yes, please provide an attached explanation to show how compliance with well spacing would be inequitable or unreasonable. Examples can be found in OAC 785:30-3-6(b)(1). A well spacing exception may be required based on application review.

5. MUNICIPALITIES Only municipalities are required to complete this section. All other applicants can skip this section. Answer the questions and provide copies of the requested maps

Will platted land be dedicated within the municipal boundary? Yes No

If yes, will the municipality make water available to those platted lands? Yes No

If yes, provide attached map(s) that show the following: service area, water lines, and platted lands

OFFICE USE ONLY
SIC Codes
01 0100
08 0212

RECEIVED

December 22, 2025

OKLAHOMA WATER RESOURCES BOARD

6. PLAT MAP Follow the instructions on the preceding page unless otherwise directed by the Board. Drawings must match the legal description of dedicated land and wells described in Section 3 and 4 of the application More than one plat map may be required.

Application No 2025-655

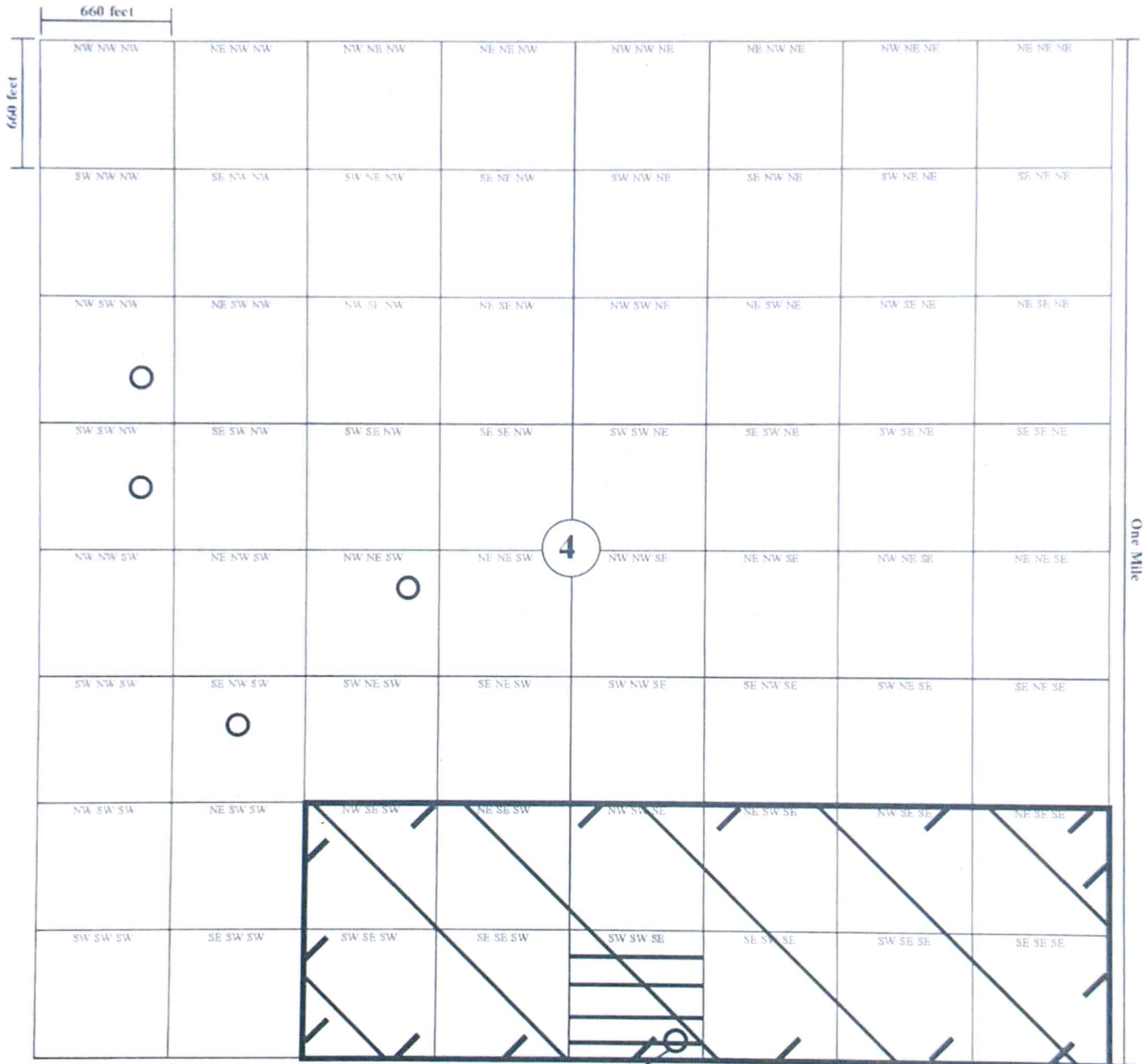

4 - 4N - 27ECM
Section - Township - Range

Beaver
County



Land Dedicated



Area of Use



Proposed Well Location Area

● Existing Wells to be Permitted

○ Existing Wells Owned by Others (i.e. domestic, stock, permitted, etc.)



8. SIGNATURES

Upon my oath or affirmation, I swear or affirm (1) that all information submitted to the Oklahoma Water Resources Board in connection with this application is true and accurate to the best of my knowledge; and (2) that I or the person or entity I represent will comply with all applicable laws and regulations of the State of Oklahoma or its agencies, and any lawful conditions imposed by the Oklahoma Water Resources Board, which apply or pertain to the use of fresh groundwater.

RECEIVED

December 22, 2025

OKLAHOMA WATER RESOURCES BOARD

Lonnie Bailey
SIGNATURE OF APPLICANT

Lonnie Bailey
PRINTED NAME

Manager
TITLE (e.g. owner, manager, trustee, legal counsel, etc.)

OKLAHOMA BAR ASSOCIATION NUMBER
(IF APPLICABLE)

NOTARY

STATE OF OKLAHOMA)

COUNTY OF BEAVER) SS

The foregoing instrument was acknowledged before me this _____ day of _____, 20_____

[Signature]
Notary Public Signature

My commission expires: 6/9/2029

(SEAL)

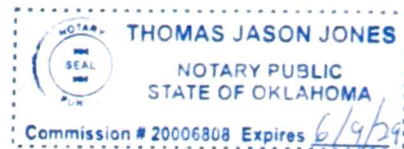

9. SUBMISSION AND PROCESSING

The submitted application packet must include the following:

- a. Original completed application (Typed or printed in ink, with legible markings, signed and notarized.);
- b. Filing fee payment (Review of the application will not begin until the filing fee is received. Filing fees are refunded at the discretion of the OWRB. Preferred payment method is a check payable to the OWRB. Other payment methods include cash, money order, or credit card via the OWRB Website Pay Portal – please provide a copy of the Pay Portal receipt. If water is used before application approval, double the filing fee will be required.);
- c. Ownership documents (Copies of deeds, groundwater leases, easements, and or other letters of consent for all the land owned controlled by the applicant associated with the application. Tax documents are not accepted. Social security numbers are not required and should be marked out on documents that contain them.)
- d. Any other documentation requested by OWRB staff as necessary (Articles of organization or incorporation, memorandum of trust, license or registration from OMMA or ODAFF, contract for water sales, etc.).

Please note: Any incomplete or unresponsive answers may cause a delay in the processing of your application.

In addition, Oklahoma Administrative Code (OAC) 785.30-1-4(d) states: "If the application is defective to as to form, the Board shall advise the applicant of the corrections, amendments, or changes required and sixty (60) days shall be allowed for the refilling thereof. If the application is not corrected, amended, or changed within the time required, the Board may inactivate the application. Furthermore, OAC 785.30-3-3(b), states: "If an applicant does not correct an application or publish notice as instructed by the Board, and no further proceedings are initiated by the applicant for six months or more after last contact with the Board, the application shall be deemed withdrawn. The Board shall provide notice to the applicant that the application has been deemed withdrawn.