



OKLAHOMA

Water Resources Board

April 16, 2026

City of Haskell
Attn: Michael Keene
PO Box 9
Haskell, OK 74436

RE: Temporary Groundwater Application No. 2025-610, City of Haskell, Wagoner County

Dear Mr. Keene:

Your application to use groundwater has been reviewed by Board staff. In order to obtain a permit, you must provide notice of the essential facts about your intended use by newspaper publication and by notifying certain neighbors.

In accordance with Section 309 of Title 75 and Section 1020.8 of Title 82 of the Oklahoma Statutes, and Section 785:30-3-4 of the Oklahoma Administrative Code (OAC), we have enclosed a Notice of Application to be published at your expense in a newspaper that is qualified to publish legal notices in Wagoner County. The notice must be published once a week for the two consecutive weeks beginning on May 10, 2026 and May 17, 2026. Please send us, or have the publisher forward to us, the certified proofs of publication by June 8, 2026. Because the Board is not responsible for the accuracy of the information contained in the notice, please review the enclosed notice carefully and contact the Board if you note any errors or have any questions.

In addition to giving notice by publication of your application to withdraw groundwater, OAC Section 785:30-3-4(a) requires that you notify by certified mail (return receipt requested) all surface estate owners of lands located within 1,320 feet of the outside boundary of each ten-acre tract regarding wells subject to your application. Please notify these landowners on or before the first day of publication. We have enclosed extra copies of the notice for this purpose. You may make additional copies if you need more than we have provided. Also enclosed is an affidavit certifying you have notified all of these surface estate owners. The affidavit must be signed, notarized, and returned to the Board, along with all green cards, by or before June 8, 2026.

Any protests to your application must be filed with the Board by June 15, 2026. If a protest is filed, a hearing may be scheduled and you will be notified.

If you have any questions concerning this matter, please contact Sharon Robinson at the address below or call (405) 530-8800.

Sincerely,

Chris Neel, Division Chief
Water Rights Administration Division

AFFIDAVIT OF NOTIFICATION

I hereby certify that I, Michael Keene, on behalf of the City of Haskell, have notified all surface estate owners of lands located within 1,320 feet of the outside boundary of each ten acre tract of the wells subject of application number 2025-610, of their intention to use groundwater by forwarding the notice of application by U.S. Mail, certified mail return receipt requested, on _____ (date mailed) to the following:

(List of names and addresses should correspond to those listed on the Ownership Plat attached to the application. Please attach separate page if more space is needed. PLEASE ATTACH ALL GREEN CARDS TO AFFIDAVIT, along with a copy of the notice.)

NAME

ADDRESS

_____	_____
_____	_____
_____	_____
_____	_____
_____	_____
_____	_____
_____	_____
_____	_____
_____	_____
_____	_____

Applicant's Signature

Subscribed and sworn to before me this _____ day of _____, 20_____

Notary Public Signature

[seal]

My Commission Expires:

NOTE TO PUBLISHER: To be published in Wagoner County once during the week of May 10, 2026 but no later than May 16, 2026, and once during the week of May 17, 2026 but no later than May 23, 2026, AT APPLICANT'S EXPENSE. (PUBLISHER NEEDS TO FURNISH THE OKLAHOMA WATER RESOURCES BOARD A CERTIFIED PROOF OF PUBLICATION ON OR BEFORE June 8, 2026.)

NOTICE OF APPLICATION TO USE GROUNDWATER

City of Haskell c/o Michael Keene of PO Box 9, Haskell, OK 74436 has filed an application, #2025-610, with the Oklahoma Water Resources Board (Board) for a permit to use 310.36 acre-feet of groundwater per year. The groundwater is proposed to be used for public water supply (municipal use) and taken from 155.18 acres located as follows: 17 acres in the N2 N2 of Section 3, T15N; 2 acres in the N2 NE SE of Section 31 and 136.18 acres in Section 34, T16N; all in R16EIM, Wagoner County. The water is to be withdrawn from nineteen (19) wells located as follows: one (1) well in the SE NE NW, two (2) wells each in the NE NE NW and NW NW NE of Section 3, T15N; one (1) well in the SW NW NE, two (2) wells each in the NE NW NE and SE NW SE, three (3) wells each in the SE SW NE, NE SW NE, SE NW NE of Section 34, T16; all in R16EIM, Wagoner County and use the groundwater in the City of Haskell service area within Muskogee County and Wagoner County, Oklahoma, as more specifically described in the application, viewable at oklahoma.gov/owrb. Wells and dedicated lands are located over the Arkansas River Alluvium and Terrace groundwater basin. Use of groundwater is governed by Sections 1020.1 and following of Title 82 of the Oklahoma Statutes and rules of the Board, Oklahoma Administrative Code (OAC), Title 785, Chapters 4 & 30.

Protests to the application must be in writing and received by the Board at the address listed below and by the applicant at the address listed above no later than June 15, 2026, and contain the following: (1) name, address, and telephone number of the interested person; (2) the particular application number to which the protest relates; (3) specific information to show how approval of the application proposed may directly and adversely affect legally protected interests of the person filing the protest; and (4) a statement of the relief sought by the interested person. A person who sends a letter containing only a general objection or comment will not be deemed to be a party, but the letter will be made part of the permanent record.

If a protest that meets the requirements listed in the paragraph above is filed with both the applicant and Board, a hearing on this application will be scheduled and the applicant and protestant(s) will be advised of the hearing date. Protestants or their representatives must appear at the hearing and present the protest to be considered. Hearings are governed by Section 309 of Title 75 and Section 1020.8 of Title 82 of the Oklahoma Statutes, and the rules of Board, OAC Title 785, chapters 4 and 30. If you have any questions, please contact Sharon Robinson at (405) 530-8800. Board mailing address: Oklahoma Water Resources Board, Water Rights Administration Division, 3800 N. Classen Blvd., Oklahoma City, OK 73118-2881. Board fax number: (405) 530-8900.

NOTICE PROVIDED VIA CERTIFIED MAIL

NOTICE OF APPLICATION TO USE GROUNDWATER

City of Haskell c/o Michael Keene of PO Box 9, Haskell, OK 74436 has filed an application, #2025-610, with the Oklahoma Water Resources Board (Board) for a permit to use 310.36 acre-feet of groundwater per year. The groundwater is proposed to be used for public water supply (municipal use) and taken from 155.18 acres located as follows: 17 acres in the N2 N2 of Section 3, T15N; 2 acres in the N2 NE SE of Section 31 and 136.18 acres in Section 34, T16N; all in R16EIM, Wagoner County. The water is to be withdrawn from nineteen (19) wells located as follows: one (1) well in the SE NE NW, two (2) wells each in the NE NE NW and NW NW NE of Section 3, T15N; one (1) well in the SW NW NE, two (2) wells each in the NE NW NE and SE NW SE, three (3) wells each in the SE SW NE, NE SW NE, SE NW NE of Section 34, T16; all in R16EIM, Wagoner County and use the groundwater in the City of Haskell service area within Muskogee County and Wagoner County, Oklahoma, as more specifically described in the application, viewable at oklahoma.gov/owrb. Wells and dedicated lands are located over the Arkansas River Alluvium and Terrace groundwater basin. Use of groundwater is governed by Sections 1020.1 and following of Title 82 of the Oklahoma Statutes and rules of the Board, Oklahoma Administrative Code (OAC), Title 785, Chapters 4 & 30.

Protests to the application must be in writing and received by the Board at the address listed below and by the applicant at the address listed above no later than June 15, 2026, and contain the following: (1) name, address, and telephone number of the interested person; (2) the particular application number to which the protest relates; (3) specific information to show how approval of the application proposed may directly and adversely affect legally protected interests of the person filing the protest; and (4) a statement of the relief sought by the interested person. A person who sends a letter containing only a general objection or comment will not be deemed to be a party, but the letter will be made part of the permanent record.

If a protest that meets the requirements listed in the paragraph above is filed with both the applicant and Board, a hearing on this application will be scheduled and the applicant and protestant(s) will be advised of the hearing date. Protestants or their representatives must appear at the hearing and present the protest to be considered. Hearings are governed by Section 309 of Title 75 and Section 1020.8 of Title 82 of the Oklahoma Statutes, and the rules of Board, OAC Title 785, chapters 4 and 30. If you have any questions, please contact Sharon Robinson at (405) 530-8800. Board mailing address: Oklahoma Water Resources Board, Water Rights Administration Division, 3800 N. Classen Blvd., Oklahoma City, OK 73118-2881. Board fax number: (405) 530-8900.

APPLICATION FOR A LONG-TERM GROUNDWATER PERMIT

Received on 12/22/2025
Paid Check #25252 \$500.00
#25452 \$500.00

Authorizations received on 3/6/2026

OKLAHOMA WATER RESOURCES BOARD
WATER RIGHTS ADMINISTRATION DIVISION
3800 North Classen Blvd., Oklahoma City, OK 73118
Phone: (405) 530-8800 Fax: (405) 530-8900
Website: <https://oklahoma.gov/owrb.html>
(See website for FAQs)

FILING FEE

Application review will not begin until the proper filing fee is received. Double the filing fee if water is used before application approval. If the requested amount of water is fractional, round up to the next whole number for the purposes of determining the filing fee.

Amount of Water Requested	Filing Fee**
1 - 320 acre-feet.....	\$500.00
321 - 640 acre-feet.....	\$700.00
641 - 1,500 acre-feet.....	\$900.00
Over 1,500 acre-feet.....	\$900.00*

*Plus \$250.00 for each increment of 500 acre-feet above 1,500 acre-feet requested (Maximum Fee \$4,000.00).
**Plus \$250.00 if the application overlies a sensitive sole-source groundwater basin. Applications for the purpose of enhanced recovery of oil and gas shall have a flat filing fee of \$4,500.00.

OFFICE USE ONLY

Application No. 20250610
Permit Type Temporary
GW Basin Arkansas River A&T
Equal Proportionate Share _____

1. NAME & CONTACT INFORMATION Print the applicant's name to exactly match what is listed on the ownership document. Consultants and legal counsel should provide a cover letter with contact information and state if they will remain the contact after permit approval.

Applicant Name City of Haskell Phone (918) 482-3933
Mailing Address PO Box 9/1424 N Haskell Blvd City Haskell State OK Zip 74436
Email mkeenc@Haskellok.org Fax (918) 482-3148
Contact Name (if different than applicant) Michael Keenc Phone () -
Mailing Address _____ City _____ State _____ Zip _____
Email _____ Fax () -

How should correspondence be sent during application review? Check all that apply: Postal Mail Email Fax

2. QUANTITY OF WATER & PURPOSE Identify how much water will be used and where. Choose at least one purpose (i.e. beneficial use) from the following list: Irrigation, Agriculture, Mining, Public Water Supply, Commercial, Industrial, Power Generation, Recreation Fish & Wildlife, and Other. A description can be helpful and may be required to complete application review. Answer the questions and provide the requested information for each. Conversion factor: one acre-foot of water will cover one acre of land one foot deep and is equal to 325,851 gallons.

Groundwater requested: ~~142.36~~ ^{310.36} acre-feet per year. Water used in Muskogee county.

Purpose: Public Water Supply
(e.g. Agriculture - Poultry Houses or Greenhouse; Mining - Oil & Gas or Rock Quarry; Recreation - Flood a Wetland for Hunting)

Have you already used the water for which you are applying? Yes No If yes, double the filing fee will be required.

Will water be sold? Yes No If yes, list the purchaser: _____ (not required for public water suppliers)

Will animals be raised? Yes No If yes, list animal type: _____ (not required for domestic use of stock water)

Will crops be grown? Yes No If yes, approximate area of watered crops: _____ and; (use units of acres for fields or square feet for indoor)

List of crops: _____

3. DEDICATED LAND List the legal description of all the land to be dedicated. Do not use city lot and block numbers or metes and bounds. If additional space is needed, list on a separate sheet of paper. An explanation of legal descriptions can be found on the OWRB website FAQs page. Dedicated land must be drawn on the application plat map.

71.18 total acres owned; 84 total acres leased; _____ total acres platted (municipal only)

136.18 acres in _____ 1/4 of _____ 1/4 of _____ 1/4 of Section 34 Twp. 16 N S Rng. 16 EIM WIM in Wagoner County ECM

17 acres in _____ 1/4 of N2 1/4 of N2 1/4 of Section 3 Twp. 15 N S Rng. 16 EIM WIM in Wagoner County ECM

2 acres in N2 1/4 of NE 1/4 of SE 1/4 of Section 31 Twp. 16 N S Rng. 16 EIM WIM in Wagoner County ECM

_____ acres in _____ 1/4 of _____ 1/4 of _____ 1/4 of Section _____ Twp. _____ N S Rng. _____ EIM WIM in _____ County ECM

4. WELL INFORMATION List the number and legal description for all wells (either existing or proposed) that are requested to be permitted. Existing wells require a ten acre tract legal description. Depth and pumping rate are required for all existing wells and a range of values (e.g. 400 – 500 feet) can be provided for multiple existing wells. Estimated depth and pumping rate may be required for proposed wells in areas with multiple groundwater basins. Provide an answer to the well spacing exception question. If additional space is needed, list on a separate sheet of paper. An explanation of legal descriptions can be found on the OWRB website FAQs page. All wells must be drawn on the application plat map.

Water is to be withdrawn from 19 total well(s) located as follows:

2 wells in NE 1/4 of NW 1/4 of NE 1/4 of Section 34 Twp. 16 N S Rng. 16 EIM WIM in Wagoner County Existing Yes No ECM

3 wells in SE 1/4 of NW 1/4 of NE 1/4 of Section 34 Twp. 16 N S Rng. 16 EIM WIM in Wagoner County Existing Yes No ECM

1 wells in SW 1/4 of NW 1/4 of NE 1/4 of Section 34 Twp. 16 N S Rng. 16 EIM WIM in Wagoner County Existing Yes No ECM

Depth: 10 - 50 feet; Pumping Rate: 33 gallons per minute

Requesting a well spacing exception? Yes No Blank responses will not be accepted. If yes, please provide an attached explanation to show how compliance with well spacing would be inequitable or unreasonable. Examples can be found in OAC 785:30-3-6(b)(1). A well spacing exception may be required based on application review.

5. MUNICIPALITIES Only municipalities are required to complete this section. All other applicants can skip this section. Answer the questions and provide copies of the requested maps.

Will platted land be dedicated within the municipal boundary? Yes No

If yes, will the municipality make water available to those platted lands? Yes No

If yes, provide attached map(s) that show the following: service area, water lines, and platted lands.

OFFICE USE ONLY	
SIC Codes	
<u>2</u>	<u>4941</u>

3. DEDICATED LAND List the legal description of all the land to be dedicated. Do not use city lot and block numbers or metes and bounds. If additional space is needed, list on a separate sheet of paper. An explanation of legal descriptions can be found on the OWRB website FAQs page. Dedicated land must be drawn on the application plat map.

_____ total acres owned; _____ total acres leased; _____ total acres platted (municipal only)

_____ acres in _____ 1/4 of _____ 1/4 of _____ 1/4 of Section _____ Twp. _____ ON _____ O EIM
 _____ O S Rng. _____ O WIM in _____
 _____ O ECM _____ County

_____ acres in _____ 1/4 of _____ 1/4 of _____ 1/4 of Section _____ Twp. _____ ON _____ O EIM
 _____ O S Rng. _____ O WIM in _____
 _____ O ECM _____ County

_____ acres in _____ 1/4 of _____ 1/4 of _____ 1/4 of Section _____ Twp. _____ ON _____ O EIM
 _____ O S Rng. _____ O WIM in _____
 _____ O ECM _____ County

_____ acres in _____ 1/4 of _____ 1/4 of _____ 1/4 of Section _____ Twp. _____ ON _____ O EIM
 _____ O S Rng. _____ O WIM in _____
 _____ O ECM _____ County

4. WELL INFORMATION List the number and legal description for all wells (either existing or proposed) that are requested to be permitted. Existing wells require a ten acre tract legal description. Depth and pumping rate are required for all existing wells and a range of values (e.g. 400 – 500 feet) can be provided for multiple existing wells. Estimated depth and pumping rate may be required for proposed wells in areas with multiple groundwater basins. Provide an answer to the well spacing exception question. If additional space is needed, list on a separate sheet of paper. An explanation of legal descriptions can be found on the OWRB website FAQs page. All wells must be drawn on the application plat map.

Water is to be withdrawn from 19 total well(s) located as follows:

3 wells in NE 1/4 of SW 1/4 of NE 1/4 of Section 34 Twp. 16 N S Rng. 16 EIM WIM in Wagoner Existing Yes No
 ECM _____ County Well? No

3 wells in SE 1/4 of SW 1/4 of NE 1/4 of Section 34 Twp. 16 N S Rng. 16 EIM WIM in Wagoner Existing Yes No
 ECM _____ County Well? No

_____ wells in _____ 1/4 of _____ 1/4 of _____ 1/4 of Section _____ Twp. _____ N S Rng. _____ EIM WIM in _____ Existing Yes No
 ECM _____ County Well? No

Depth: _____ feet; Pumping Rate: _____ gallons per minute

Requesting a well spacing exception? Yes No Blank responses will not be accepted. If yes, please provide an attached explanation to show how compliance with well spacing would be inequitable or unreasonable. Examples can be found in OAC 785:30-3-6(b)(1). A well spacing exception may be required based on application review.

5. MUNICIPALITIES Only municipalities are required to complete this section. All other applicants can skip this section. Answer the questions and provide copies of the requested maps.

Will platted land be dedicated within the municipal boundary? Yes No

If yes, will the municipality make water available to those platted lands? Yes No

If yes, provide attached map(s) that show the following: service area, water lines, and platted lands.

OFFICE USE ONLY	
SIC Codes	

3. DEDICATED LAND List the legal description of all the land to be dedicated. Do not use city lot and block numbers or metes and bounds. If additional space is needed, list on a separate sheet of paper. An explanation of legal descriptions can be found on the OWRB website FAQs page. Dedicated land must be drawn on the application plat map.

_____ total acres owned; _____ total acres leased; _____ total acres platted (municipal only)
_____ acres in _____ 1/4 of _____ 1/4 of _____ 1/4 of Section _____ Twp. _____ ON _____ O EIM
_____ OS Rng. _____ OWIM in _____ County
_____ O ECM

4. WELL INFORMATION List the number and legal description for all wells (either existing or proposed) that are requested to be permitted. Existing wells require a ten acre tract legal description. Depth and pumping rate are required for all existing wells and a range of values (e.g. 400 – 500 feet) can be provided for multiple existing wells. Estimated depth and pumping rate may be required for proposed wells in areas with multiple groundwater basins. Provide an answer to the well spacing exception question. If additional space is needed, list on a separate sheet of paper. An explanation of legal descriptions can be found on the OWRB website FAQs page. All wells must be drawn on the application plat map.

Water is to be withdrawn from _____ total well(s) located as follows:

2 wells in SE 1/4 of NW 1/4 of SE 1/4 of Section 34 Twp. 16 N S Rng. 16 EIM WIM in Wagoner Existing Yes Well? No
2 wells in NW 1/4 of NW 1/4 of NE 1/4 of Section 3 Twp. 15 N S Rng. 16 EIM WIM in Wagoner Existing Yes Well? No
2 wells in NE 1/4 of NE 1/4 of NW 1/4 of Section 3 Twp. 15 N S Rng. 16 EIM WIM in Wagoner Existing Yes Well? No
1 SE NE NW 3 15N

Depth: _____ feet; Pumping Rate: _____ gallons per minute

Requesting a well spacing exception? Yes No Blank responses will not be accepted. If yes, please provide an attached explanation to show how compliance with well spacing would be inequitable or unreasonable. Examples can be found in OAC 785:30-3-6(b)(1). A well spacing exception may be required based on application review.

5. MUNICIPALITIES Only municipalities are required to complete this section. All other applicants can skip this section. Answer the questions and provide copies of the requested maps.

Will platted land be dedicated within the municipal boundary? Yes No

If yes, will the municipality make water available to those platted lands? Yes No

If yes, provide attached map(s) that show the following: service area, water lines, and platted lands.

OFFICE USE ONLY
SIC Codes
Table with 2 columns and 4 rows for recording SIC codes.

6. PLAT MAP Follow the instructions on the preceding page unless otherwise directed by the Board. Drawings must match the legal description of dedicated land and wells described in Section 3 and 4 of the application. More than one plat map may be required.

Application No. 20250610

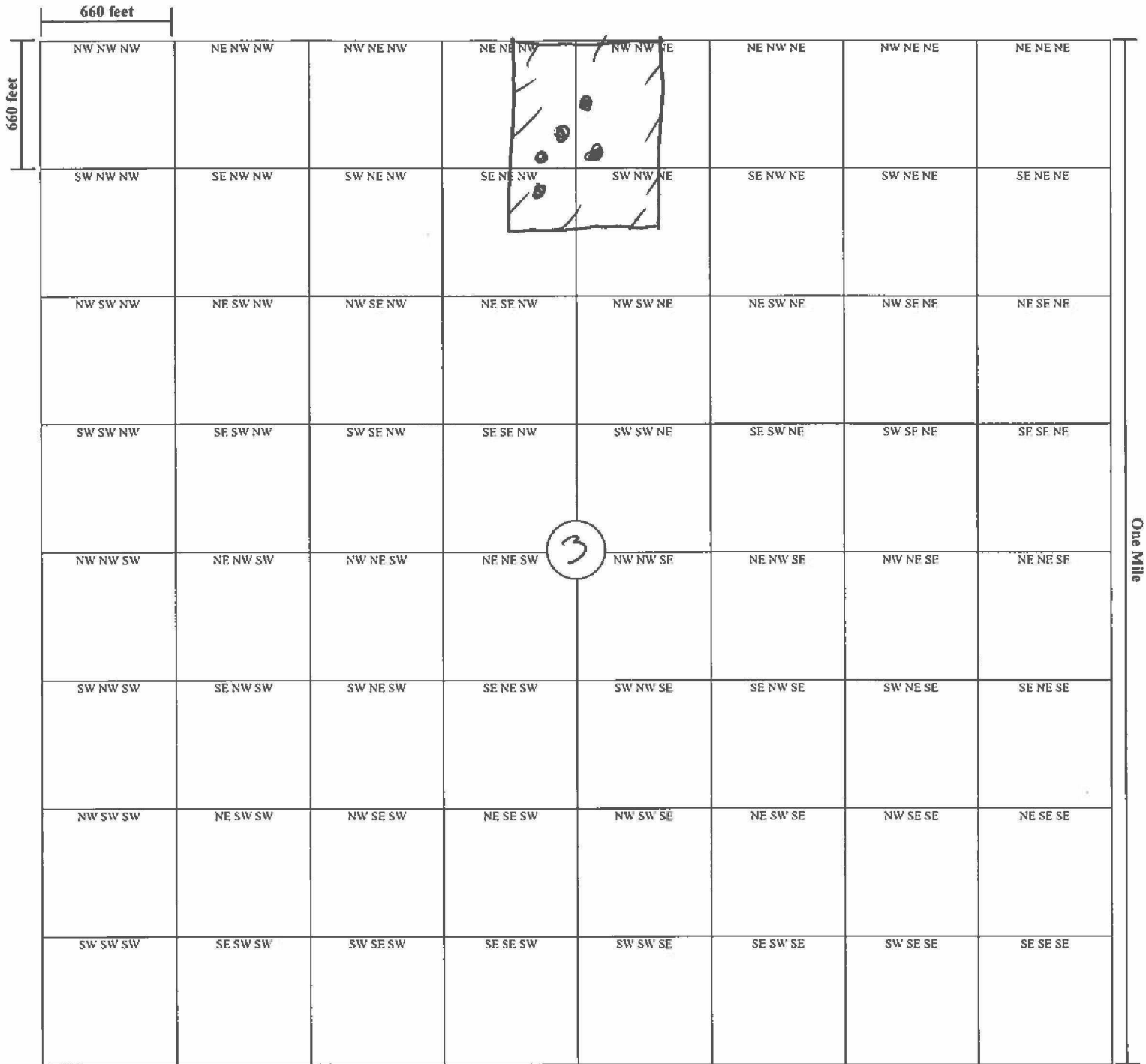

3 15N 16E1M
Section – Township – Range

Wagoner
County



Land Dedicated



Area of Use



Proposed Well Location Area

● Existing Wells to be Permitted

○ Existing Wells Owned by Others (i.e. domestic, stock, permitted, etc.)

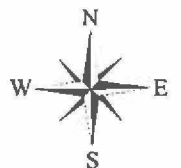

6. PLAT MAP Follow the instructions on the preceding page unless otherwise directed by the Board. Drawings must match the legal description of dedicated land and wells described in Section 3 and 4 of the application. More than one plat map may be required.

Application No. 20250610

660 feet	660 feet								One Mile
	NW NW NW	NE NW NW	NW NE NW	NE NE NW	NW NW NE	NE NW NE	NW NE NE	NE NE NE	
	SW NW NW	SE NW NW	SW NE NW	SE NE NW	SW NW NE	SE NW NE	SW NE NE	SE NE NE	
	NW SW NW	NE SW NW	NW SE NW	NE SE NW	NW SW NE	NE SW NE	NW SE NE	NE SE NE	
	SW SW NW	SE SW NW	SW SE NW	SE SE NW	SW SW NE	SE SW NE	SW SE NE	SE SE NE	
	NW NW SW	NE NW SW	NW NE SW	NE NE SW	31 NW NW SE	NE NW SE	NW NE SE	NE NE SE	
	SW NW SW	SE NW SW	SW NE SW	SE NE SW	SW NW SE	SE NW SE	SW NE SE	SE NE SE	
	NW SW SW	NE SW SW	NW SE SW	NE SE SW	NW SW SE	NE SW SE	NW SE SE	NE SE SE	
SW SW SW	SE SW SW	SW SE SW	SE SE SW	SW SW SE	SE SW SE	SW SE SE	SE SE SE		

31-16 N-16 E 1st
Section - Township - Range

Wagoner
County



- Existing Wells to be Permitted
- Existing Wells Owned by Others (i.e. domestic, stock, permitted, etc.)

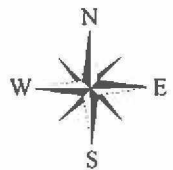

8. SIGNATURES

Upon my oath or affirmation, I swear or affirm (1) that all information submitted to the Oklahoma Water Resources Board in connection with this application is true and accurate to the best of my knowledge; and (2) that I or the person or entity I represent will comply with all applicable laws and regulations of the State of Oklahoma or its agencies, and any lawful conditions imposed by the Oklahoma Water Resources Board, which apply or pertain to the use of fresh groundwater.

[Signature]
SIGNATURE OF APPLICANT
Michael D. Keene
PRINTED NAME
City Manager
TITLE (e.g. owner, manager, trustee, legal counsel, etc.)
OKLAHOMA BAR ASSOCIATION NUMBER
(IF APPLICABLE)

NOTARY

STATE OF Oklahoma)
COUNTY OF Muskogee) ss.

The foregoing instrument was acknowledged before

me this 22nd day of July, 2025

[Signature]
Notary Public Signature

My commission expires: 10-12-2028

(SEAL)

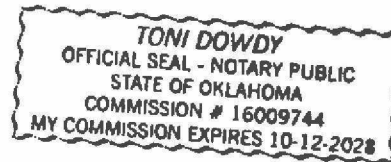

9. SUBMISSION AND PROCESSING

The submitted application packet must include the following:

- a. Original completed application (Typed or printed in ink, with legible markings, signed and notarized.);
- b. Filing fee payment (Review of the application will not begin until the filing fee is received. Filing fees are refunded at the discretion of the OWRB. Preferred payment method is a check payable to the OWRB. Other payment methods include cash, money order, or credit card via the OWRB Website Pay Portal – please provide a copy of the Pay Portal receipt. If water is used before application approval, double the filing fee will be required.);
- c. Ownership documents (Copies of deeds, groundwater leases, easements, and/or other letters of consent for all the land owned/controlled by the applicant associated with the application. Tax documents are not accepted. Social security numbers are not required and should be marked out on documents that contain them.)
- d. Any other documentation requested by OWRB staff as necessary (Articles of organization or incorporation, memorandum of trust, license or registration from OMMA or ODAFF, contract for water sales, etc.).

Please note: Any incomplete or unresponsive answers may cause a delay in the processing of your application.

In addition, Oklahoma Administrative Code (OAC) 785:30-1-4(d) states: "If the application is defective to as to form, the Board shall advise the applicant of the corrections, amendments, or changes required and sixty (60) days shall be allowed for the refilling thereof. If the application is not corrected, amended, or changed within the time required, the Board may inactivate the application. Furthermore, OAC 785:30-3-3(b), states: "If an applicant does not correct an application or publish notice as instructed by the Board, and no further proceedings are initiated by the applicant for six months or more after last contact with the Board, the application shall be deemed withdrawn. The Board shall provide notice to the applicant that the application has been deemed withdrawn.

RECEIVED

3/6/2026

OKLAHOMA WATER RESOURCES BOARD

To: Oklahoma Water Resources Board
3800 N. Classen Boulevard
Oklahoma City, OK 73118
ATTN: Jacob Hernandez

(405) 530-8928 Phone
(405) 530-8900 Fax

I authorize the Oklahoma Water Resources Board (OWRB) to make the following revisions to the Groundwater Permit Application # **20250610**:

1. The amount of water that can be allocated on the permit can be increased. Please choose how you want to proceed (circle one):

a. 310.36 acre-feet per year

b. Other (Please write on the line below)

_____ acre-feet per year

2. Change the amount of dedicated land to 71.18 acres of owned land and 84 acres of leased land.
3. Add the description of the land to be dedicated:
 - a. 136.18 acres in Section 34-16N-16EIM, Wagoner County
4. The plat map has been modified on the following page. Please review it, modify it as necessary, then sign and date the bottom of the page.

By: _____

Michael Keene
City Manager
City of Haskell

Date: _____

3/6/2026