

AFFIDAVIT OF NOTIFICATION

I hereby certify that I, Chuck Madsen, on behalf of Owen and Delynne Creason, have notified all surface estate owners of lands located within 1,320 feet of the outside boundary of each ten acre tract of the wells subject of application number 2024-635, of their intention to use groundwater by forwarding the notice of application by U.S. Mail, certified mail return receipt requested, on _____ (date mailed) to the following:

(List of names and addresses should correspond to those listed on the Ownership Plat attached to the application. Please attach separate page if more space is needed. PLEASE ATTACH ALL GREEN CARDS TO AFFIDAVIT, along with a copy of the notice.)

NAME

ADDRESS

_____	_____
_____	_____
_____	_____
_____	_____
_____	_____
_____	_____
_____	_____
_____	_____
_____	_____
_____	_____

Applicant's Signature

Subscribed and sworn to before me this
_____ day of _____, 20____

Notary Public Signature

[seal]

My Commission Expires:

NOTE TO PUBLISHER: To be published in *Texas County* once during the week of June 21, 2026 but no later than June 27, 2026, and once during the week of June 28, 2026 but no later than July 4, 2026, AT APPLICANT'S EXPENSE. (PUBLISHER NEEDS TO FURNISH THE OKLAHOMA WATER RESOURCES BOARD A CERTIFIED PROOF OF PUBLICATION ON OR BEFORE July 20, 2026.)

NOTICE OF APPLICATION TO USE GROUNDWATER

Owen and Delynne Creason c/o Chuck Madsen of PO Box 784, Beaver, OK 73932 has filed an application, #2024-635, with the Oklahoma Water Resources Board (Board) for a permit to use 640 acre-feet of groundwater per year. The groundwater is proposed to be used for irrigation (wheat and hay) and taken from 320 acres located as follows: 160 acres in the NE and 160 acres in the SW of Section 21, T1N, R19ECM, Texas County. The water is to be withdrawn from one (1) well in the NE SW NE of Section 21, T1N, R19ECM, Texas County, and use the groundwater in Texas County, Oklahoma, as more specifically described in the application, viewable at oklahoma.gov/owrb. Wells and dedicated lands are located over the Ogallala Panhandle groundwater basin. Board rules require that the well be located a distance of at least 1,320 feet from existing wells or proposed well locations on lands of another unless a well location exception is granted. Use of groundwater is governed by Sections 1020.1 and following Title 82 of the Oklahoma Statutes and rules of the Board, Oklahoma Administrative Code, Title 785, Chapters 4 and 30.

Protests to the application must be in writing and received by the Board at the address listed below and by the applicant at the address listed above no later than July 27, 2026, and contain the following: (1) name, address, and telephone number of the interested person; (2) the particular application number to which the protest relates; (3) specific information to show how approval of the application proposed may directly and adversely affect legally protected interests of the person filing the protest; and (4) a statement of the relief sought by the interested person. A person who sends a letter containing only a general objection or comment will not be deemed to be a party, but the letter will be made part of the permanent record.

If a protest that meets the requirements listed in the paragraph above is filed with both the applicant and Board, a hearing on this application will be scheduled and the applicant and protestant(s) will be advised of the hearing date. Protestants or their representatives must appear at the hearing and present the protest to be considered. Hearings are governed by Section 309 of Title 75 and Section 1020.8 of Title 82 of the Oklahoma Statutes, and the rules of Board, OAC Title 785, chapters 4 and 30. If you have any questions, please contact Sharon Robinson at (405) 530-8800. Board mailing address: Oklahoma Water Resources Board, Water Rights Administration Division, 3800 N. Classen Blvd., Oklahoma City, OK 73118-2881. Board fax number: (405) 530-8900.

NOTICE PROVIDED VIA CERTIFIED MAIL

NOTICE OF APPLICATION TO USE GROUNDWATER

Owen and Delynne Creason c/o Chuck Madsen of PO Box 784, Beaver, OK 73932 has filed an application, #2024-635, with the Oklahoma Water Resources Board (Board) for a permit to use 640 acre-feet of groundwater per year. The groundwater is proposed to be used for irrigation (wheat and hay) and taken from 320 acres located as follows: 160 acres in the NE and 160 acres in the SW of Section 21, T1N, R19ECM, Texas County. The water is to be withdrawn from one (1) well in the NE SW NE of Section 21, T1N, R19ECM, Texas County, and use the groundwater in Texas County, Oklahoma, as more specifically described in the application, viewable at oklahoma.gov/owrb. Wells and dedicated lands are located over the Ogallala Panhandle groundwater basin. Board rules require that the well be located a distance of at least 1,320 feet from existing wells or proposed well locations on lands of another unless a well location exception is granted. Use of groundwater is governed by Sections 1020.1 and following Title 82 of the Oklahoma Statutes and rules of the Board, Oklahoma Administrative Code, Title 785, Chapters 4 and 30.

Protests to the application must be in writing and received by the Board at the address listed below and by the applicant at the address listed above no later than July 27, 2026, and contain the following: (1) name, address, and telephone number of the interested person; (2) the particular application number to which the protest relates; (3) specific information to show how approval of the application proposed may directly and adversely affect legally protected interests of the person filing the protest; and (4) a statement of the relief sought by the interested person. A person who sends a letter containing only a general objection or comment will not be deemed to be a party, but the letter will be made part of the permanent record.

If a protest that meets the requirements listed in the paragraph above is filed with both the applicant and Board, a hearing on this application will be scheduled and the applicant and protestant(s) will be advised of the hearing date. Protestants or their representatives must appear at the hearing and present the protest to be considered. Hearings are governed by Section 309 of Title 75 and Section 1020.8 of Title 82 of the Oklahoma Statutes, and the rules of Board, OAC Title 785, chapters 4 and 30. If you have any questions, please contact Sharon Robinson at (405) 530-8800. Board mailing address: Oklahoma Water Resources Board, Water Rights Administration Division, 3800 N. Classen Blvd., Oklahoma City, OK 73118-2881. Board fax number: (405) 530-8900.

AFFIDAVIT OF NOTIFICATION

I hereby certify that I, Chuck Madsen, on behalf of Owen and Delynne Creason, have notified all surface estate owners of lands located within 1,320 feet of the outside boundary of each ten acre tract of the wells subject of application number 2024-635, of their intention to use groundwater by forwarding the notice of application by U.S. Mail, certified mail return receipt requested, on _____ (date mailed) to the following:

(List of names and addresses should correspond to those listed on the Ownership Plat attached to the application. Please attach separate page if more space is needed. PLEASE ATTACH ALL GREEN CARDS TO AFFIDAVIT, along with a copy of the notice.)

NAME

ADDRESS

Applicant's Signature

Subscribed and sworn to before me this _____ day of _____, 20____

Notary Public Signature

[seal]

My Commission Expires:

NOTE TO PUBLISHER: To be published in *Texas County* once during the week of April 19, 2026 but no later than April 25, 2026, and once during the week of April 26, 2026 but no later than May 2, 2026, AT APPLICANT'S EXPENSE. (PUBLISHER NEEDS TO FURNISH THE OKLAHOMA WATER RESOURCES BOARD A CERTIFIED PROOF OF PUBLICATION ON OR BEFORE May 11, 2026.)

NOTICE OF APPLICATION TO USE GROUNDWATER

Owen and Delynne Creason c/o Chuck Madsen of PO Box 784, Beaver, OK 73932 has filed an application, #2024-635, with the Oklahoma Water Resources Board (Board) for a permit to use 640 acre-feet of groundwater per year. The groundwater is proposed to be used for irrigation (wheat and hay) and taken from 320 acres located as follows: 160 acres in the NE and 160 acres in the SW of Section 21, T1N, R19ECM, Texas County. The water is to be withdrawn from one (1) well in the NE SW NE of Section 21, T1N, R19ECM, Texas County, and use the groundwater in Texas County, Oklahoma, as more specifically described in the application, viewable at oklahoma.gov/owrb. Wells and dedicated lands are located over the Ogallala Panhandle groundwater basin. Board rules require that the well be located a distance of at least 1,320 feet from existing wells or proposed well locations on lands of another unless a well location exception is granted. Use of groundwater is governed by Sections 1020.1 and following Title 82 of the Oklahoma Statutes and rules of the Board, Oklahoma Administrative Code, Title 785, Chapters 4 and 30.

Protests to the application must be in writing and received by the Board at the address listed below and by the applicant at the address listed above no later than May 18, 2026, and contain the following: (1) name, address, and telephone number of the interested person; (2) the particular application number to which the protest relates; (3) specific information to show how approval of the application proposed may directly and adversely affect legally protected interests of the person filing the protest; and (4) a statement of the relief sought by the interested person. A person who sends a letter containing only a general objection or comment will not be deemed to be a party, but the letter will be made part of the permanent record.

If a protest that meets the requirements listed in the paragraph above is filed with both the applicant and Board, a hearing on this application will be scheduled and the applicant and protestant(s) will be advised of the hearing date. Protestants or their representatives must appear at the hearing and present the protest to be considered. Hearings are governed by Section 309 of Title 75 and Section 1020.8 of Title 82 of the Oklahoma Statutes, and the rules of Board, OAC Title 785, chapters 4 and 30. If you have any questions, please contact Sharon Robinson at (405) 530-8800. Board mailing address: Oklahoma Water Resources Board, Water Rights Administration Division, 3800 N. Classen Blvd., Oklahoma City, OK 73118-2881. Board fax number: (405) 530-8900.

NOTICE PROVIDED VIA CERTIFIED MAIL

NOTICE OF APPLICATION TO USE GROUNDWATER

Owen and Delynne Creason c/o Chuck Madsen of PO Box 784, Beaver, OK 73932 has filed an application, #2024-635, with the Oklahoma Water Resources Board (Board) for a permit to use 640 acre-feet of groundwater per year. The groundwater is proposed to be used for irrigation (wheat and hay) and taken from 320 acres located as follows: 160 acres in the NE and 160 acres in the SW of Section 21, T1N, R19ECM, Texas County. The water is to be withdrawn from one (1) well in the NE SW NE of Section 21, T1N, R19ECM, Texas County, and use the groundwater in Texas County, Oklahoma, as more specifically described in the application, viewable at oklahoma.gov/owrb. Wells and dedicated lands are located over the Ogallala Panhandle groundwater basin. Board rules require that the well be located a distance of at least 1,320 feet from existing wells or proposed well locations on lands of another unless a well location exception is granted. Use of groundwater is governed by Sections 1020.1 and following Title 82 of the Oklahoma Statutes and rules of the Board, Oklahoma Administrative Code, Title 785, Chapters 4 and 30.

Protests to the application must be in writing and received by the Board at the address listed below and by the applicant at the address listed above no later than May 18, 2026, and contain the following: (1) name, address, and telephone number of the interested person; (2) the particular application number to which the protest relates; (3) specific information to show how approval of the application proposed may directly and adversely affect legally protected interests of the person filing the protest; and (4) a statement of the relief sought by the interested person. A person who sends a letter containing only a general objection or comment will not be deemed to be a party, but the letter will be made part of the permanent record.

If a protest that meets the requirements listed in the paragraph above is filed with both the applicant and Board, a hearing on this application will be scheduled and the applicant and protestant(s) will be advised of the hearing date. Protestants or their representatives must appear at the hearing and present the protest to be considered. Hearings are governed by Section 309 of Title 75 and Section 1020.8 of Title 82 of the Oklahoma Statutes, and the rules of Board, OAC Title 785, chapters 4 and 30. If you have any questions, please contact Sharon Robinson at (405) 530-8800. Board mailing address: Oklahoma Water Resources Board, Water Rights Administration Division, 3800 N. Classen Blvd., Oklahoma City, OK 73118-2881. Board fax number: (405) 530-8900.



OKLAHOMA

Water Resources Board

December 30, 2025

Chuck Madsen
PO Box 784
Beaver, OK 73932

RE: Regular Groundwater Application No. 2024-635, Owen and Delynn Creason, Texas County

Dear Mr. Madsen:

Your application to use groundwater has been reviewed by Board staff. In order to obtain a permit, you must provide notice of the essential facts about your intended use by newspaper publication and by notifying certain neighbors.

In accordance with Section 309 of Title 75 and Section 1020.8 of Title 82 of the Oklahoma Statutes, and Section 785:30-3-4 of the Oklahoma Administrative Code (OAC), we have enclosed a Notice of Application to be published at your expense in a newspaper that is qualified to publish legal notices in Texas County. The notice must be published once a week for the two consecutive weeks beginning on January 18, 2026 and January 25, 2026. Please send us, or have the publisher forward to us, the certified proofs of publication by February 16, 2026. Because the Board is not responsible for the accuracy of the information contained in the notice, please review the enclosed notice carefully and contact the Board if you note any errors or have any questions.

In addition to giving notice by publication of your application to withdraw groundwater, OAC Section 785:30-3-4(a) requires that you notify by certified mail (return receipt requested) all surface estate owners of lands located within 1,320 feet of the outside boundary of each ten-acre tract regarding wells subject to your application. Please notify these landowners on or before the first day of publication. We have enclosed extra copies of the notice for this purpose. You may make additional copies if you need more than we have provided. Also enclosed is an affidavit certifying you have notified all of these surface estate owners. The affidavit must be signed, notarized, and returned to the Board, along with all green cards, by or before February 16, 2026.

Any protests to your application must be filed with the Board by February 23, 2026. If a protest is filed, a hearing may be scheduled and you will be notified.

If you have any questions concerning this matter, please contact Sharon Robinson at the address below or call (405) 530-8800.

Sincerely,



Chris Neel, Division Chief
Water Rights Administration Division

AFFIDAVIT OF NOTIFICATION

I hereby certify that I, Chuck Madsen, on behalf of Owen and Delynne Creason, have notified all surface estate owners of lands located within 1,320 feet of the outside boundary of each ten acre tract of the wells subject of application number 2024-635, of their intention to use groundwater by forwarding the notice of application by U.S. Mail, certified mail return receipt requested, on _____ (date mailed) to the following:

(List of names and addresses should correspond to those listed on the Ownership Plat attached to the application. Please attach separate page if more space is needed. PLEASE ATTACH ALL GREEN CARDS TO AFFIDAVIT, along with a copy of the notice.)

NAME

ADDRESS

_____	_____
_____	_____
_____	_____
_____	_____
_____	_____
_____	_____
_____	_____
_____	_____
_____	_____

Applicant's Signature

Subscribed and sworn to before me this
_____ day of _____, 20____

Notary Public Signature

[seal]

My Commission Expires:

NOTE TO PUBLISHER: To be published in *Texas County* once during the week of January 18, 2026 but no later than January 24, 2026, and once during the week of January 25, 2026 but no later than January 31, 2026, AT APPLICANT'S EXPENSE. (PUBLISHER NEEDS TO FURNISH THE OKLAHOMA WATER RESOURCES BOARD A CERTIFIED PROOF OF PUBLICATION ON OR BEFORE February 16, 2026.)

NOTICE OF APPLICATION TO USE GROUNDWATER

Owen and Delynn Creason c/o Chuck Madsen of PO Box 784, Beaver, OK 73932 has filed an application, #2024-635, with the Oklahoma Water Resources Board (Board) for a permit to use 640 acre-feet of groundwater per year. The groundwater is proposed to be used for irrigation (wheat and hay) and taken from 320 acres located as follows: 160 acres in the NE and 160 acres in the SW of Section 21, T1N, R19ECM, Texas County. The water is to be withdrawn from one (1) well in the NE SW NE of Section 21, T1N, R19ECM, Texas County, and use the groundwater in Texas County, Oklahoma, as more specifically described in the application, viewable at oklahoma.gov/owrb. Wells and dedicated lands are located over the Ogallala Panhandle groundwater basin. Board rules require that the well be located a distance of at least 1,320 feet from existing wells or proposed well locations on lands of another unless a well location exception is granted. Use of groundwater is governed by Sections 1020.1 and following Title 82 of the Oklahoma Statutes and rules of the Board, Oklahoma Administrative Code, Title 785, Chapters 4 and 30.

Protests to the application must be in writing and received by the Board at the address listed below and by the applicant at the address listed above no later than February 23, 2026, and contain the following: (1) name, address, and telephone number of the interested person; (2) the particular application number to which the protest relates; (3) specific information to show how approval of the application proposed may directly and adversely affect legally protected interests of the person filing the protest; and (4) a statement of the relief sought by the interested person. A person who sends a letter containing only a general objection or comment will not be deemed to be a party, but the letter will be made part of the permanent record.

If a protest that meets the requirements listed in the paragraph above is filed with both the applicant and Board, a hearing on this application will be scheduled and the applicant and protestant(s) will be advised of the hearing date. Protestants or their representatives must appear at the hearing and present the protest to be considered. Hearings are governed by Section 309 of Title 75 and Section 1020.8 of Title 82 of the Oklahoma Statutes, and the rules of Board, OAC Title 785, chapters 4 and 30. If you have any questions, please contact Sharon Robinson at (405) 530-8800. Board mailing address: Oklahoma Water Resources Board, Water Rights Administration Division, 3800 N. Classen Blvd., Oklahoma City, OK 73118-2881. Board fax number: (405) 530-8900.

NOTICE PROVIDED VIA CERTIFIED MAIL

NOTICE OF APPLICATION TO USE GROUNDWATER

Owen and Delynn Creason c/o Chuck Madsen of PO Box 784, Beaver, OK 73932 has filed an application, #2024-635, with the Oklahoma Water Resources Board (Board) for a permit to use 640 acre-feet of groundwater per year. The groundwater is proposed to be used for irrigation (wheat and hay) and taken from 320 acres located as follows: 160 acres in the NE and 160 acres in the SW of Section 21, T1N, R19ECM, Texas County. The water is to be withdrawn from one (1) well in the NE SW NE of Section 21, T1N, R19ECM, Texas County, and use the groundwater in Texas County, Oklahoma, as more specifically described in the application, viewable at oklahoma.gov/owrb. Wells and dedicated lands are located over the Ogallala Panhandle groundwater basin. Board rules require that the well be located a distance of at least 1,320 feet from existing wells or proposed well locations on lands of another unless a well location exception is granted. Use of groundwater is governed by Sections 1020.1 and following Title 82 of the Oklahoma Statutes and rules of the Board, Oklahoma Administrative Code, Title 785, Chapters 4 and 30.

Protests to the application must be in writing and received by the Board at the address listed below and by the applicant at the address listed above no later than February 23, 2026, and contain the following: (1) name, address, and telephone number of the interested person; (2) the particular application number to which the protest relates; (3) specific information to show how approval of the application proposed may directly and adversely affect legally protected interests of the person filing the protest; and (4) a statement of the relief sought by the interested person. A person who sends a letter containing only a general objection or comment will not be deemed to be a party, but the letter will be made part of the permanent record.

If a protest that meets the requirements listed in the paragraph above is filed with both the applicant and Board, a hearing on this application will be scheduled and the applicant and protestant(s) will be advised of the hearing date. Protestants or their representatives must appear at the hearing and present the protest to be considered. Hearings are governed by Section 309 of Title 75 and Section 1020.8 of Title 82 of the Oklahoma Statutes, and the rules of Board, OAC Title 785, chapters 4 and 30. If you have any questions, please contact Sharon Robinson at (405) 530-8800. Board mailing address: Oklahoma Water Resources Board, Water Rights Administration Division, 3800 N. Classen Blvd., Oklahoma City, OK 73118-2881. Board fax number: (405) 530-8900.

SEP 13 2024

**APPLICATION FOR A
LONG-TERM GROUNDWATER
USE PERMIT**

OKLAHOMA WATER RESOURCES BOARD
WATER RIGHTS ADMINISTRATION DIVISION
3800 North Classen Blvd., Oklahoma City, OK 73118
Phone: (405) 530-8800 Fax: (405) 530-8900
www.oklahoma.gov/owrb (see website for FAQs)

OKLAHOMA WATER RESOURCES BOARD

paid \$700/\$5500 check 536

APPLICATION FILING FEE

Application review will not begin until the proper filing fee is received.
Double the filing fee if water is used before application approval.

Amount of Water Requested	Filing Fee**
1 – 320 acre-feet.....	\$500.00
321 – 640 acre-feet.....	\$700.00 -
641 – 1,500 acre-feet.....	\$900.00
Over 1,500 acre-feet.....	\$900.00*

*Plus \$250.00 for each increment of 500 acre-feet above 1,500 acre-feet requested (Maximum Fee \$4,000.00).
**Plus \$250.00 if the application overlies a sensitive sole-source groundwater basin. Applications for the purpose of enhanced recovery of oil and gas shall have a flat filing fee of \$4,500.00. If the requested amount of water is fractional, round up to the next whole number for the purposes of determining the filing fee.

OFFICE USE ONLY

Application No. 2024-635
Type of Permit Regular
Groundwater Basin Ogallala Panhandle
Equal Proportionate Share 2

1. NAME & ADDRESS (Print the applicant name exactly as listed on the ownership documentation and fill in the contact information.)

Applicant Name Owen & Delynne Creason Phone (806) 202-3251

Mailing Address 123083 EW 25 Rd City Balko State OK Zip 73931

Email Orcreason@gmail.com Fax () -

Contact Name (during application review) Chuck Madsen Phone (580) 527-1600

Mailing Address PO Box 784 City Beaver State OK Zip 73932

Email chuckmadsen34@gmail.com Fax () -

If correspondence needs to be sent during application review, it should be sent as: Postal Mail Email Fax

Contact Name (after permit approval) Owen Creason Phone (806) 202-3251

Mailing Address 123083 EW 25 Rd City Balko State OK Zip 73931

Email Orcreason@gmail.com Fax () -

2. QUANTITY OF WATER & PURPOSE (List the purposes for which the water will be used and the total number of acre-feet per year. Note: One acre-foot of water will cover one acre of land one foot deep and is equal to 325,851 gallons. Common purposes include irrigation, agriculture (greenhouses, animal farms), oil & gas, public water supply, commercial, industrial, power generation, and recreation, fish, & wildlife.)

Groundwater requested: 640 acre-feet per year. Water used in Texas county.

Purposes: Irrigation

For Growing Crops: Proposed crops: Wheat & Grass Hay

Approximate area of crops irrigated: 320 acres. If the applicant will use water (or sell water to an end user) to grow marijuana or hemp attach a copy of all associated user's OMMA or ODAFF licenses.

RECEIVED

SEP 13 2024

OKLAHOMA WATER RESOURCES BOARD

3. OWNERSHIP & LEGAL DESCRIPTION OF LAND DEDICATED

(List the legal description of all the land to be dedicated. Do not use city lot and block numbers or metes and bounds. If additional space is needed, list on a separate sheet of paper. An explanation of legal descriptions can be found on the OWRB website FAQs page. Dedicated land must be drawn on the application plats.)

320 acres owned; _____ acres leased; _____ acres platted (municipal only) and dedicated to the application.

160 acres in 1/4 of 1/4 of NE 1/4 of Section 21 Twp. 1 N S Rng. 19 EIM WIM in Texas County ECM

160 acres in 1/4 of 1/4 of SW 1/4 of Section 21 Twp. 1 N S Rng. 19 EIM WIM in Texas County ECM

_____ acres in 1/4 of 1/4 of 1/4 of Section _____ Twp. _____ N S Rng. _____ EIM WIM in _____ County ECM

_____ acres in 1/4 of 1/4 of 1/4 of Section _____ Twp. _____ N S Rng. _____ EIM WIM in _____ County ECM

4. WELL INFORMATION (Please specify the number of wells requested for permitted use. For existing wells, write the 10-acre tract legal description where each well is located. For wells that have not been drilled, please describe the proposed well area where the wells may be drilled. If additional space is needed, list on a separate sheet of paper.)

Are there existing wells on land owned by others that are within applicable well spacing of the wells requested on the application? Spacing restrictions are 660 feet in alluvium & terrace and 1,320 feet in bedrock groundwater basins (not all groundwater basins have well spacing). If there is, an exception may be required. Yes No

Water is to be withdrawn from _____ total well(s) located in (All well locations must be drawn on the attached plat.):

1 wells in NE 1/4 of SW 1/4 of NE 1/4 of Section 21 Twp. 1 N S Rng. 19 EIM WIM in Texas County Existing Well? No

_____ wells in 1/4 of 1/4 of 1/4 of Section _____ Twp. _____ N S Rng. _____ EIM WIM in _____ County Existing Well? No

_____ wells in 1/4 of 1/4 of 1/4 of Section _____ Twp. _____ N S Rng. _____ EIM WIM in _____ County Existing Well? No

For Existing Wells (Please specify the depth and yield of the wells requested for permitted use. If multiple wells are requested, provide a range of values (e.g. 400 - 500 feet).)

Depth: _____ feet; Pumping Rate: _____ gallons per minute

5. MUNICIPALITIES (Only municipalities are required to complete this section. If platted lands are dedicated, please provide a map of the service area and water lines.)

If platted lands are dedicated within the municipal boundaries:

Will the municipality make water available to the platted lands area? Yes No

OFFICE USE ONLY SIC Codes table with grid and values 01, 0100

RECEIVED

OCT 30 2025

6. PLAT MAP Follow the instructions on the preceding page unless otherwise directed by the Board. Drawings must match the legal description of dedicated land and wells described in Section 3 and 4 of the application. More than one plat map may be required.

Application No. 2024-635

OKLAHOMA WATER RESOURCES BOARD

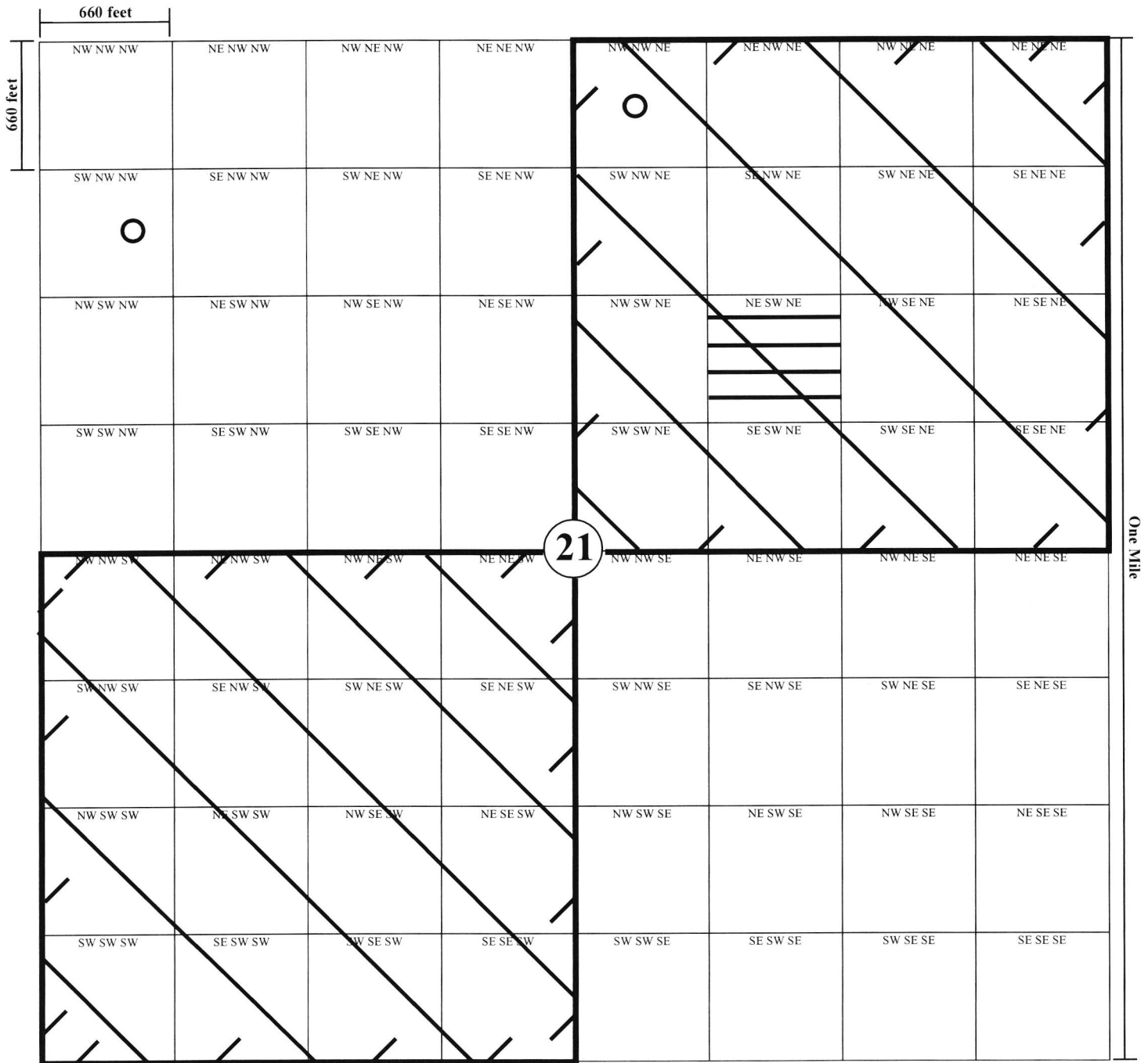

21 - 1N - 19ECM

Section - Township - Range

Texas

County

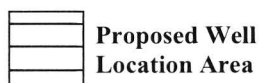
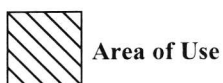
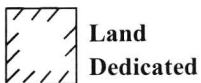

● Existing Wells to be Permitted

○ Existing Wells Owned by Others (i.e. domestic, stock, permitted, etc.)



RECEIVED

SEP 13 2024

OKLAHOMA WATER RESOURCES BOARD

8. SIGNATURES

Upon my oath or affirmation, I swear or affirm (1) that all information submitted to the Oklahoma Water Resources Board in connection with this application is true and accurate to the best of my knowledge; and (2) that I or the person or entity I represent will comply with all applicable laws and regulations of the State of Oklahoma or its agencies, and any lawful conditions imposed by the Oklahoma Water Resources Board, which apply or pertain to the use of fresh groundwater.

[Signature]
SIGNATURE OF APPLICANT
OWEN CREASON
PRINT NAME

TITLE (IF APPLICABLE)

OKLAHOMA BAR ASSOCIATION NUMBER
(IF APPLICABLE)

NOTARY

STATE OF Oklahoma)
COUNTY OF Beaver) ss.

The foregoing instrument was acknowledged before
me this 7th day of August, 2024.

[Signature]
Notary Public Signature

My commission expires: March 14, 2026



9. APPLICATION SUBMISSION AND PROCESSING

The submitted application packet must include the following:

- a. The original completed application, typed or printed in ink, signed and notarized (*All markings must be legible.*);
- b. The appropriate filing fee (*Application review will not begin until the proper filing fees are received. If water is used before application approval, double the filing fee will be required. Filing fees will not be refunded unless an overpayment was made by the applicant.*);
- c. Copies of warranty deeds, leases, and/or letters of consent as required (*Tax documents are not accepted. Social security numbers are not required. If any documentation contains social security numbers, please obscure them before submittal.*).
- d. Other documentation may be requested as needed to complete the application review.

Please note: Any incomplete or unresponsive answers may cause a delay in the processing of your application.

In addition, Oklahoma Administrative Code (OAC) 785:30-1-4(d) states: "If the application is defective to as to form, the Board shall advise the applicant of the corrections, amendments, or changes required and sixty (60) days shall be allowed for the refilling thereof. If the application is not corrected, amended, or changed within the time required, the Board may inactivate the application. Furthermore, OAC 785:30-3-3(b), states: "If an applicant does not correct an application or publish notice as instructed by the Board, and no further proceedings are initiated by the applicant for six months or more after last contact with the Board, the application shall be deemed withdrawn. The Board shall provide notice to the applicant that the application has been deemed withdrawn.

RECEIVED

OCT 30 2025

OKLAHOMA WATER RESOURCES BOARD

I authorize the Oklahoma Water Resources Board (OWRB) to make the following revisions to the Groundwater Application #2024-635:

1. Change the land dedicated to:
160 acres in the NE of Section 21 1N 19ECM in Texas County
160 acres in the SW of Section 21 1N 19ECM in Texas County
2. Change the legal description of the proposed well to:
1 well in the NE SW NE of Section 21 1N 19ECM in Texas County
3. The revised plat map will replace the originals.
4. The revised surface estate owners map will replace the original.



Signature

10-19-2025

Date