

OKLAHOMA

Water Resources Board

May 21, 2026

FD Guymon Farms, LLC
Attn: Sabrina Leven
PO Box 2081
Dumas, TX 79029

RE: Amend Regular Groundwater Permit No. 1984-513A, FD Guymon Farms, LLC, Texas County

Dear Ms. Leven:

Your groundwater application to amend existing permit number 1984-513A has been reviewed by Board staff. In order to complete the amendment process, you must provide notice of the essential facts about your intended use by newspaper publication and by notifying certain neighbors.

In accordance with Section 309 of Title 75 and Section 1020.8 of Title 82 of the Oklahoma Statutes, and Section 785:30-3-4 of the Oklahoma Administrative Code (OAC), we have enclosed a Notice of Application to be published at your expense in a newspaper that is qualified to publish legal notices in Texas County. The notice must be published once a week for the two consecutive weeks beginning on June 14, 2026, and June 21, 2026. Please send us, or have the publisher forward to us, the certified proofs of publication by July 13, 2026. Because the Board is not responsible for the accuracy of the information contained in the notice, please review the enclosed notice carefully and contact the Board if you note any errors or have any questions regarding notice.

In addition to giving notice by publication of your application to withdraw groundwater, OAC Section 785-30-3-4 requires that you notify by certified mail, return receipt requested, all surface estate owners of lands located within 1,320 feet of the outside boundary of each ten acre tract of wells subject of your application. Please notify these landowners on or before the first day of publication. We have enclosed extra copies of the notice for this purpose. You may make additional copies if you need more than we have provided. Also enclosed is an affidavit certifying that you have notified all of these surface estate owners. The affidavit must be signed, notarized and returned to the Board, along with all green cards, by or before July 13, 2026.

Any protests to your application must be filed with the Board by July 20, 2026. If a protest is filed, a hearing will be scheduled and you will be notified.

If you have any questions concerning this matter, please contact Sharon Robinson at the address below or call (405) 530-8800.

Sincerely,

Chris Neel, Division Chief
Water Rights Administration Division

AFFIDAVIT OF NOTIFICATION

I hereby certify that I, Sabrina Leven, on behalf of FD Guymon Farms, LLC have notified all surface estate owners of lands located within 1,320 feet of the outside boundary of each ten-acre tract of the wells subject of application number 1984-513A, of their intention to use groundwater by forwarding the notice of application by U.S. Mail, certified mail return receipt requested, on _____ (Date Mailed) to the following:

(List of names and addresses should correspond to those listed on the Ownership Plat attached to the application. Please attach separate page if more space is needed. PLEASE ATTACH ALL GREEN CARDS TO AFFIDAVIT.)

NAME

ADDRESS

Applicant's Signature

Subscribed and sworn to before me this
_____ date of _____, 20_____.

Notary Public Signature

[seal]

My Commission Expires

NOTE TO PUBLISHER: To be published in Texas County once during the week of June 14, 2026 but no later than June 20, 2026, and once during the week of June 21, 2026 but no later than June 27, 2026, AT APPLICANT'S EXPENSE. (PUBLISHER NEEDS TO FURNISH THE OKLAHOMA WATER RESOURCES BOARD A CERTIFIED PROOF OF PUBLICATION ON OR BEFORE July 13, 2026.

**NOTICE OF APPLICATION TO AMEND EXISTING PERMIT TO USE
GROUNDWATER**

PERMIT NUMBER 1984-513A

Notice is hereby given that FD Guymon Farms, LLC c/o Sabrina Leven, PO Box 2081, Dumas, TX 79029, under the authority given in Oklahoma State Law, Title 82 §1020.7, has filed an application with the Oklahoma Water Resources Board, pursuant to Board rules, to amend groundwater permit #1984-513A to withdraw and use an additional 544.64 acre-feet of groundwater for a total of 960.64 acre-feet of groundwater per calendar year for the purpose of irrigation (corn, cotton, and milo). An additional 160.32 acres have been dedicated to this application and are in the NW of Section 17, T5N, R14ECM, Texas County. This will bring the total land dedicated to the permit to 480.32 acres. Further, the application request includes adding one (1) well in the NE SE SW of Section 8, T5N, R14ECM, Texas County. This will bring the total number of wells for this permit to two (2). All other aspects of the permit remain the same, viewable at oklahoma.gov/owrb. Wells and dedicated lands are located over the Ogallala Panhandle groundwater basin. Board rules require that the well be located a distance of at least 1,320 feet from existing wells or proposed well locations on lands of another unless a well location exception is granted. Use of groundwater is governed by Sections 1020.1 and following Title 82 of the Oklahoma Statutes and rules of the Board, Oklahoma Administrative Code, Title 785, Chapters 4 and 30.

Protests to the application must be in writing and received by the Board at the address listed below and by the applicant at the address listed above no later than July 20, 2026, and contain the following: (1) name, address, and telephone number of the interested person; (2) the particular application number to which the protest relates; (3) specific information to show how approval of the application proposed may directly and adversely affect legally protected interests of the person filing the protest; and (4) a statement of the relief sought by the interested person. A person who sends a letter containing only a general objection or comment will not be deemed to be a party, but the letter will be made part of the permanent record.

A hearing on this application will be scheduled and the applicant and protestant(s) shall be advised of the hearing date upon receipt of a proper protest. Protesting parties or their representatives must appear at the hearing and present the protest in order that it may be considered. Hearings are governed by Section 309 of Title 75 and Section 1020.8 of the Title 82 of the Oklahoma Statutes, and the rules of the Board, OAC Title 785, Chapters 4 and 30. If you have any questions, please contact Sharon Robinson at (405) 530-8800. Board mailing address: Oklahoma Water Resources Board, Water Rights Administration Division, 3800 N. Classen Blvd., Oklahoma City, OK 73118-2881. Board fax number: (405) 530-8900.

NOTICE PROVIDED VIA CERTIFIED MAIL

**NOTICE OF APPLICATION TO AMEND EXISTING PERMIT TO USE
GROUNDWATER**

PERMIT NUMBER 1984-513A

Notice is hereby given that FD Guymon Farms, LLC c/o Sabrina Leven, PO Box 2081, Dumas, TX 79029, under the authority given in Oklahoma State Law, Title 82 §1020.7, has filed an application with the Oklahoma Water Resources Board, pursuant to Board rules, to amend groundwater permit #1984-513A to withdraw and use an additional 544.64 acre-feet of groundwater for a total of 960.64 acre-feet of groundwater per calendar year for the purpose of irrigation (corn, cotton, and milo). An additional 160.32 acres have been dedicated to this application and are in the NW of Section 17, T5N, R14ECM, Texas County. This will bring the total land dedicated to the permit to 480.32 acres. Further, the application request includes adding one (1) well in the NE SE SW of Section 8, T5N, R14ECM, Texas County. This will bring the total number of wells for this permit to two (2). All other aspects of the permit remain the same, viewable at oklahoma.gov/owrb. Wells and dedicated lands are located over the Ogallala Panhandle groundwater basin. Board rules require that the well be located a distance of at least 1,320 feet from existing wells or proposed well locations on lands of another unless a well location exception is granted. Use of groundwater is governed by Sections 1020.1 and following Title 82 of the Oklahoma Statutes and rules of the Board, Oklahoma Administrative Code, Title 785, Chapters 4 and 30.

Protests to the application must be in writing and received by the Board at the address listed below and by the applicant at the address listed above no later than July 20, 2026, and contain the following: (1) name, address, and telephone number of the interested person; (2) the particular application number to which the protest relates; (3) specific information to show how approval of the application proposed may directly and adversely affect legally protected interests of the person filing the protest; and (4) a statement of the relief sought by the interested person. A person who sends a letter containing only a general objection or comment will not be deemed to be a party, but the letter will be made part of the permanent record.

A hearing on this application will be scheduled and the applicant and protestant(s) shall be advised of the hearing date upon receipt of a proper protest. Protesting parties or their representatives must appear at the hearing and present the protest in order that it may be considered. Hearings are governed by Section 309 of Title 75 and Section 1020.8 of the Title 82 of the Oklahoma Statutes, and the rules of the Board, OAC Title 785, Chapters 4 and 30. If you have any questions, please contact Sharon Robinson at (405) 530-8800. Board mailing address: Oklahoma Water Resources Board, Water Rights Administration Division, 3800 N. Classen Blvd., Oklahoma City, OK 73118-2881. Board fax number: (405) 530-8900.

RECEIVED

MAR 13 2026

MAR 13 2026

Ad
9006w
OWRB

APPLICATION FOR AN AMENDMENT TO A GROUNDWATER PERMIT OR PRIOR RIGHT

OKLAHOMA WATER RESOURCES BOARD

OKLAHOMA WATER RESOURCES BOARD

OKLAHOMA WATER RESOURCES BOARD
WATER RIGHTS ADMINISTRATION DIVISION
3800 North Classen Blvd., Oklahoma City, OK 73118
Phone: (405) 530-8800 Fax: (405) 530-8900
Website: <https://oklahoma.gov/owrb.html>
(See website for FAQs)

FILING FEE

Application review will not begin until the proper filing fee is received. Double the filing fee if water is used before application approval. If the requested amount of water is fractional, round up to the next whole number for the purposes of determining the filing fee.

Not Adding Water	Filing Fee**
Public Notice Not Required.....	\$200.00
Public Notice Required.....	\$400.00

(See Page 3 for an explanation.)

If adding water, replace the fee schedule above with the one below, which is based on the amount of water requested:

Adding Water	Filing Fee**
1 - 320 acre-feet.....	\$400.00
321 - 640 acre-feet.....	\$750.00
641 - 1,500 acre-feet.....	\$900.00
Over 1,500 acre-feet.....	\$900.00*

*Plus \$250.00 for each increment of 500 acre-feet above 1,500 acre-feet requested (Maximum Fee \$4,000.00).
**Plus \$250.00 if the application overlies a sensitive sole-source groundwater basin. Applications for the purpose of enhanced recovery of oil and gas shall have a flat filing fee of \$4,500.00.

OFFICE USE ONLY

Permit No. 19840513A
Permit Type Regular
GW Basin Ogallala-Panhandle
Equal Proportionate Share 2

1. NAME & CONTACT INFORMATION Print the applicant's name to exactly match what is listed on the ownership document. Consultants and legal counsel should provide a cover letter with contact information and state if they will remain the contact after permit approval.

Applicant Name FD GUYMON FARMS LLC Phone () -

Mailing Address 1717 W SIXTH STREET SUITE 370 City AUSTIN State TX Zip 78703

Email _____ Fax () -

Contact Name (if different than applicant) SABRINA LEVEN Phone (806) 2311468 -

Mailing Address PO BOX 2081 City DUMAS State TX Zip 79029

Email Steven@rnaagllc.com Fax () -

How should correspondence be sent during application review? Check all that apply: Postal Mail Email Fax

2. TYPE OF AMENDMENT Write the permit number and check each type of change to be made to the permit. The amount of water cannot be increased and dedicated land cannot be added to a prior right. If land ownership has changed since the permit was originally approved, then a Petition to Transfer Ownership will be required before an amendment can proceed. Forms are found on the OWRB's website.

Groundwater Permit or Prior Right # 1984-513A

Identify the parts of the permit to be changed:

- Water (complete Sections 3, 8, 9, and 10)
- Purposes (complete Sections 3, 8, 9, and 10)
- Dedicated Land (complete Sections 4, 5, 7, 8, 9, and 10)
- Wells (complete Sections 6, 7, 8, 9, and 10)
- Area of Use (complete Sections 7, 9, and 10)

OFFICE USE ONLY

SIC Codes

01 | 0100

3. QUANTITY OF WATER & PURPOSE Fill out only those parts that apply.
 Specify the amount of water and purposes that will be changing. Choose purposes (i.e. beneficial use), from the following list: Irrigation, Agriculture, Mining, Public Water Supply, Commercial, Industrial, Power Generation, Recreation Fish & Wildlife, and Other. A description can be helpful and may be required to complete application review. Conversion factor: one acre-foot of water will cover one acre of land one foot deep and is equal to 325,851 gallons.

RECEIVED
 MAR 13 2026
 OKLAHOMA WATER RESOURCES BOARD

Groundwater: Add Remove 544.64 acre-feet per year. Water used in TEXAS county.

Purpose: Add Remove _____
 (e.g. Agriculture – Poultry Houses or Greenhouse; Mining – Oil & Gas or Rock Quarry)

Assign a quantity of water to each purpose? Yes No _____
 (e.g. 100 acre-feet to irrigation and 100 acre-feet to oil & gas)

Have you already used the water for which you are applying? Yes No *If yes, double the filing fee will be required.*

Will water be sold? Yes No If yes, list the purchaser: _____
 (not required for public water suppliers)

Will animals be raised? Yes No If yes, list: _____
 (not required for domestic use of stock water)

Will crops be grown? Yes No If yes, approximate area of watered crops: 240 and;
 (use units of acres for fields or square feet for indoor)

List of crops: POSSIBLY CORN, COTTON, OR MILO

4. DEDICATED LAND List the legal description of all dedicated land to be added to the existing permit. Do not use city lot and block numbers or metes and bounds. If additional space is needed, list on a separate sheet of paper. An explanation of legal descriptions can be found on the OWRB website FAQs page. Dedicated land must be drawn on the attached plat map.

160.32 total acres owned; _____ total acres leased; _____ total acres platted (municipal only)

_____ acres in _____ 1/4 of _____ 1/4 of _____ 1/4 of Section _____ Twp. _____	<input type="radio"/> N <input type="radio"/> S Rng. _____	<input type="radio"/> EIM <input type="radio"/> OWIM in _____ <input type="radio"/> ECM County
_____ acres in _____ 1/4 of _____ 1/4 of _____ 1/4 of Section _____ Twp. _____	<input type="radio"/> N <input type="radio"/> S Rng. _____	<input type="radio"/> EIM <input type="radio"/> OWIM in _____ <input type="radio"/> ECM County
<u>160.32</u> acres in _____ 1/4 of _____ 1/4 of <u>NW</u> 1/4 of Section <u>17</u> Twp. <u>5</u>	<input checked="" type="radio"/> N <input type="radio"/> S Rng. <u>14</u>	<input type="radio"/> EIM <input type="radio"/> OWIM in <u>TEXAS</u> <input checked="" type="radio"/> ECM County
_____ acres in _____ 1/4 of _____ 1/4 of _____ 1/4 of Section _____ Twp. _____	<input type="radio"/> N <input type="radio"/> S Rng. _____	<input type="radio"/> EIM <input type="radio"/> OWIM in _____ <input type="radio"/> ECM County
_____ acres in _____ 1/4 of _____ 1/4 of _____ 1/4 of Section _____ Twp. _____	<input type="radio"/> N <input type="radio"/> S Rng. _____	<input type="radio"/> EIM <input type="radio"/> OWIM in _____ <input type="radio"/> ECM County

5. MUNICIPALITIES Only municipalities are required to complete this section. All other applicants can skip this section. Answer the questions and provide copies of the requested maps.

Will platted land be dedicated within the municipal boundary? Yes No

If yes, will the municipality make water available to those platted lands? Yes No

If yes, provide attached map(s) that show the following: service area, water lines, and platted lands.

6. WELL INFORMATION List the number and legal description for all wells (either existing or proposed) to be added or deleted from the permit. Existing wells require a ten acre tract legal description. Depth and pumping rate are required for all existing wells and a range of values (e.g. 400 – 500 feet) can be provided for multiple existing wells. Estimated depth and pumping rate may be required for proposed wells in areas with multiple groundwater basins. Provide an answer to the well spacing exception question. If additional space is needed, list on a separate sheet of paper. An explanation of legal descriptions can be found on the OWRB website FAQs page. All wells must be drawn on the application plat map.

RECEIVED

MAR 13 2026

OKLAHOMA WATER RESOURCES BOARD

Wells to be added:

1 wells in NE 1/4 of SE 1/4 of SW 1/4 of Section 8 Twp. 5 N S Rng. 14 EIM WIM in TEXAS Existing Yes No
 ECM County Well? No

_____ wells in _____ 1/4 of _____ 1/4 of _____ 1/4 of Section _____ Twp. _____ N S Rng. _____ EIM WIM in _____ Existing Yes No
 ECM County Well? No

_____ wells in _____ 1/4 of _____ 1/4 of _____ 1/4 of Section _____ Twp. _____ N S Rng. _____ EIM WIM in _____ Existing Yes No
 ECM County Well? No

Depth: _____ feet; Pumping Rate: _____ gallons per minute

Requesting a well spacing exception? Yes No I don't know. Blank responses will not be accepted. If yes, you may choose to provide an attached explanation to show how compliance with well spacing would be inequitable or unreasonable. Examples can be found in OAC 785:30-3-6(b)(1). A well spacing exception may be required based on application review.

Wells to be deleted:

_____ wells in _____ 1/4 of _____ 1/4 of _____ 1/4 of Section _____ Twp. _____ N S Rng. _____ EIM WIM in _____ Existing Yes No
 ECM County Well? No

_____ wells in _____ 1/4 of _____ 1/4 of _____ 1/4 of Section _____ Twp. _____ N S Rng. _____ EIM WIM in _____ Existing Yes No
 ECM County Well? No

EXPLANATION IF PUBLIC NOTICE IS REQUIRED -

Public notice is not required with an amendment when the applicant is only requesting additional wells and those wells meet one of the following conditions:

- Groundwater basin with well spacing restriction** - The applicant has done a diligent search and found no other wells within applicable spacing of the wells to be added (660 feet for alluvium and terrace or 1,320 feet for bedrock).
- Groundwater basin without well spacing restriction** - The applicant either owns all the land within 1,320 feet (1/4 mile) of the wells to be added or has written permission from each surrounding surface estate owner within 1,320 feet.

Public notice is required for all amendments that do not meet the above requirements.

<u>OFFICE USE ONLY</u>	
Uses: <u>Irrigation</u>	<u>416+544.64=960.64</u> ac. ft. Acres Dedicated: <u>320 + 160.32=480.32</u>
_____ ac. ft.	Acres Irrigated: _____
_____ ac. ft.	Number of Wells: <u>1+ 1=2 wells</u>

RECEIVED

MAR 13 2026

OKLAHOMA WATER RESOURCES BOARD

7. **PLAT MAP** Follow the instructions on the preceding page unless otherwise directed by the Board. Drawings must match the legal description of dedicated land and wells described in Section 4 and 6 of the application. If adding or replacing wells, please show all wells currently authorized on the permit and the wells to be replaced. More than one plat map may be required.

Permit No. 1984-513A

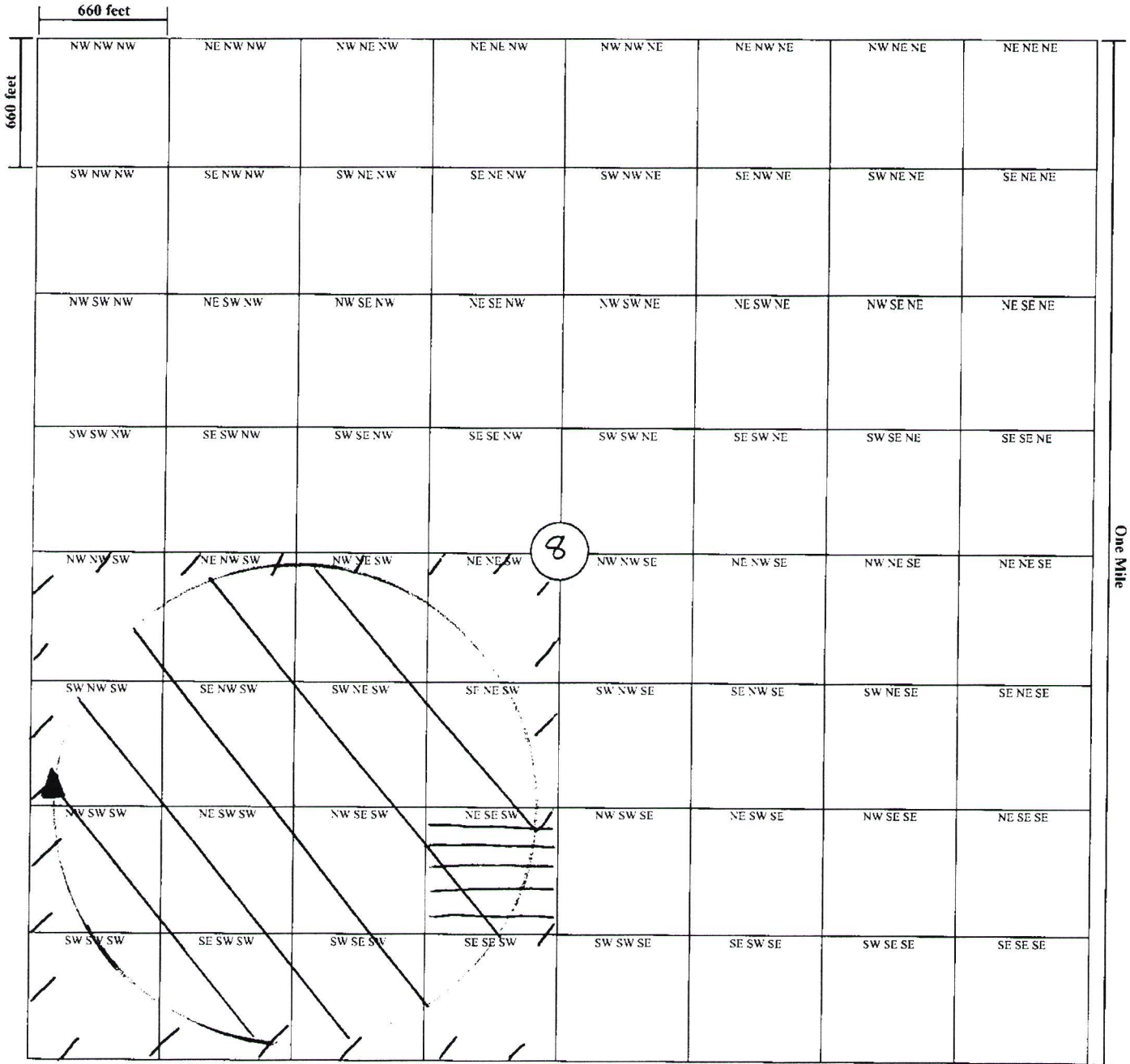

8-T5N-R14ECM

TEXAS

Section - Township - Range

County



Land Dedicated



Area of Use



Proposed Well Location Area

● Existing Wells to Add to the Permit

▲ Existing Wells on the Permit

○ Existing Wells Owned by Others (i.e. domestic, stock, permitted, etc.)

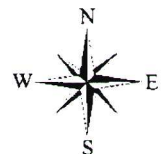

RECEIVED

MAR 13 2026

OKLAHOMA WATER RESOURCES BOARD

7. **PLAT MAP** Follow the instructions on the preceding page unless otherwise directed by the Board. Drawings must match the legal description of dedicated land and wells described in Section 4 and 6 of the application. If adding or replacing wells, please show all wells currently authorized on the permit and the wells to be replaced. More than one plat map may be required.

Permit No. 1984-513A

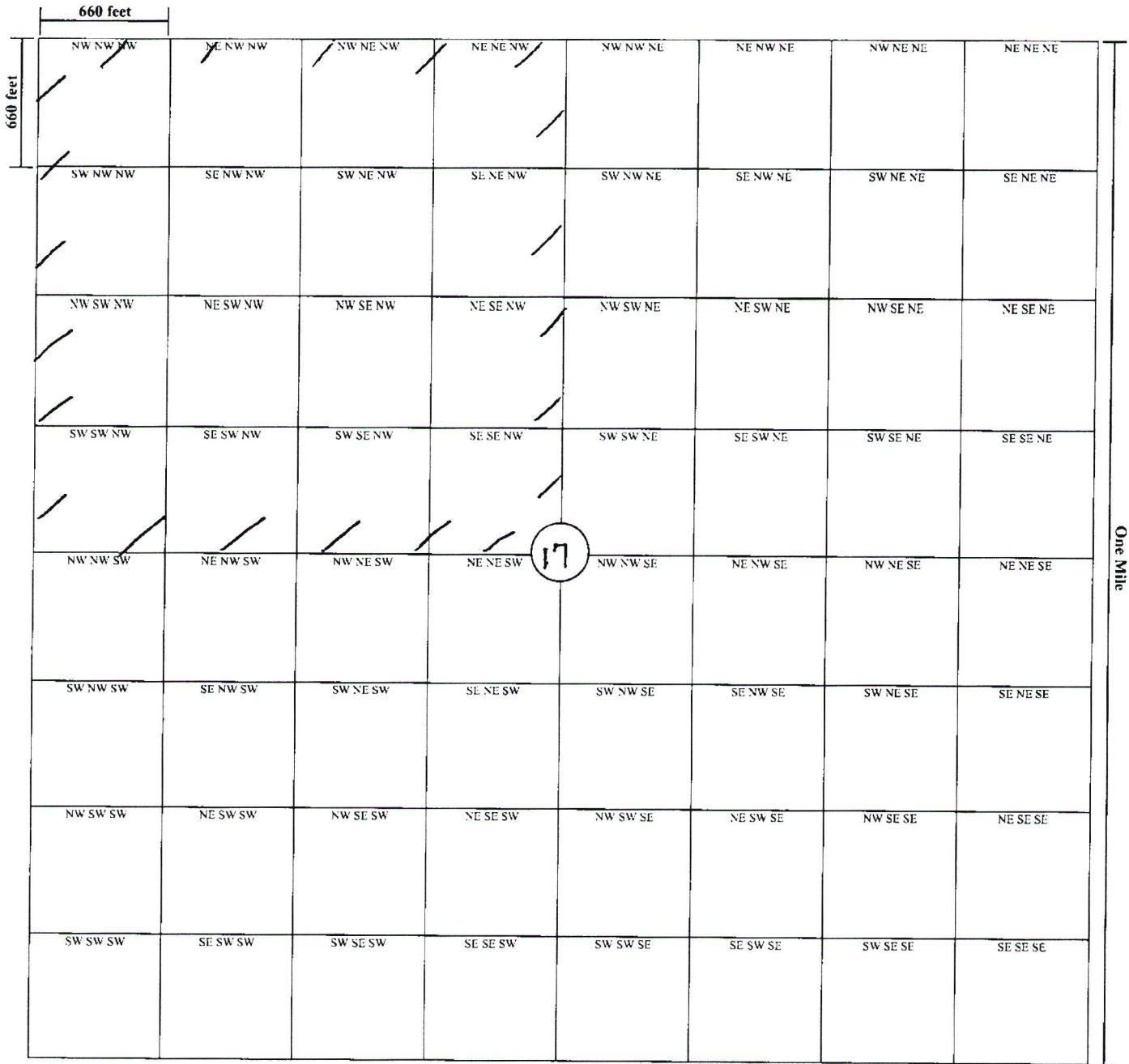

17-T5N-R14ECM

TEXAS

Section - Township - Range

County



Land Dedicated



Area of Use



Proposed Well Location Area

● Existing Wells to Add to the Permit

▲ Existing Wells on the Permit

○ Existing Wells Owned by Others (i.e. domestic, stock, permitted, etc.)

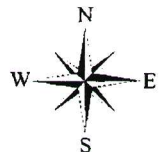

9. SIGNATURES

Upon my oath or affirmation, I swear or affirm (1) that all information submitted to the Oklahoma Water Resources Board in connection with this application is true and accurate to the best of my knowledge; and (2) that I or the person or entity I represent will comply with all applicable laws and regulations of the State of Oklahoma or its agencies, and any lawful conditions imposed by the Oklahoma Water Resources Board, which apply or pertain to the use of fresh groundwater.

RECEIVED

MAR 13 2026

OKLAHOMA WATER RESOURCES BOARD

Sabrina Leven
SIGNATURE OF APPLICANT

SABRINA LEVEN - AGENT
PRINTED NAME

TITLE (e.g. owner, manager, trustee, legal counsel, etc.)

OKLAHOMA BAR ASSOCIATION NUMBER
(IF APPLICABLE)

NOTARY

STATE OF TEXAS)
COUNTY OF MOORE) ss.

The foregoing instrument was acknowledged before me this 13 day of March, 2026.

Nicole Mae Spencer
Notary Public Signature

My commission expires: 6/12/2029

(SEAL)

10. SUBMISSION AND PROCESSING

The submitted application packet must include the following:

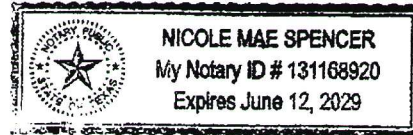

a. Original completed application (Typed or printed in ink, with legible markings, signed and notarized.);

b. Filing fee payment (Review of the application will not begin until the filing fee is received. Filing fees are refunded at the discretion of the OWRB. Preferred payment method is a check payable to the OWRB. Other payment methods include cash, money order, or credit card via the OWRB Website Pay Portal – please provide a copy of the Pay Portal receipt. If water is used before application approval, double the filing fee will be required.);

c. Ownership documents (Copies of deeds, groundwater leases, easements, and/or other letters of consent for all the land owned/controlled by the applicant associated with the application. Tax documents are not accepted. Social security numbers are not required and should be marked out on documents that contain them.)

d. Any other documentation requested by OWRB staff as necessary (Articles of organization or incorporation, memorandum of trust, license or registration from OMMA or ODAFF, contract for water sales, etc.).

Please note: Any incomplete or unresponsive answers may cause a delay in the processing of your application.

In addition, Oklahoma Administrative Code (OAC) 785:30-1-4(d) states: "If the application is defective to as to form, the Board shall advise the applicant of the corrections, amendments, or changes required and sixty (60) days shall be allowed for the refilling thereof. If the application is not corrected, amended, or changed within the time required, the Board may inactivate the application. Furthermore, OAC 785:30-3-3(b), states: "If an applicant does not correct an application or publish notice as instructed by the Board, and no further proceedings are initiated by the applicant for six months or more after last contact with the Board, the application shall be deemed withdrawn. The Board shall provide notice to the applicant that the application has been deemed withdrawn.

To: Oklahoma Water Resources Board
3800 N. Classen Boulevard
Oklahoma City, OK 73118
ATTN: Jackie Hicks

(405) 530-8922 Phone
(405) 530-8900 Fax

I authorize the Oklahoma Water Resources Board (OWRB) to make the following revisions to the Groundwater Permit Application #19840513A

1. Correct the well description to **Sec.8, Twp.5N, Rng.14ECM**
2. Modify Section 4 to include only 160 acres of the **NW/4 of Sec.17, Twp.5N, Rng.14ECM** as new dedicated land.
3. Draw area of use on the plat map for the **NW/4 of Sec.17, Twp.5N, Rng.14ECM**

Sign: 

Date: 4-16-26

RECEIVED

4/29/2026

OKLAHOMA WATER RESOURCES BOARD

To: Oklahoma Water Resources Board
3800 N. Classen Boulevard
Oklahoma City, OK 73118
ATTN: Jackie Hicks

(405) 530-8922 Phone
(405) 530-8900 Fax

I authorize the Oklahoma Water Resources Board (OWRB) to make the following revisions to the Groundwater Permit Application #19840513A

1. Modify the groundwater requested to 544.64 acre-feet.

Signature: Sabrina Leven

Date: 4-29-26