

UNITED STATES DEPARTMENT OF THE INTERIOR

RINGLING, OKLA.

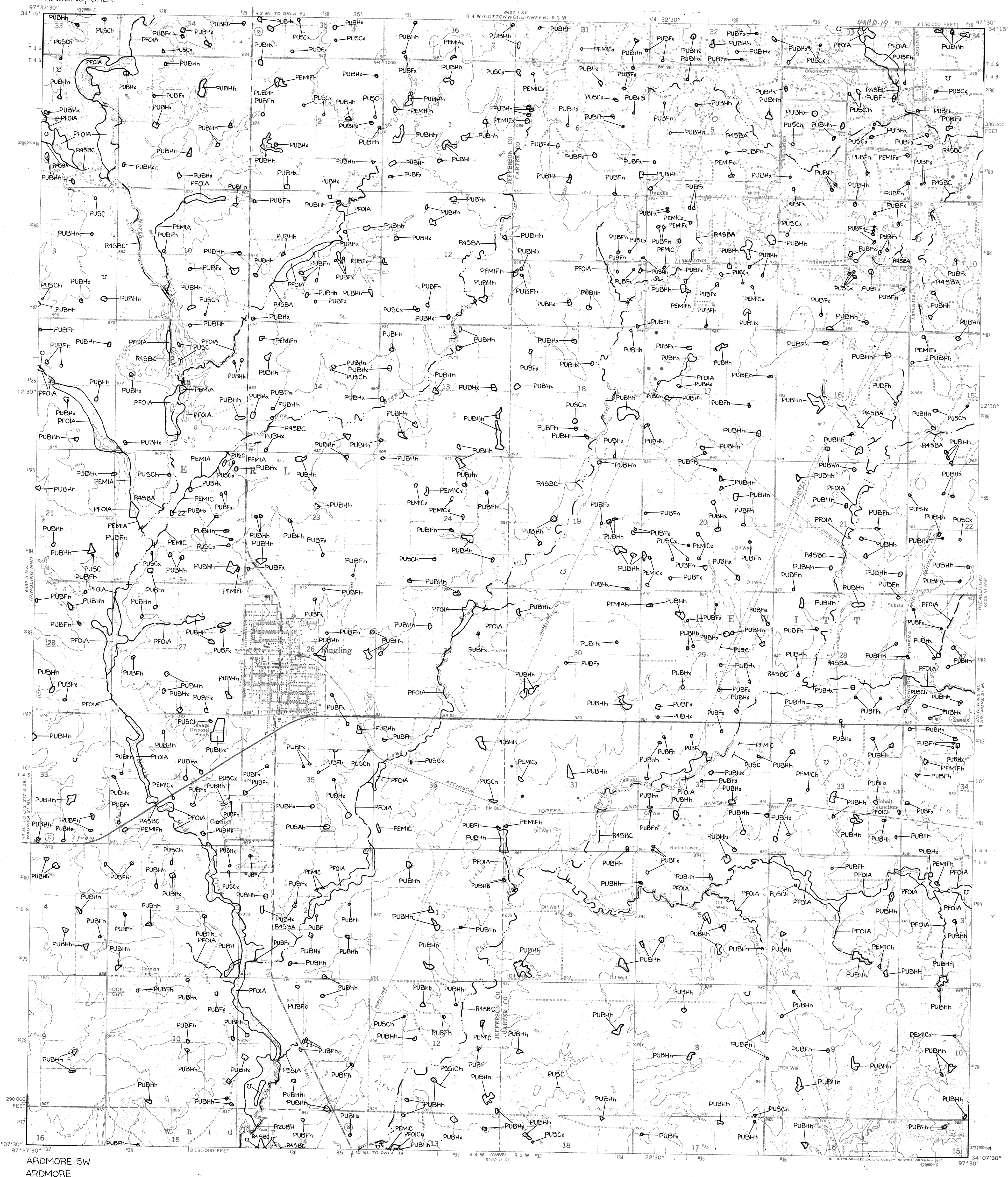

SPECIAL NOTE

SPECIAL NOTE This document was prepared primarily by stereoscopic analysis of aerial oblique altitude aerial photographs. Wetlands were identified on the photographs based on vegetation, visible hydrology, and geography in accordance with Classification of Wetlands and Deepwater Habitats of the United States (FWS/OBS - 79/31 December 1979). The aerial photographs typically reflect conditions during the specific year and season when they were taken. In addition, there is a margin of error inherent in the use of the aerial photographs. Therefore, the analysis of a single site may result in a revision of the wetland boundaries established through photographic interpretation. In addition, some small wetlands and those obscured by dense forest cover may not be included on this document.

Federal, State and local regulatory agencies with jurisdiction over wetlands may define and describe wetlands in a different manner than that used in this inventory. There is no attempt, in either the design or products of this inventory, to define the limits of proprietary jurisdiction of any Federal, State or local government or to establish the geographical scope of the regulatory programs of government agencies. **Persons intending to engage in activities involving modifications within or adjacent to wetland areas should consult with the appropriate Federal, State or local agencies concerning specific agency regulatory programs and proprietary jurisdictions that may affect such activities.**

SYMBOLGY EXAMPLE

The diagram illustrates a nested classification system for wetland types. It features a large, irregular shape representing the 'SYSTEM'. Inside this shape is a smaller, more defined area labeled 'SUBSYSTEM'. Within the subsystem is a specific area labeled 'L2EM2F', which is further identified as 'CLASS'. Below the 'L2EM2F' label, the text 'SUBCLASS, WATER REGIME' is shown. To the right of the 'L2EM2F' area, the text 'UPLAND (NON-WETLAND)' is present. At the bottom of the diagram, a label 'R2OWH' points to a specific area, which is identified as 'LINEAR DEEPPWATER HABITAT'.

NOTES TO THE USER

- Wetlands which have been field examined are indicated on the map by an asterisk (*).
- Additions or corrections to the wetlands information displayed on this map are solicited. Please forward such information to the address indicated.
- Subsystems, Classes, Subclasses, and Water Regimes in *italics* were developed specifically for National WETLANDS INVENTORY mapping.
- Some areas designated as R4SB, R4SBW, OR R4SBJ (INTERMEDIATE STREAMS) may not meet the definition of wetlands.
- This map uses the class Unconsolidated Shore (US). On earlier NWI maps that class was designated Beach/Bar (BB), or Flat (FL). Subclasses remain the same in both versions.

AERIAL PHOTOGRAPHY

DATE: 9/81 DATE:
SCALE: 1:58 000 SCALE:
TYPE: CIR TYPE:

DATE: ____/____/____
SCALE: ____
TYPE: ____

U.S. DEPARTMENT OF THE INTERIOR
FISH AND WILDLIFE SERVICE

Prepared by National Wetlands Inventory

Prepared by National Wetlands Inventory

1989