

NATIONAL WETLANDS INVENTORY
UNITED STATES DEPARTMENT OF THE INTERIOR

MERIDIAN, OKLA.

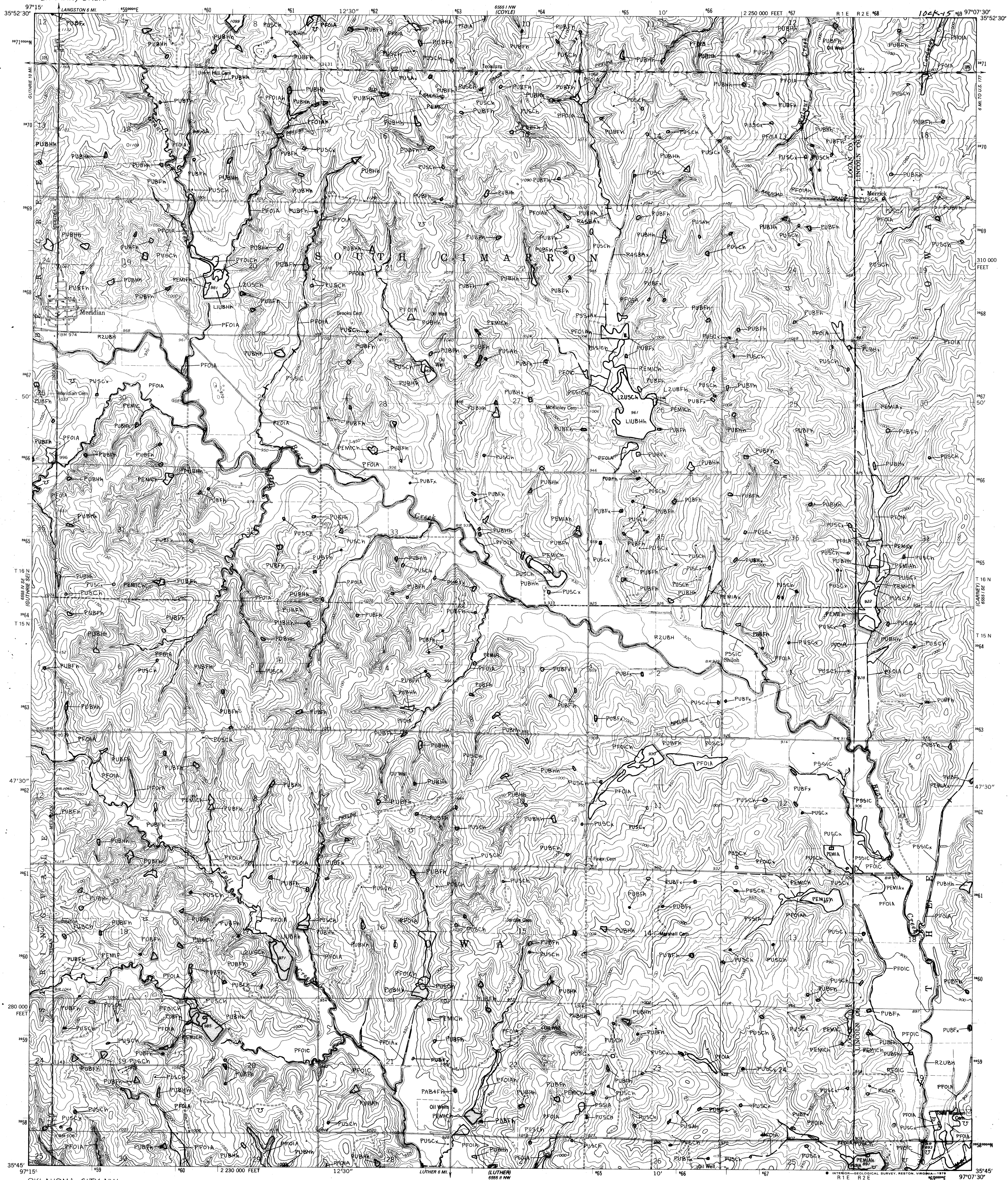

OKLAHOMA CITY NW
OKLAHOMA CITY NORTH



U.S. FISH & WILDLIFE SERVICE
222 S. Houston
Tulsa, OK 74127

MERIDIAN, OKLA.



U.S. DEPARTMENT OF THE INTERIOR
FISH AND WILDLIFE SERVICE

Prepared by National Wetlands Inventory

1989

SPECIAL NOTE

SPECIAL NOTE

This document was prepared primarily by stereoscopic analysis of high altitude aerial photographs. Wetlands were identified from the photographs based on vegetation, soil hydrology, and geography in accordance with Classification of Wetlands and Deepwater Habitats of the United States (FWS/OBS - 79/31 December 1979). The aerial photographs typically reflect conditions during the specific year and season when they were taken. In addition, there is a margin of error inherent in the use of the aerial photographs. Thus, a detailed on the ground and historical analysis of a single site may result in a revision of the wetland classification, although the photographic interpretation. In addition, some small wetlands and/or obscured by dense forest cover may not be included on this document.

Federal, State and local regulatory agencies with jurisdiction over lands may define and describe wetlands in a different manner than that used in this inventory. There is no attempt, in either the design or products of this inventory, to define the limits of proprietary jurisdiction of any Federal, State or local government or to establish the geographical scope of the regulatory programs of government agencies. Persons intending to engage in activities involving modifications within or adjacent to wetland areas should consult the advice of appropriate Federal, State or local agencies concerning specific agency regulatory programs and proprietary jurisdictions that may affect such activities.

SYMBOLOLOGY EXAMPLE

SYSTEM
SUBSYSTEM
CLASS
L2EM2F
SUBCLASS, WATER R...
UPLAND (NON-WETLAND)
σ
R20WH
(LINEAR DEEPWATER HABITAT)

NOTES TO THE USER

- **NOTES TO THE USER**
- Wetlands are indicated on the map by an asterisk (*).
- Additions or corrections to the wetlands information displayed on this map are solicited. Please forward such information to the address indicated.
- Subclasses of Class 1, 2, 3, 4, 5, and Water Regions in *italics* were developed specifically for NATIONAL WETLANDS INVENTORY mapping.
- Some areas designated as R4S8, R4S5W, OR R4SBJ (INTERMITTENT STREAMS) may not meet the definition of wetland.
- This map uses the class Unconsolidated Shore (U).
- On earlier NWI maps that class was designated Beach/Bar (BB), or Flat (FL). Subclasses remain the same in both versions.

AERIAL PHOTOGRAPHY

DATE: 9 / 81 DATE: / /
SCALE: 1:58 000 SCALE: : :
TYPE: CIR TYPE: : :

Other information including a narrative report concerning the wetland resources depicted on this document may be available. For information, contact:

**Regional Director (ARDE) Region II
U.S. Fish and Wildlife Service
P.O. Box 1306
Albuquerque, New Mexico 87103**