

LOYAL SE 1989

NATIONAL WETLANDS INVENTORY
UNITED STATES DEPARTMENT OF THE INTERIOR

LOYAL SE, OKLA.

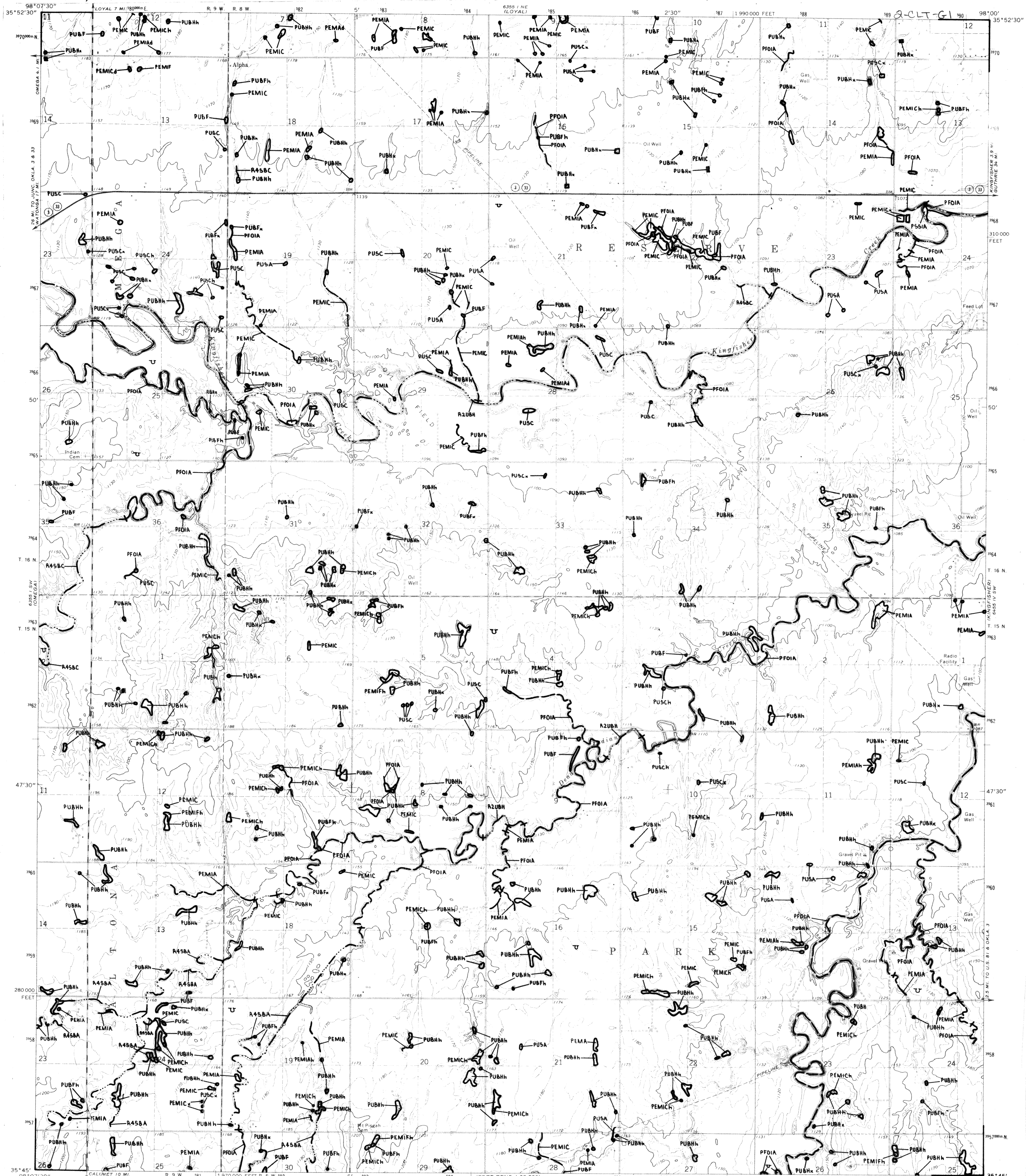

CLINTON NE
WATONGA

LOYAL SE, OKLA.

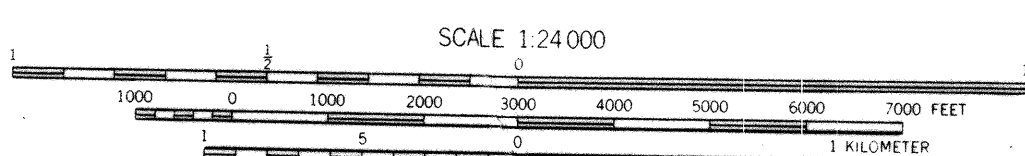

☐ 1 acre ☐ 10 acres

ACREAGE GUIDE

Other information including a narrative report concerning the wetland resources depicted on this document may be available. For information, contact:

**Regional Director (ARDE) Region II
U.S. Fish and Wildlife Service
P.O. Box 1306
Albuquerque, New Mexico 87103**

SPECIAL NOTE

This document was prepared primarily by stereoscopic analysis of high altitude aerial photographs. Wetlands were identified on the photographs based on vegetation, visible hydrology, and geography in accordance with *Classification of Wetlands and Deepwater Habitats of the United States* (FWS/OBS - 79/31 December 1979). The aerial photographs typically reflect conditions during the specific time when they were taken. In addition, there is a margin of error inherent in the use of the aerial photographs. Thus, a detailed on the ground and historical analysis of a single site may result in a revision of the wetland boundaries established through photographic interpretation. In addition, some small wetlands and those obscured by dense forest cover may not be included on this document.

in this document:

• **State and local regulatory agencies with jurisdiction over wetlands** may define and describe wetlands in a different manner than that used in this inventory. There is no attempt, in either the design or products of this inventory, to define the limits of proprietary jurisdiction of any Federal, State or local government or to establish the geographical scope of the regulatory programs of government agencies. **Persons intending to engage in activities involving modifications within or adjacent to wetland areas** should consult the advice of appropriate Federal, State or local agencies concerning specified agency regulatory programs and proprietary jurisdictions that may affect such activities.

SYMBOLGY EXAMPLE

Diagram illustrating the hierarchical classification of a wetland area. The area is divided into regions labeled with codes: L2EM2F (Upland (Non-Wetland)), R2OWH (Linear Deepwater Habitat), and a central area labeled 'U'. The hierarchy is defined by lines connecting the codes to their respective levels: SYSTEM, SUBSYSTEM, CLASS, SUBCLASS, WATER REGIME, and UPLAND (NON-WETLAND).

NOTES TO THE USER

- Wetlands which have been field examined are indicated on the map by an asterisk (*).
Additions or corrections to the wetlands information (especially the name) may be requested. Please forward such information to the address indicated.
 - Subsystems, Classes, Subclasses, and Water Regimes in *Italics* were developed specifically for NATIONAL WETLANDS INVENTORY mapping.
Some are designated as RASBW, OR RASBJ (INTERMITTENT STREAMS) may not meet the definition of wetland.
- This map uses the class Unconsolidated Shore (US).
On the NWI map, the class that was designated Beach/Bar (BB), or Flat (FL). Subclasses remain the same in both versions.

AERIAL PHOTOGRAPHY

DATE: 11 / 81 DATE: / /
SCALE: 158 000 SCALE: / /
TYPE: CIR TYPE: / /

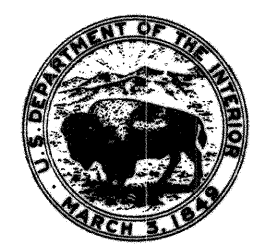

U.S. DEPARTMENT OF THE INTERIOR
FISH AND WILDLIFE SERVICE
Prepared by National Wetlands Inventory
1989