

NATIONAL WETLANDS INVENTORY
UNITED STATES DEPARTMENT OF THE INTERIOR

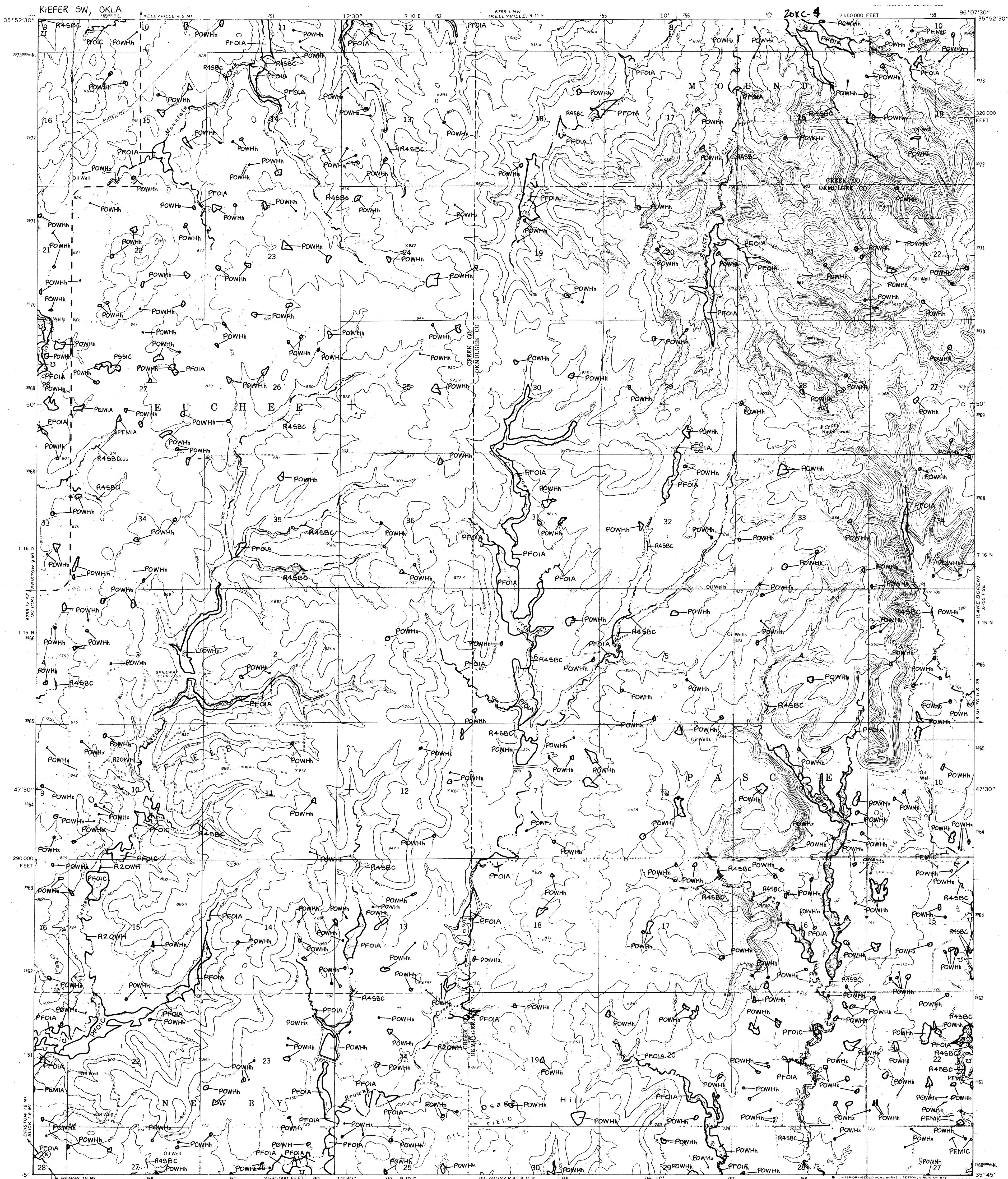

OKLAHOMA CITY NE
BRISTOW

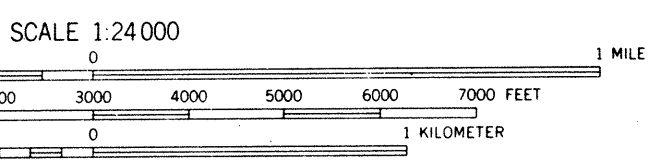

Other information concerning the wetland resources depicted on this document may be available. For information, contact:

Regional Director (ARDE) Region II
U.S. Fish and Wildlife Service
P.O. Box 1308
Albuquerque, New Mexico 87103

SPECIAL NOTE

This document was prepared primarily by stereoscopic analysis of high altitude aerial photographs. Wetlands were identified on the photographs based on vegetation, visible hydrology, and geography in accordance with *Classification of Wetlands and Deep-Water Habitats of the United States* (An Operational Draft), Cowardin, et al., 1977. The aerial photographs typically reflect conditions during the specific year and season when they were taken. In addition, there is a margin of error inherent in the use of the aerial photographs. Thus, a detailed on the ground and historical analysis of a single site may result in a revision of the wetland boundaries established through photographic interpretation. In addition, some small wetlands and those obscured by dense forest cover may not be included on this document.

Federal, State and local regulatory agencies with jurisdiction over wetlands may define and describe wetlands in a different manner than that used in this inventory. There is no attempt, in either the design or products of this inventory, to define the limits of proprietary jurisdiction of any Federal, State or local government or to establish the geographical scope of the regulatory programs of government agencies. Persons intending to engage in activities involving modifications within or adjacent to wetland areas should seek the advice of appropriate Federal, State or local agencies concerning specified agency regulatory programs and proprietary jurisdictions that may affect such activities.

SYMBOLS EXAMPLE

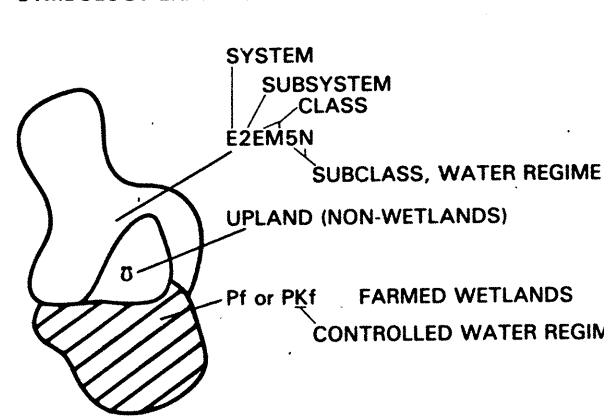

- NOTES TO THE USER
- Wetlands which have been field examined are indicated on the map by an asterisk (*).
 - Dominance type (either vegetative or sedimentary animal) can be added to the map by the interested user.
 - Additions or corrections to the wetlands information displayed on this map are solicited. Please forward such information to the address indicated.
 - Some areas designated R45B, R45W, or R45J (intermittent streams) may not meet the definition of wetlands.

AERIAL PHOTOGRAPHY

DATE: 3/80
SCALE: 1:58000
TYPE: CIR
DATE: / /
SCALE: / /
TYPE: / /

U.S. DEPARTMENT OF THE INTERIOR
FISH AND WILDLIFE SERVICE

Prepared by Office of Biological Services
for the National Wetlands Inventory

WETLAND LEGEND

U - Primarily represents upland areas, but may include unclassified wetlands such as man-modified areas, non-photo-identifiable areas and/or unintentional omissions.

ECOLOGICAL SYSTEM

E - ESTUARINE		M - MARINE	
1 - Subtidal	2 - Intertidal	1 - Subtidal	2 - Intertidal
CLASS	CLASS	CLASS	CLASS
Subclass	Subclass	Subclass	Subclass
1 - ROCK	1 - ROCK	1 - ROCK	1 - ROCK
2 - SAND	2 - SAND	2 - SAND	2 - SAND
3 - MUD	3 - MUD	3 - MUD	3 - MUD
4 - ORGANIC	4 - ORGANIC	4 - ORGANIC	4 - ORGANIC
5 - VEGETATED	5 - VEGETATED	5 - VEGETATED	5 - VEGETATED
6 - NON-VEGETATED	6 - NON-VEGETATED	6 - NON-VEGETATED	6 - NON-VEGETATED
7 - UNKNOWN SURFACE	7 - UNKNOWN SURFACE	7 - UNKNOWN SURFACE	7 - UNKNOWN SURFACE
8 - UNKNOWN SUBSTRATE	8 - UNKNOWN SUBSTRATE	8 - UNKNOWN SUBSTRATE	8 - UNKNOWN SUBSTRATE
9 - UNKNOWN DEPTH	9 - UNKNOWN DEPTH	9 - UNKNOWN DEPTH	9 - UNKNOWN DEPTH
10 - UNKNOWN TEMPERATURE	10 - UNKNOWN TEMPERATURE	10 - UNKNOWN TEMPERATURE	10 - UNKNOWN TEMPERATURE
11 - UNKNOWN SALINITY	11 - UNKNOWN SALINITY	11 - UNKNOWN SALINITY	11 - UNKNOWN SALINITY
12 - UNKNOWN pH	12 - UNKNOWN pH	12 - UNKNOWN pH	12 - UNKNOWN pH
13 - UNKNOWN SOIL	13 - UNKNOWN SOIL	13 - UNKNOWN SOIL	13 - UNKNOWN SOIL
14 - UNKNOWN SPECIAL MODIFIERS	14 - UNKNOWN SPECIAL MODIFIERS	14 - UNKNOWN SPECIAL MODIFIERS	14 - UNKNOWN SPECIAL MODIFIERS

ECOLOGICAL SYSTEM

P - PALUSTRINE		L - LACUSTRINE	
1 - Subtidal	2 - Intertidal	1 - Subtidal	2 - Intertidal
CLASS	CLASS	CLASS	CLASS
Subclass	Subclass	Subclass	Subclass
1 - ROCK	1 - ROCK	1 - ROCK	1 - ROCK
2 - SAND	2 - SAND	2 - SAND	2 - SAND
3 - MUD	3 - MUD	3 - MUD	3 - MUD
4 - ORGANIC	4 - ORGANIC	4 - ORGANIC	4 - ORGANIC
5 - VEGETATED	5 - VEGETATED	5 - VEGETATED	5 - VEGETATED
6 - NON-VEGETATED	6 - NON-VEGETATED	6 - NON-VEGETATED	6 - NON-VEGETATED
7 - UNKNOWN SURFACE	7 - UNKNOWN SURFACE	7 - UNKNOWN SURFACE	7 - UNKNOWN SURFACE
8 - UNKNOWN SUBSTRATE	8 - UNKNOWN SUBSTRATE	8 - UNKNOWN SUBSTRATE	8 - UNKNOWN SUBSTRATE
9 - UNKNOWN DEPTH	9 - UNKNOWN DEPTH	9 - UNKNOWN DEPTH	9 - UNKNOWN DEPTH
10 - UNKNOWN TEMPERATURE	10 - UNKNOWN TEMPERATURE	10 - UNKNOWN TEMPERATURE	10 - UNKNOWN TEMPERATURE
11 - UNKNOWN SALINITY	11 - UNKNOWN SALINITY	11 - UNKNOWN SALINITY	11 - UNKNOWN SALINITY
12 - UNKNOWN pH	12 - UNKNOWN pH	12 - UNKNOWN pH	12 - UNKNOWN pH
13 - UNKNOWN SOIL	13 - UNKNOWN SOIL	13 - UNKNOWN SOIL	13 - UNKNOWN SOIL
14 - UNKNOWN SPECIAL MODIFIERS	14 - UNKNOWN SPECIAL MODIFIERS	14 - UNKNOWN SPECIAL MODIFIERS	14 - UNKNOWN SPECIAL MODIFIERS

ECOLOGICAL SYSTEM

R - RIVERINE		L - LACUSTRINE	
1 - Subtidal	2 - Intertidal	1 - Subtidal	2 - Intertidal
CLASS	CLASS	CLASS	CLASS
Subclass	Subclass	Subclass	Subclass
1 - ROCK	1 - ROCK	1 - ROCK	1 - ROCK
2 - SAND	2 - SAND	2 - SAND	2 - SAND
3 - MUD	3 - MUD	3 - MUD	3 - MUD
4 - ORGANIC	4 - ORGANIC	4 - ORGANIC	4 - ORGANIC
5 - VEGETATED	5 - VEGETATED	5 - VEGETATED	5 - VEGETATED
6 - NON-VEGETATED	6 - NON-VEGETATED	6 - NON-VEGETATED	6 - NON-VEGETATED
7 - UNKNOWN SURFACE	7 - UNKNOWN SURFACE	7 - UNKNOWN SURFACE	7 - UNKNOWN SURFACE
8 - UNKNOWN SUBSTRATE	8 - UNKNOWN SUBSTRATE	8 - UNKNOWN SUBSTRATE	8 - UNKNOWN SUBSTRATE
9 - UNKNOWN DEPTH	9 - UNKNOWN DEPTH	9 - UNKNOWN DEPTH	9 - UNKNOWN DEPTH
10 - UNKNOWN TEMPERATURE	10 - UNKNOWN TEMPERATURE	10 - UNKNOWN TEMPERATURE	10 - UNKNOWN TEMPERATURE
11 - UNKNOWN SALINITY	11 - UNKNOWN SALINITY	11 - UNKNOWN SALINITY	11 - UNKNOWN SALINITY
12 - UNKNOWN pH	12 - UNKNOWN pH	12 - UNKNOWN pH	12 - UNKNOWN pH
13 - UNKNOWN SOIL	13 - UNKNOWN SOIL	13 - UNKNOWN SOIL	13 - UNKNOWN SOIL
14 - UNKNOWN SPECIAL MODIFIERS	14 - UNKNOWN SPECIAL MODIFIERS	14 - UNKNOWN SPECIAL MODIFIERS	14 - UNKNOWN SPECIAL MODIFIERS

(1) EM - EMERGENTS are only found in the Riverine Tidal and Riverine Lacustrine Ecological Subsystems. All other classes are found in all Riverine Ecological Subsystems.

MODIFYING TERMS

In order to more adequately describe wetland and aquatic habitats one or more of the water regime, water chemistry, soil, or special modifiers may be applied at the class or lower level in the hierarchy. The termed modifier may also be applied to the ecological system.

WATER REGIME(1)		WATER CHEMISTRY		SOIL		SPECIAL MODIFIERS	
Non-Tidal	Tidal	Coastal Salinity	Inland Salinity	pH Modifiers for all Fresh Water	Soil	Special Modifiers	Special Modifiers
A - Temporary	H - Permanent	1 - Hypersaline	1 - Hypersaline	1 - Hypersaline	1 - Hypersaline	1 - Hypersaline	1 - Hypersaline
B - Seasonal	I - Intermittently Flooded	2 - Subhypersaline	2 - Subhypersaline	2 - Subhypersaline	2 - Subhypersaline	2 - Subhypersaline	2 - Subhypersaline
C - Seasonal	J - Intermittently Flooded/Permanent	3 - Subhypersaline	3 - Subhypersaline	3 - Subhypersaline	3 - Subhypersaline	3 - Subhypersaline	3 - Subhypersaline
D - Seasonal	K - Intermittently Flooded/Permanent	4 - Subhypersaline	4 - Subhypersaline	4 - Subhypersaline	4 - Subhypersaline	4 - Subhypersaline	4 - Subhypersaline
E - Seasonal	L - Intermittently Flooded/Permanent	5 - Subhypersaline	5 - Subhypersaline	5 - Subhypersaline	5 - Subhypersaline	5 - Subhypersaline	5 - Subhypersaline
F - Seasonal	M - Intermittently Flooded/Permanent	6 - Subhypersaline	6 - Subhypersaline	6 - Subhypersaline	6 - Subhypersaline	6 - Subhypersaline	6 - Subhypersaline
G - Seasonal	N - Intermittently Flooded/Permanent	7 - Subhypersaline	7 - Subhypersaline	7 - Subhypersaline	7 - Subhypersaline	7 - Subhypersaline	7 - Subhypersaline
H - Seasonal	O - Intermittently Flooded/Permanent	8 - Subhypersaline	8 - Subhypersaline	8 - Subhypersaline	8 - Subhypersaline	8 - Subhypersaline	8 - Subhypersaline
I - Seasonal	P - Intermittently Flooded/Permanent	9 - Subhypersaline	9 - Subhypersaline	9 - Subhypersaline	9 - Subhypersaline	9 - Subhypersaline	9 - Subhypersaline
J - Seasonal	Q - Intermittently Flooded/Permanent	10 - Subhypersaline	10 - Subhypersaline	10 - Subhypersaline	10 - Subhypersaline	10 - Subhypersaline	10 - Subhypersaline
K - Seasonal	R - Intermittently Flooded/Permanent	11 - Subhypersaline	11 - Subhypersaline	11 - Subhypersaline	11 - Subhypersaline	11 - Subhypersaline	11 - Subhypersaline
L - Seasonal	S - Intermittently Flooded/Permanent	12 - Subhypersaline	12 - Subhypersaline	12 - Subhypersaline	12 - Subhypersaline	12 - Subhypersaline	12 - Subhypersaline
M - Seasonal	T - Intermittently Flooded/Permanent	13 - Subhypersaline	13 - Subhypersaline	13 - Subhypersaline	13 - Subhypersaline	13 - Subhypersaline	13 - Subhypersaline
N - Seasonal	U - Intermittently Flooded/Permanent	14 - Subhypersaline	14 - Subhypersaline	14 - Subhypersaline	14 - Subhypersaline	14 - Subhypersaline	14 - Subhypersaline
O - Seasonal	V - Intermittently Flooded/Permanent	15 - Subhypersaline	15 - Subhypersaline	15 - Subhypersaline	15 - Subhypersaline	15 - Subhypersaline	15 - Subhypersaline
P - Seasonal	W - Intermittently Flooded/Permanent	16 - Subhypersaline	16 - Subhypersaline	16 - Subhypersaline	16 - Subhypersaline	16 - Subhypersaline	16 - Subhypersaline
Q - Seasonal	X - Intermittently Flooded/Permanent	17 - Subhypersaline	17 - Subhypersaline	17 - Subhypersaline	17 - Subhypersaline	17 - Subhypersaline	17 - Subhypersaline
R - Seasonal	Y - Intermittently Flooded/Permanent	18 - Subhypersaline	18 - Subhypersaline	18 - Subhypersaline	18 - Subhypersaline	18 - Subhypersaline	18 - Subhypersaline
S - Seasonal	Z - Intermittently Flooded/Permanent	19 - Subhypersaline	19 - Subhypersaline	19 - Subhypersaline	19 - Subhypersaline	19 - Subhypersaline	19 - Subhypersaline
T - Seasonal	AA - Intermittently Flooded/Permanent	20 - Subhypersaline	20 - Subhypersaline	20 - Subhypersaline	20 - Subhypersaline	20 - Subhypersaline	20 - Subhypersaline
U - Seasonal	AB - Intermittently Flooded/Permanent	21 - Subhypersaline	21 - Subhypersaline	21 - Subhypersaline	21 - Subhypersaline	21 - Subhypersaline	21 - Subhypersaline
V - Seasonal	AC - Intermittently Flooded/Permanent	22 - Subhypersaline	22 - Subhypersaline	22 - Subhypersaline	22 - Subhypersaline	22 - Subhypersaline	22 - Subhypersaline
W - Seasonal	AD - Intermittently Flooded/Permanent	23 - Subhypersaline	23 - Subhypersaline	23 - Subhypersaline	23 - Subhypersaline	23 - Subhypersaline	23 - Subhypersaline
X - Seasonal	AE - Intermittently Flooded/Permanent	24 - Subhypersaline	24 - Subhypersaline	24 - Subhypersaline	24 - Subhypersaline	24 - Subhypersaline	24 - Subhypersaline
Y - Seasonal	AF - Intermittently Flooded/Permanent	25 - Subhypersaline	25 - Subhypersaline	25 - Subhypersaline	25 - Subhypersaline	25 - Subhypersaline	25 - Subhypersaline
Z - Seasonal	AG - Intermittently Flooded/Permanent	26 - Subhypersaline	26 - Subhypersaline	26 - Subhypersaline	26 - Subhypersaline	26 - Subhypersaline	26 - Subhypersaline
AA - Seasonal	AH - Intermittently Flooded/Permanent	27 - Subhypersaline	27 - Subhypersaline	27 - Subhypersaline	27 - Subhypersaline	27 - Subhypersaline	27 - Subhypersaline
AB - Seasonal	AI - Intermittently Flooded/Permanent	28 - Subhypersaline	28 - Subhypersaline	28 - Subhypersaline	28 - Subhypersaline	28 - Subhypersaline	28 - Subhypersaline
AC - Seasonal	AJ - Intermittently Flooded/Permanent	29 - Subhypersaline	29 - Subhypersaline	29 - Subhypersaline	29 - Subhypersaline	29 - Subhypersaline	29 - Subhypersaline
AD - Seasonal	AK - Intermittently Flooded/Permanent	30 - Subhypersaline	30 - Subhypersaline	30 - Subhypersaline	30 - Subhypersaline	30 - Subhypersaline	30 - Subhypersaline
AE - Seasonal	AL - Intermittently Flooded/Permanent	31 - Subhypersaline	31 - Subhypersaline	31 - Subhypersaline	31 - Subhypersaline	31 - Subhypersaline	31 - Subhypersaline
AF - Seasonal	AM - Intermittently Flooded/Permanent	32 - Subhypersaline	32 - Subhypersaline	32 - Subhypersaline	32 - Subhypersaline	32 - Subhypersaline	32 - Subhypersaline
AG - Seasonal	AN - Intermittently Flooded/Permanent	33 - Subhypersaline	33 - Subhypersaline	33 - Subhypersaline	33 - Subhypersaline	33 - Subhypersaline	33 - Subhypersaline
AH - Seasonal	AO - Intermittently Flooded/Permanent	34 - Subhypersaline	34 - Subhypersaline	34 - Subhypersaline	34 - Subhypersaline	34 - Subhypersaline	34 - Subhypersaline
AI - Seasonal	AP - Intermittently Flooded/Permanent	35 - Subhypersaline	35 - Subhypersaline	35 - Subhypersaline	35 - Subhypersaline	35 - Subhypersaline	35 - Subhypersaline
AJ - Seasonal	AQ - Intermittently Flooded/Permanent	36 - Subhypersaline	36 - Subhypersaline	36 - Subhypersaline	36 - Subhypersaline	36 - Subhypersaline	36 - Subhypersaline
AK - Seasonal	AR - Intermittently Flooded/Permanent	37 - Subhypersaline	37 - Subhypersaline	37 - Subhypersaline	37 - Subhypersaline	37 - Subhypersaline	37 - Subhypersaline
AL - Seasonal	AS - Intermittently Flooded/Permanent	38 - Subhypersaline	38 - Subhypersaline	38 - Subhypersaline	38 - Subhypersaline	38 - Subhypersaline	38 - Subhypersaline
AM - Seasonal	AT - Intermittently Flooded/Permanent	39 - Subhypersaline	39 - Subhypersaline	39 - Subhypersaline	39 - Subhypersaline	39 - Subhypersaline	39 - Subhypersaline
AN - Seasonal	AU - Intermittently Flooded/Permanent	40 - Subhypersaline	40 - Subhypersaline	40 - Subhypersaline	40 - Subhypersaline	40 - Subhypersaline	40 - Subhypersaline
AO - Seasonal	AV - Intermittently Flooded/Permanent	41 - Subhypersaline	41 - Subhypersaline	41 - Subhypersaline	41 - Subhypersaline	41 - Subhypersaline	41 - Subhypersaline
AP - Seasonal	AW - Intermittently Flooded/Permanent	42 - Subhypersaline	42 - Subhypersaline	42 - Subhypersaline	42 - Subhypersaline	42 - Subhypersaline	42 - Subhypersaline
AQ - Seasonal	AX - Intermittently Flooded/Permanent	43 - Subhypersaline	43 - Subhypersaline	43 - Subhypersaline	43 - Subhypersaline	43 - Subhypersaline	43 - Subhypersaline
AR - Seasonal	AY - Intermittently Flooded/Permanent	44 - Subhypersaline	44 - Subhypersaline	44 - Subhypersaline	44 - Subhypersaline	44 - Subhypersaline	44 - Subhypersaline
AS - Seasonal	AZ - Intermittently Flooded/Permanent	45 - Subhypersaline	45 - Subhypersaline	45 - Subhypersaline	45 - Subhypersaline	45 - Subhypersaline	45 - Subhypersaline
AT - Seasonal	BA - Intermittently Flooded/Permanent	46 - Subhypersaline	46 - Subhypersaline	46 - Subhypersaline	46 - Subhypersaline	46 - Subhypersaline	46 - Subhypersaline
AU - Seasonal	BB - Intermittently Flooded/Permanent	47 - Subhypersaline	47 - Subhypersaline	47 - Subhypersaline	47 - Subhypersaline	47 - Subhypersaline	47 - Subhypersaline
AV - Seasonal	BC - Intermittently Flooded/Permanent	48 - Subhypersaline	48 - Subhypersaline	48 - Subhypersaline	48 - Subhypersaline	48 - Subhypersaline	48 - Subhypersaline
AW - Seasonal	BD - Intermittently Flooded/Permanent	49 - Subhypersaline	49 - Subhypersaline	49 - Subhypersaline	49 - Subhypersaline	49 - Subhypersaline	49 - Subhypersaline
AX - Seasonal	BE - Intermittently Flooded/Permanent	50 - Subhypersaline	50 - Subhypersaline	50 - Subhypersaline	50 - Subhypersaline	50 - Subhypersaline	50 - Subhypersaline
AY - Seasonal	BF - Intermittently Flooded/Permanent	51 - Subhypersaline	51 - Subhypersaline	51 - Subhypersaline	51 - Subhypersaline	51 - Subhypersaline	51 - Subhypersaline
AZ - Seasonal	BG - Intermittently Flooded/Permanent	52 - Subhypersaline	52 - Subhypersaline	52 - Subhypersaline	52 - Subhypersaline	52 - Subhypersaline	52 - Subhypersaline
BA - Seasonal	BH - Intermittently Flooded/Permanent	53 - Subhypersaline	53 - Subhypersaline	53 - Subhypersaline	53 - Subhypersaline	53 - Subhypersaline	53 - Subhypersaline
BB - Seasonal	BI - Intermittently Flooded/Permanent	54 - Subhypersaline	54 - Subhypersaline	54 - Subhypersaline	54 - Subhypersaline	54 - Subhypersaline	54 - Subhypersaline
BC - Seasonal	BJ - Intermittently Flooded/Permanent	55 - Subhypersaline	55 - Subhypersaline	55 - Subhypersaline	55 - Subhypersaline	55 - Subhypersaline	55 - Subhypersaline
BD - Seasonal	BK - Intermittently Flooded/Permanent	56 - Subhypersaline	56 - Subhypersaline	56 - Subhypersaline	56 - Subhypersaline	56 - Subhypersaline	56 - Subhypersaline
BE - Seasonal	BL - Intermittently Flooded/Permanent	57 - Subhypersaline	57 - Subhypersaline	57 - Subhypersaline	57 - Subhypersaline	57 - Subhypersaline	57 - Subhypersaline
BF - Seasonal	BM - Intermittently Flooded/Permanent	58 - Subhypersaline	58 - Subhypersaline	58 - Subhypersaline	58 - Subhypersaline	58 - Subhypersaline	58 - Subhypersaline
BG - Seasonal	BN - Intermittently Flooded/Permanent	59 - Subhypersaline	59 - Subhypersaline	59 - Subhypersaline	59 - Subhypersaline	59 - Subhypersaline	59 - Subhypersaline
BH - Seasonal	BO - Intermittently Flooded/Permanent	60 - Subhypersaline	60 - Subhypersaline	60 - Subhypersaline	60 - Subhypersaline	60 - Subhypersaline	60 - Subhypersaline
BI - Seasonal	BP - Intermittently Flooded/Permanent	61 - Subhypersaline	61 - Subhypersaline	61 - Subhypersaline	61 - Subhypersaline	61 - Subhypersaline	61 - Subhypersaline
BJ - Seasonal	BQ - Intermittently Flooded/Permanent	62 - Subhypersaline	62 - Subhypersaline	62 - Subhypersaline	62 - Subhypersaline	62 - Subhypersaline	62 - Subhypersaline
BK - Seasonal	BR - Intermittently Flooded/Permanent	63 - Subhypersaline	63 - Subhypersaline	63 - Subhypersaline	63 - Subhypersaline	63 - Subhypersaline	63 - Subhypersaline
BL - Seasonal	BS - Intermittently Flooded/Permanent	64 - Subhypersaline	64 - Subhypersaline	64 - Subhypersaline	64 - Subhypersaline	64 - Subhypersaline	64 - Subhypersaline
BM - Seasonal	BT - Intermittently Flooded/Permanent	65 - Subhypersaline	65 - Subhypersaline	65 - Subhypersaline	65 - Subhypersaline	65 - Subhypersaline	65 - Subhypersaline
BN - Seasonal	BU - Intermittently Flooded/Permanent	66 - Subhypersaline	66 - Subhypersaline	66 - Subhypersaline	66 - Subhypersaline	66 - Subhypersaline	66 - Subhypersaline
BO - Seasonal	BV - Intermittently Flooded/Permanent	67 - Subhypersaline	67 - Subhypersaline	67 - Subhypersaline	67 - Subhypersaline	67 - Subhypersaline	67 - Subhypersaline
BP - Seasonal	BW - Intermittently Flooded/Permanent	68 - Subhypersaline	68 - Subhypersaline	68 - Subhypersaline	68 - Subhypersaline	68 - Subhypersaline	68 - Subhypersaline
BQ - Seasonal	BX - Intermittently Flooded/Permanent	69 - Subhypersaline	69 - Subhypersaline	69 - Subhypersaline	69 - Subhypersaline	69 - Subhypersaline	69 - Subhypersaline
BR - Seasonal	BY - Intermittently Flooded/Permanent	70 - Subhypersaline	70 - Subhypersaline	70 - Subhypersaline	70 - Subhypersaline	70 - Subhypersaline	70 - Subhypersaline
BS - Seasonal	BZ - Intermittently Flooded/Permanent	71 - Subhypersaline	71 - Subhypersaline	71 - Subhypersaline	71 - Subhypersaline	71 - Subhypersaline	71 - Subhypersaline
BT - Seasonal	CA - Intermittently Flooded/Permanent	72 - Subhypersaline	72 - Subhypersaline	72 - Subhypersaline	72 - Subhypersaline	72 - Subhypersaline	72 - Subhypersaline
BU - Seasonal	CB - Intermittently Flooded/Permanent	73 - Subhypersaline	73 - Subhypersaline	73 - Subhypersaline	73 - Subhypersaline	73 - Subhypersaline	73 - Subhypersaline
BV - Seasonal	CC - Intermittently Flooded/Permanent	74 - Subhypersaline	74 - Subhypersaline	74 - Subhypersaline	74 - Subhypersaline	74 - Subhypersaline	74 - Subhypersaline
BW - Seasonal	CD - Intermittently Flooded/Permanent	75 - Subhypersaline	75 - Subhypersaline	75 - Subhypersaline	75 - Subhypersaline	75 - Subhypersaline	75 - Subhypersaline
BX - Seasonal	CE - Intermittently Flooded/Permanent	76 - Subhypersaline	76 - Subhypersaline	76 - Subhypersaline	76 - Subhypersaline	76 - Subhypersaline	76 - Subhypersaline
BY - Seasonal	CF - Intermittently Flooded/Permanent	77 - Subhypersaline	77 - Subhypersaline	77 - Subhypersaline	77 - Subhypersaline	77 - Subhypersaline	77 - Subhypersaline
BZ - Seasonal	CG - Intermittently Flooded/Permanent	78 - Subhypersaline	78 - Subhypersaline	78 - Subhypersaline	78 - Subhypersaline	78 - Subhypersaline	78 - Subhypersaline
CA - Seasonal	CH - Intermittently Flooded/Permanent	79 - Subhypersaline	79 - Subhypersaline	79 - Subhypersaline	79 - Subhypersaline	79 - Subhypersaline	79 - Subhypersaline
CB - Seasonal	CI - Intermittently Flooded/Permanent	80 - Subhypersaline	80 - Subhypersaline	80 - Subhypersaline	80 - Subhypersaline	80 - Subhypersaline	80 - Subhypersaline
CC - Seasonal	CJ - Intermittently Flooded/Permanent	81 - Subhypersaline	81 - Subhypersaline	81 - Subhypersaline	81 - Subhypersaline	81 - Subhypersaline	81 - Subhypersaline
CD - Seasonal	CK - Intermittently Flooded/Permanent						