

GYPSY 1980

NATIONAL WETLANDS INVENTORY
UNITED STATES DEPARTMENT OF THE INTERIOR

GYPSY, OKLA.

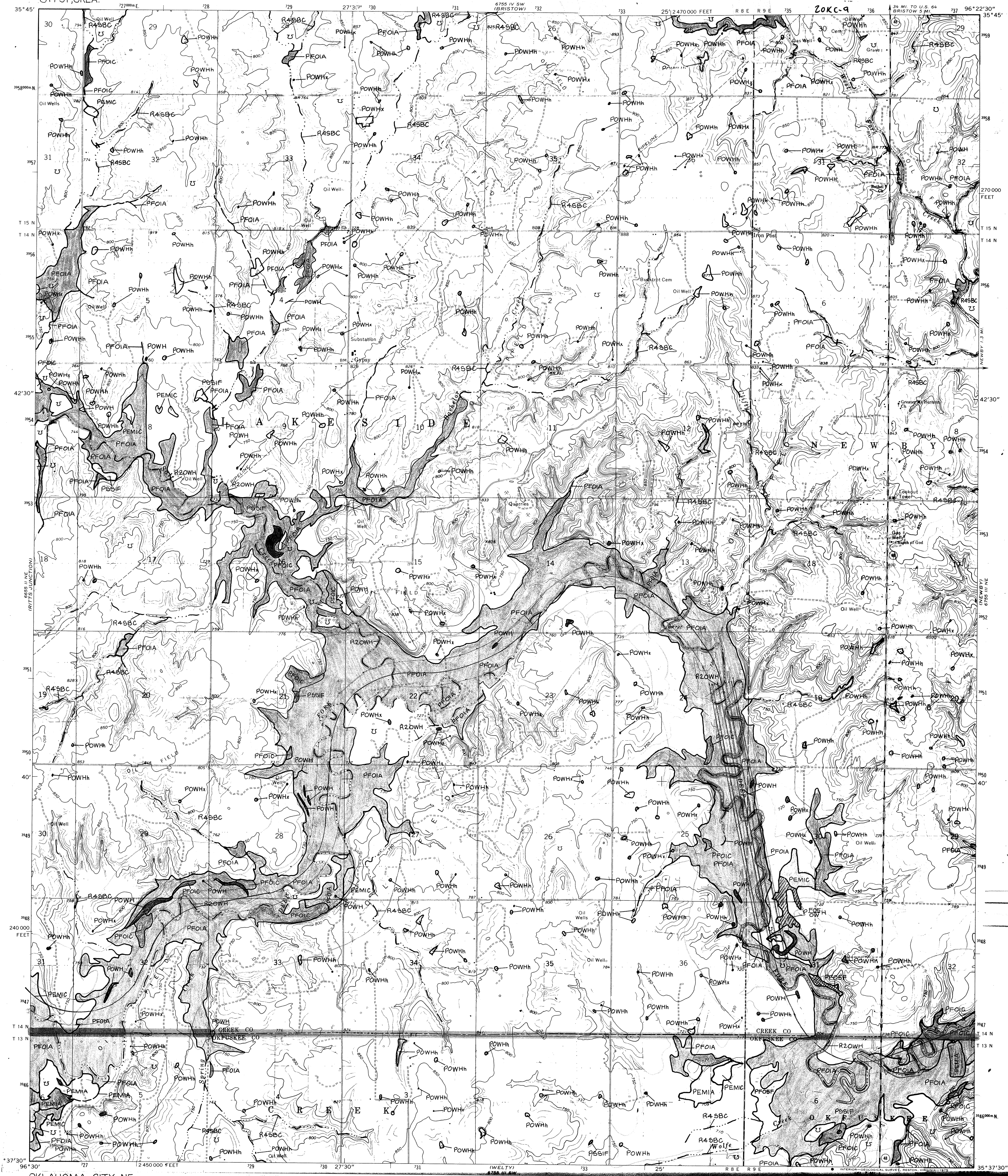

OKLAHOMA CITY NE
BRISTOW

SCALE 1:24 000

Other information concerning the wetland resources depicted on this document may be available. For information, contact:

**Regional Director (ARDE) Region II
U.S. Fish and Wildlife Service
P.O. Box 1306
Albuquerque, New Mexico 87103**

SPECIAL NOTE

This document was prepared primarily by stereoscopic analysis of high altitude aerial photographs. Wetlands were identified on the photographs based on vegetation, visible hydrology, and geography in relation to the wetlands. The hydrology of the wetlands is described in the *Wetlands of the United States* (An Operational Draft), Cowardin, et al, 1977. The aerial photographs typically reflect conditions during the specific year and season when they were taken. In addition, the aerial photographs may not be representative of the aerial photographs. Thus, a detailed analysis of the ground and historical analysis of a single site may result in a revision of the wetland boundaries established through photographic analysis. In addition, some small islands and those obscured by dense forest cover may not be included on this document.

Federal, State and local regulatory agencies with jurisdiction over wetlands may define and describe wetlands in different manner than that used in this inventory. There is no attempt, in either the design or products of this inventory, to define the limits of proprietary jurisdiction of any Federal, State or local government or to establish the geographical scope of the regulatory programs of government agencies. Persons intending to engage in activities involving modifications within or adjacent to wetland areas should seek the advice of appropriate Federal, State or local regulatory agencies.

SYMBOLGY EXAMPLE

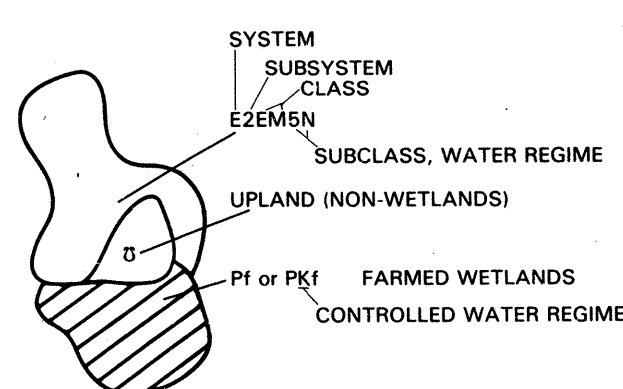

NOTES TO THE USER

- Wetlands which have been designated as R4SB, R4SBW, or R4SBJ on the map by an asterisk (*)
- Dominance type (either vegetative or sedentary animal) can be added to the map by the interested user.
- Additions or corrections to the wetlands information displayed on this map are solicited. Please forward such information to the address indicated.
- Some areas designated R4SB, R4SBW, or R4SBJ (intermittent streams) may not meet the definition of wetlands.

AERIAL PHOTOGRAPHY

DATE: 3 / 1 / 80

SCALE: 1:58 000

TYPE: CIR

FILE: _____

DATE: _____

SCALE: _____

SCALE: _____

TYPE: _____

FILE: _____

U.S. FISH & WILDLIFE SERVICE
222 S. Houston
Tulsa, OK 74127

GYPSY ,OKLA.



U.S. DEPARTMENT OF THE INTERIOR

FISH AND WILDLIFE SERVICE

Prepared by Office of Biological Services
for the National Wetlands Inventory