

NATIONAL WETLANDS INVENTORY
UNITED STATES DEPARTMENT OF THE INTERIOR

CONRAD, OKLA - TEX

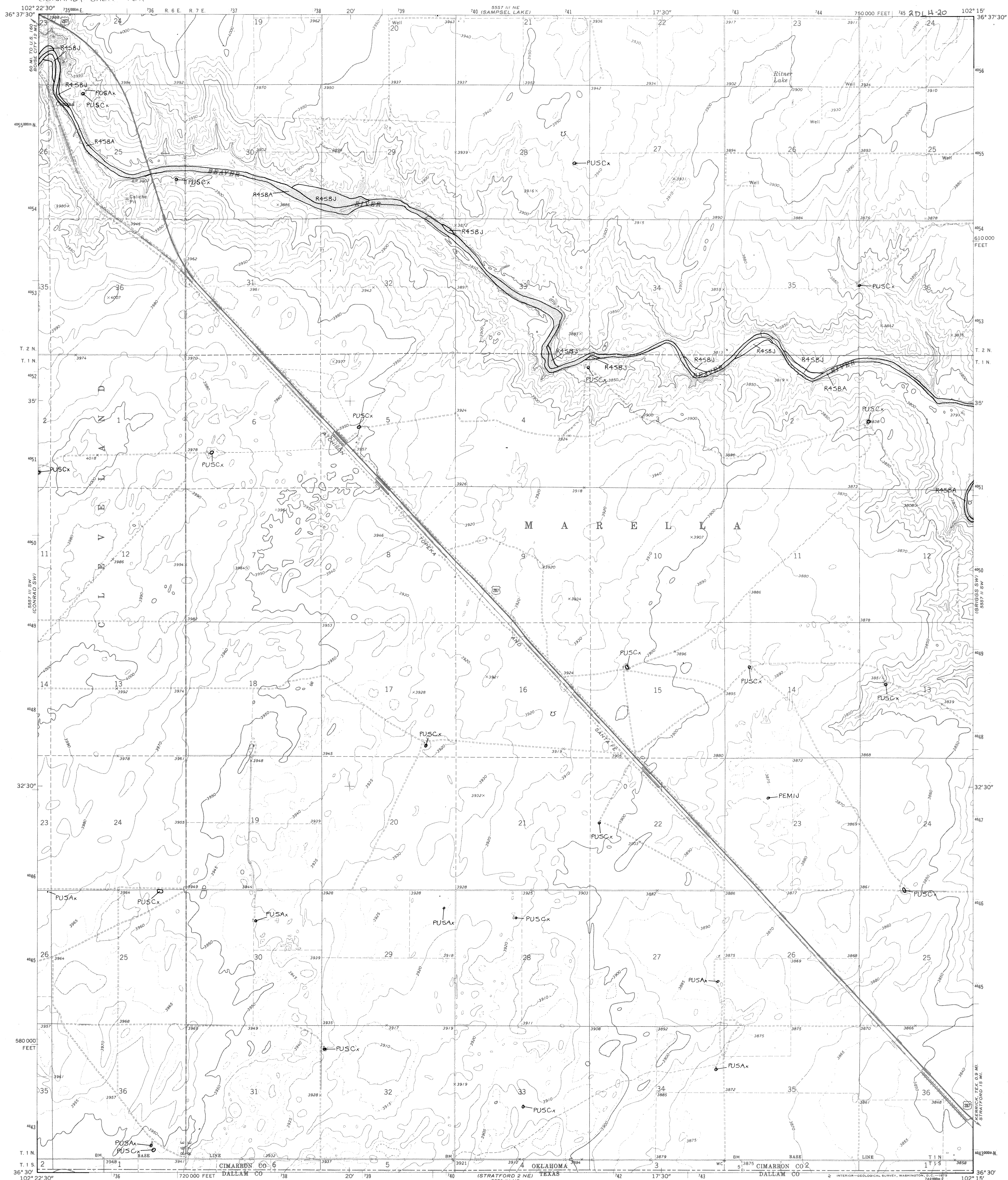

DALHART NE
BOISE CITY

CONRAD, OKLA.-TEX.

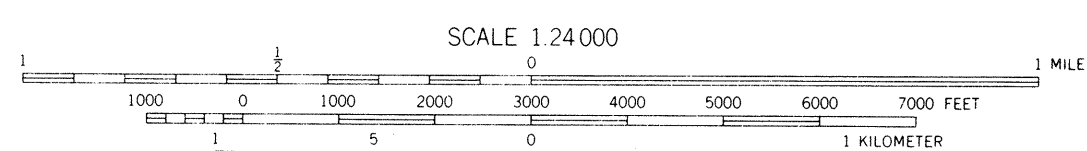
☐ 1 acre

 10 acres

ACREAGE GUIDE

20 acres

Other information including a narrative report concerning the wetland resources depicted on this document may be available. For information, contact:

**Regional Director (ARDE) Region II
U.S. Fish and Wildlife Service
P.O. Box 1306
Albuquerque, New Mexico 87103**

SPECIAL NOTE

This document was prepared primarily by stereoscopic analysis of high altitude aerial photographs. Wetlands were identified by using the aerial photographs, and by using hydrology, and geography in accordance with **Classification of Wetlands and Deepwater Habitats of the United States (FWS/OBS-79/31 December 1979)**. The aerial photographs were taken during the summer of 1979, one year and season when they were taken. In addition, there is a margin of error inherent in the use of the aerial photographs. Aerial photographs are a two dimensional analysis of a single site may result in a revision of the wetland boundaries established through photographic interpretation. In addition, some small wetlands and those in dense forest cover may not be included on this document.

Federal, State and local regulatory agencies with jurisdiction over the wetlands are listed in the following table in a different manner than that used in this inventory. There is no attempt, in either the design or products of this inventory, to define the limits of proprietary jurisdiction or to establish the limits of jurisdiction of the Federal, State, or the geographical scope of the regulatory programs of government agencies. **Persons intending to engage in activities in wetlands should consult with the appropriate Federal, State or local agencies concerning specified agency regulatory programs and proprietary jurisdictions that may affect their activities.**

SYMBOLGY EXAMPLE

SYSTEM
SUBSYSTEM
CLASS
L2EM2F
SUBCLASS. WATER REGIME
UPLAND (NON-WETLAND)

R20WH
(LINEAR DEEPWATER HABITAT)

U — Primarily represents **upland** areas, but may include unclassified wetlands such as man-modified areas, non photo-identifiable areas and/or unintentional omissions.

NOTES TO THE USER

- **NOTES TO THE USER**
 - Wetlands which have been field examined are indicated on the map by an asterisk (*).
 - Additions or corrections to the wetlands information displayed on this map are solicited. Please forward such information to the address indicated.
 - Subsystems, Classes, Subclasses, and Water Regimes in *italics* were developed specifically for NATIONAL WETLANDS INVENTORY mapping.
 - Some areas designated as R4SB, R4SBW, OR R4SBJ (INTERMITTENT STREAMS) may not meet the definition of a wetland.
 - This map uses the class Unconsolidated Shore (US).
- On earlier NWI maps that class was designated Beach/Bar (BB), or Flat (FL). Subclasses remain the same in both versions.

AERIAL PHOTOGRAPHY

DATE: 10, 84 DATE: / /
SCALE: 1:58000 SCALE:
TYPE: CIR TYPE:

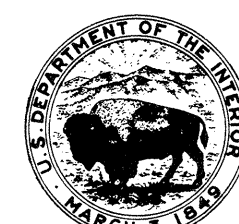

U.S. DEPARTMENT OF THE INTERIOR
FISH AND WILDLIFE SERVICE
Prepared by National Wetlands Inventory

1989