

BLOCKER, OKLA.

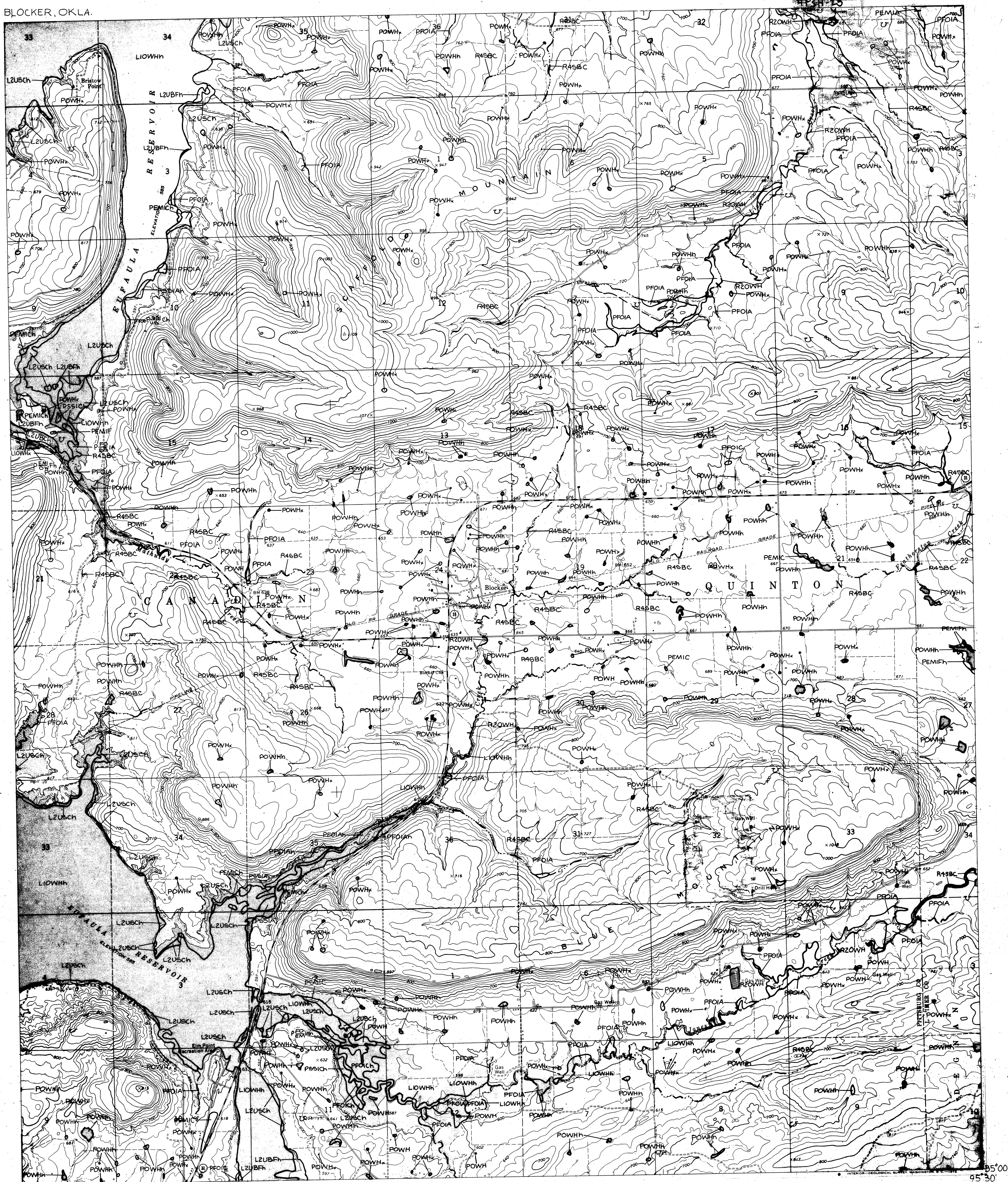

BLOCKER, OKLA.

1 MILE

1 KILOMETER

Graphic scale bars for 1 mile and 1 kilometer. The 1-mile scale is marked in feet (0 to 7000) and the 1-kilometer scale is marked in meters (0 to 1000).

This document was prepared primarily by stereoscopic analysis of high altitude aerial photographs. Wetlands were identified on the photographs based on vegetation, visible hydrology, and geography in the area. Water Habitats of the United States (An Operational Draft), Cowardin, et al, 1977. The aerial photographs typically reflect conditions during the specific year and season when they were taken. In addition, the aerial photographs may not be representative in the use of the aerial photographs. Thus, a detailed on the ground and historical analysis of a single site may result in a revision of the wetland boundaries established through the use of the aerial photographs. In addition, some small wetlands and those obscured by dense forest cover may not be included on this document.

SYSTEM

SUBSYSTEM

CLASS

EZEEM5N

SUBCLASS, WATER REGIME

UPLAND (NON-WETLANDS)

P1 or PK1

FARMED WETLANDS

CONTROLLED WATER REGIME

NOTES TO THE USER

- Wetlands which have been field examined are indicated on the map by an asterisk (*).
- Dominance type (either vegetative or sedentary animal) can be added to the map by the interested user.
- Additions or corrections to the wetlands information displayed on this map are solicited. Please forward such information to the address indicated.
- Some areas designated R4B, R4C, R4D, or R4E (intermittent streams) may not meet the definition of wetlands.

AERIAL PHOTOGRAPH

DATE: 4 / / 80

SCALE: 1:58 000

TYPE: CIR

DATE: / /

SCALE:

Regional Director (ARDE) Region II
U.S. Fish and Wildlife Service
P.O. Box 1306
Albuquerque, New Mexico 87103

U.S. DEPARTMENT OF THE INTERIOR
FISH AND WILDLIFE SERVICE
Prepared by Office of Biological Services
for the National Wetlands Inventory